





**GENERAL NOTES**

This drawing must NOT be scaled  
 All dimensions and levels to be checked on site prior to commencement of work on site. Any discrepancies to be reported to the Supervising Officer. This drawing is to be read in conjunction with relevant consultants and specialists drawings

© Crown copyright and database rights [ 2011 ]  
 Ordnance Survey [ 100023372 ]

**NOTES**

= Building footprint area 1574m<sup>2</sup>  
 = Block reference number  
 = Extents of site boundary 3112m<sup>2</sup>  
 = Asbestos sample record available

**Kingston House**  
**BON008**

Site Area:	3111.53
Gross External Area:	11780.00
Gross Internal Area:	10951.00
Total Room Area:	10574.25
Net Internal Area:	10574.25

**NPS Humber Limited**, Earle House  
 Colonial Street, Hull, HU2 8JY  
 email: [assetregisterhumber@nps.co.uk](mailto:assetregisterhumber@nps.co.uk)

in partnership with

Drawing Number  
**BON008 - OS PLAN**

UPRN / Property Name  
**BON008 / KINGSTON HOUSE**



**ORDNANCE SURVEY PLAN**

Scale		Date	
1:1250 @ A3		25/02/2015	
Ver.	Rev.	Drawn by	Amended by
2.1	L	S - M	K.E.R.

St Charles' Church  
Presby

12  
13

LD

Lift - Entrance (North)  
GEA: 5.5m<sup>2</sup>  
GIA: 3.4m<sup>2</sup>

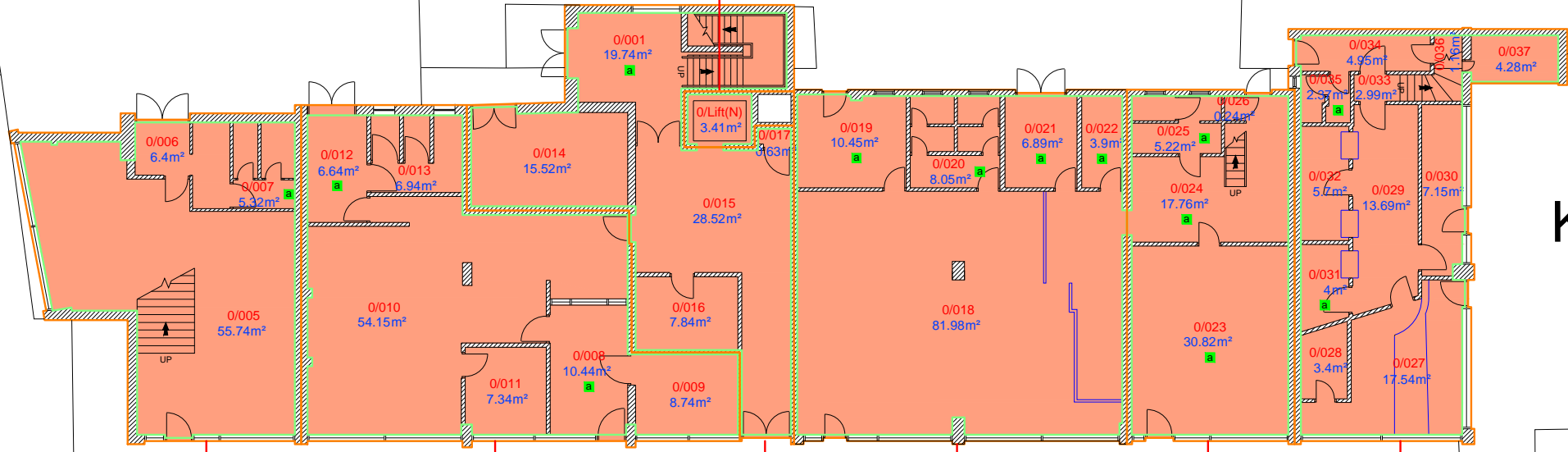

13

Block 13  
GEA: 78.3m<sup>2</sup>  
GIA: 68.9m<sup>2</sup>

12

Block 12  
GEA: 107.5m<sup>2</sup>  
GIA: 98.3m<sup>2</sup>

2

Block 11  
GEA: 121.5m<sup>2</sup>  
GIA: 114.5m<sup>2</sup>

10

Block 10  
GEA: 61.2m<sup>2</sup>  
GIA: 55.4m<sup>2</sup>

9

Block 9  
GEA: 81.4m<sup>2</sup>  
GIA: 71.7m<sup>2</sup>

Kingston  
56 to

BOND S

**GENERAL NOTES**  
This drawing must NOT be scaled  
All dimensions and levels to be checked on site prior to commencement of work on site. Any discrepancies to be reported to the Supervising Officer. This drawing is to be read in conjunction with relevant consultants and specialists drawings  
© Crown copyright and database rights [ 2011 ]  
Ordnance Survey [ 100023372 ]

**NOTES**  
[Orange Box] = Demise of block area  
① = Block reference number  
[Green Box with 'a'] = Asbestos sample record available



**NPS Humber Limited**, Earle House  
Colonial Street, Hull, HU2 8JY  
email: [assetregisterhumber@nps.co.uk](mailto:assetregisterhumber@nps.co.uk)

in partnership with Hull City Council

Drawing Number  
BON008/1 (1 of 23)

UPRN / Property Name  
BON008 / KINGSTON HOUSE

Scale  
1:200 @ A3  
Date  
25/02/2015

Ver.	Rev.	Drawn by	Amended by
2.1	L	S - M	K.E.R.

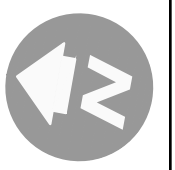

BLOCKS 2 (part), 9 - 13, GROUND FLOOR PLAN

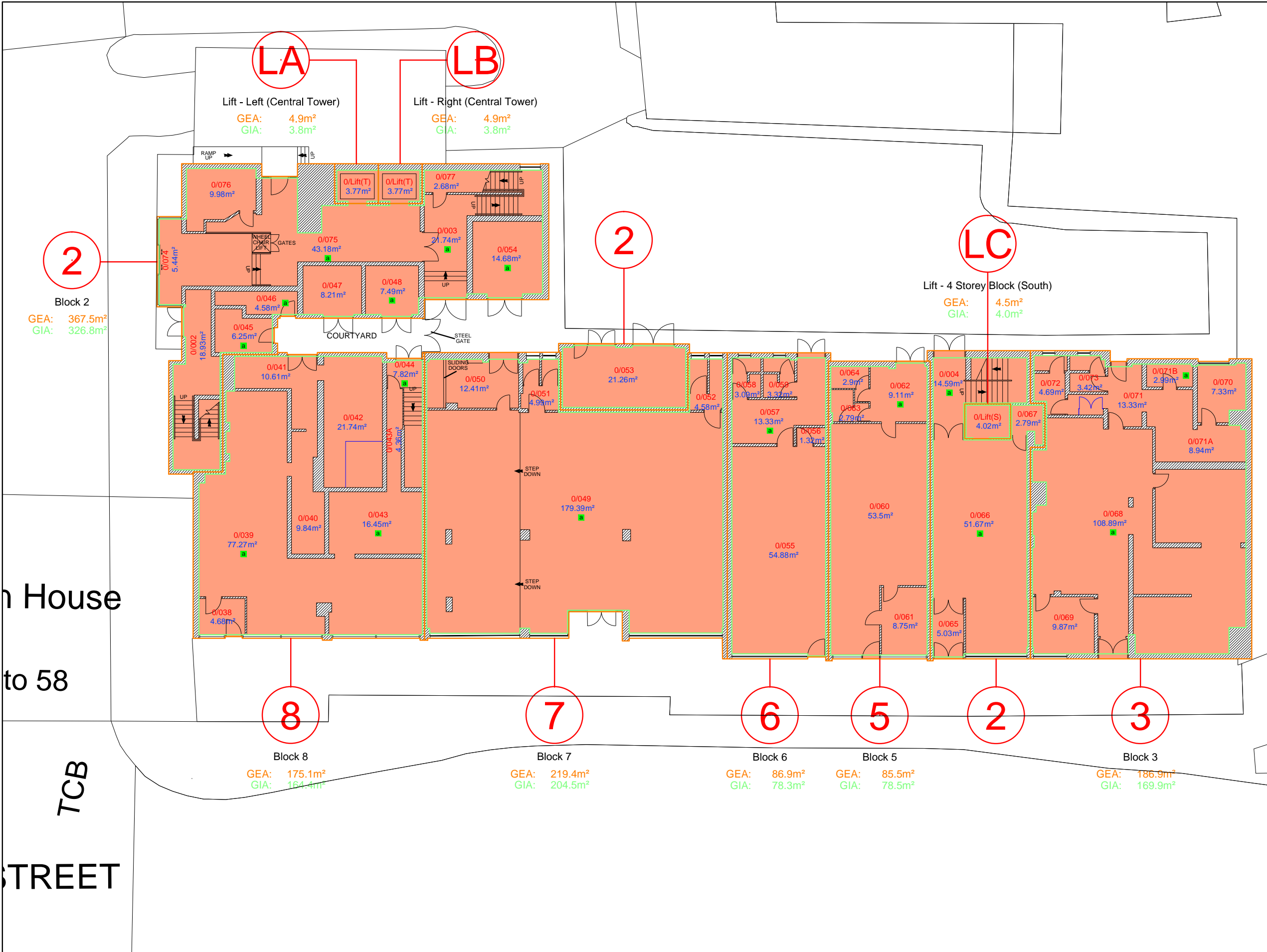

**GENERAL NOTES**

This drawing must NOT be scaled  
 All dimensions and levels to be checked on site prior to commencement of work on site. Any discrepancies to be reported to the Supervising Officer. This drawing is to be read in conjunction with relevant consultants and specialists drawings

© Crown copyright and database rights [ 2011 ]  
 Ordnance Survey [ 100023372 ]

**NOTES**

= Demise of block area  
1 = Block reference number  
a = Asbestos sample record available

House  
 to 58  
 TCB  
 STREET

**nps group**

**NPS Humber Limited**, Earle House  
 Colonial Street, Hull, HU2 8JY  
 email: [assetregisterhumber@nps.co.uk](mailto:assetregisterhumber@nps.co.uk)

in partnership with **Hull City Council**

Drawing Number  
 BON008/2 (2 of 23)

UPRN / Property Name  
 BON008 / KINGSTON HOUSE

Scale  
 1:200 @ A3

Date  
 25/02/2015

Ver.	Rev.	Drawn by	Amended by
2.1	L	S - M	K.E.R.

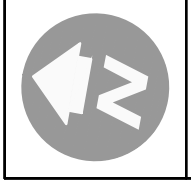



BLOCKS 2 (part), 3, 5 - 8, GROUND FLOOR PLAN

**GENERAL NOTES**

This drawing must NOT be scaled  
 All dimensions and levels to be checked on site prior to commencement of work on site. Any discrepancies to be reported to the Supervising Officer. This drawing is to be read in conjunction with relevant consultants and specialists drawings

© Crown copyright and database rights [ 2011]  
 Ordnance Survey [ 100023372]

**NOTES**

-  = Demise of block area
-  = Block reference number
-  = Asbestos sample record available

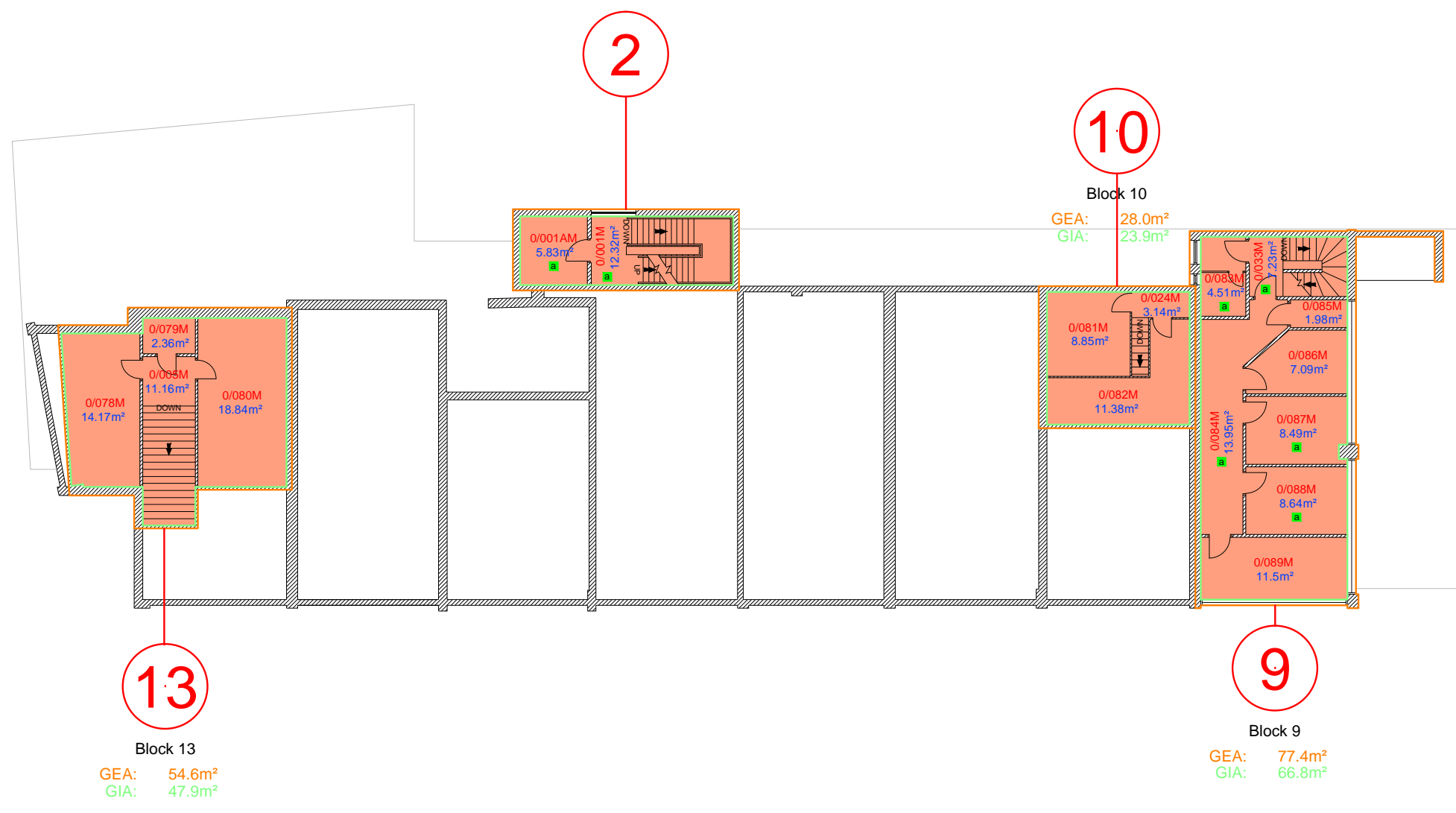

**NPS Humber Limited**, Earle House  
 Colonial Street, Hull, HU2 8JY  
 email: [assetregisterhumber@nps.co.uk](mailto:assetregisterhumber@nps.co.uk)

in partnership with  **Hull**  
 City Council

Drawing Number  
 BON008/3 (3 of 23)

UPRN / Property Name  
 BON008 / KINGSTON HOUSE

Scale: 1:200 @ A3  
 Date: 25/02/2015

Ver.	Rev.	Drawn by	Amended by
2.1	L	S - M	K.E.R.

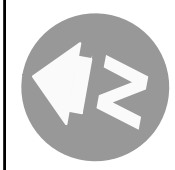

**BLOCKS 2 (part), 9, 10, 13, GROUND FLOOR MEZZANINE PLAN**

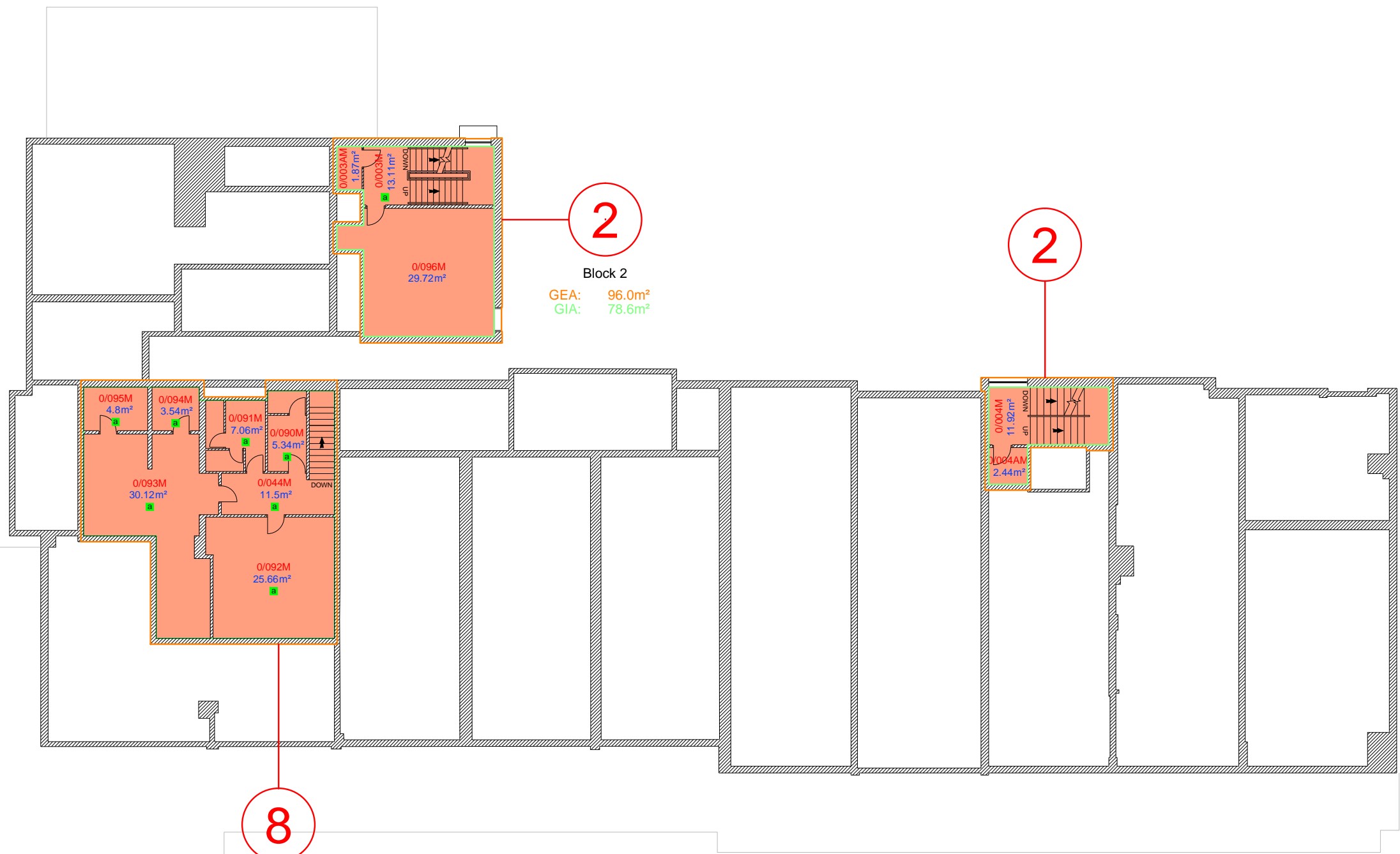

2

Block 2  
 GEA: 96.0m<sup>2</sup>  
 GIA: 78.6m<sup>2</sup>

2

8

Block 8  
 GEA: 102.0m<sup>2</sup>  
 GIA: 93.2m<sup>2</sup>

**GENERAL NOTES**  
 This drawing must NOT be scaled  
 All dimensions and levels to be checked on site prior to commencement of work on site. Any discrepancies to be reported to the Supervising Officer. This drawing is to be read in conjunction with relevant consultants and specialists drawings  
 © Crown copyright and database rights [ 2011 ]  
 Ordnance Survey [ 100023372 ]

**NOTES**

- = Demise of block area
- 1 = Block reference number
- a = Asbestos sample record available



**NPS Humber Limited**, Earle House  
 Colonial Street, Hull, HU2 8JY  
 email: [assetregisterhumber@nps.co.uk](mailto:assetregisterhumber@nps.co.uk)



Drawing Number  
 BON008/4 (4 of 23)

UPRN / Property Name  
 BON008 / KINGSTON HOUSE

Scale 1:200 @ A3	Date 25/02/2015
---------------------	--------------------

Ver. 2.1	Rev. L	Drawn by S - M	Amended by K.E.R.
-------------	-----------	-------------------	----------------------

BLOCKS 2 (part), 8., GROUND FLOOR MEZZANINE PLAN





**GENERAL NOTES**

This drawing must NOT be scaled  
 All dimensions and levels to be checked on site prior to commencement of work on site. Any discrepancies to be reported to the Supervising Officer. This drawing is to be read in conjunction with relevant consultants and specialists drawings

© Crown copyright and database rights [ 2011]  
 Ordnance Survey [ 100023372]

**NOTES**

-  = Demise of block area
-  = Block reference number
-  = Asbestos sample record available

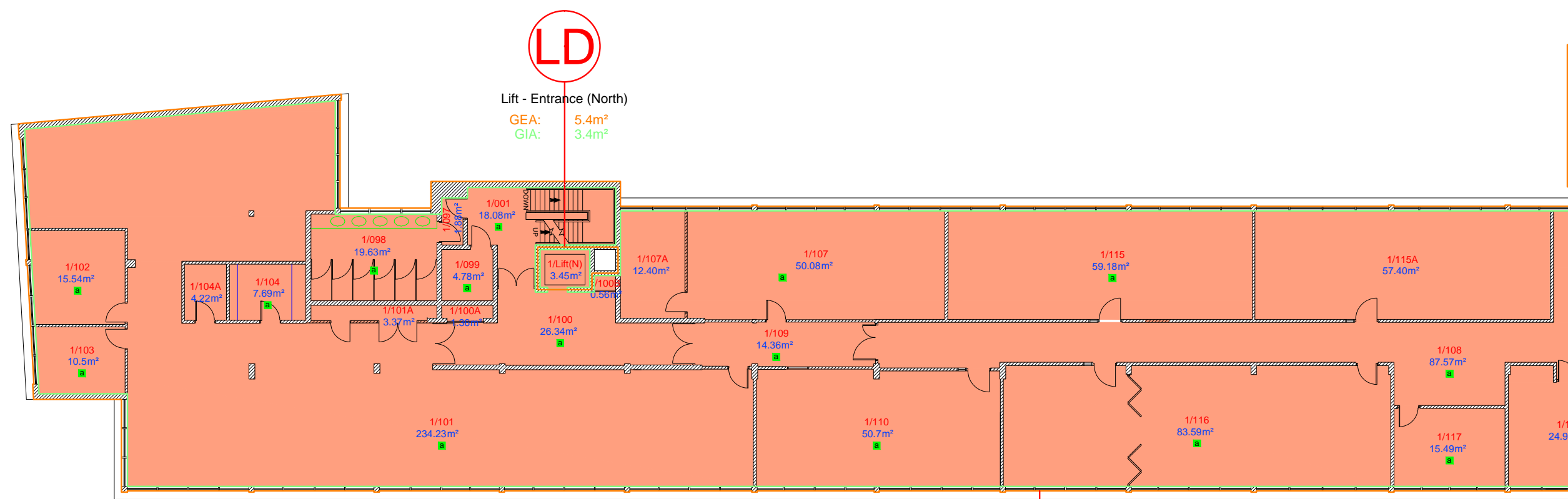

**2**

Block 2  
 GEA: 1184.4m<sup>2</sup>  
 GIA: 1113.7m<sup>2</sup>



**NPS Humber Limited**, Earle House  
 Colonial Street, Hull, HU2 8JY  
 email: [assetregisterhumber@nps.co.uk](mailto:assetregisterhumber@nps.co.uk)

in partnership with  **Hull**  
 City Council

Drawing Number  
 BON008/5 (5 of 23)

UPRN / Property Name  
 BON008 / KINGSTON HOUSE

Scale  
 1:200 @ A3

Date  
 25/02/2015

Ver.	Rev.	Drawn by	Amended by
2.1	L	S - M	K.E.R.



**BLOCK 2 (part), FIRST FLOOR PLAN**

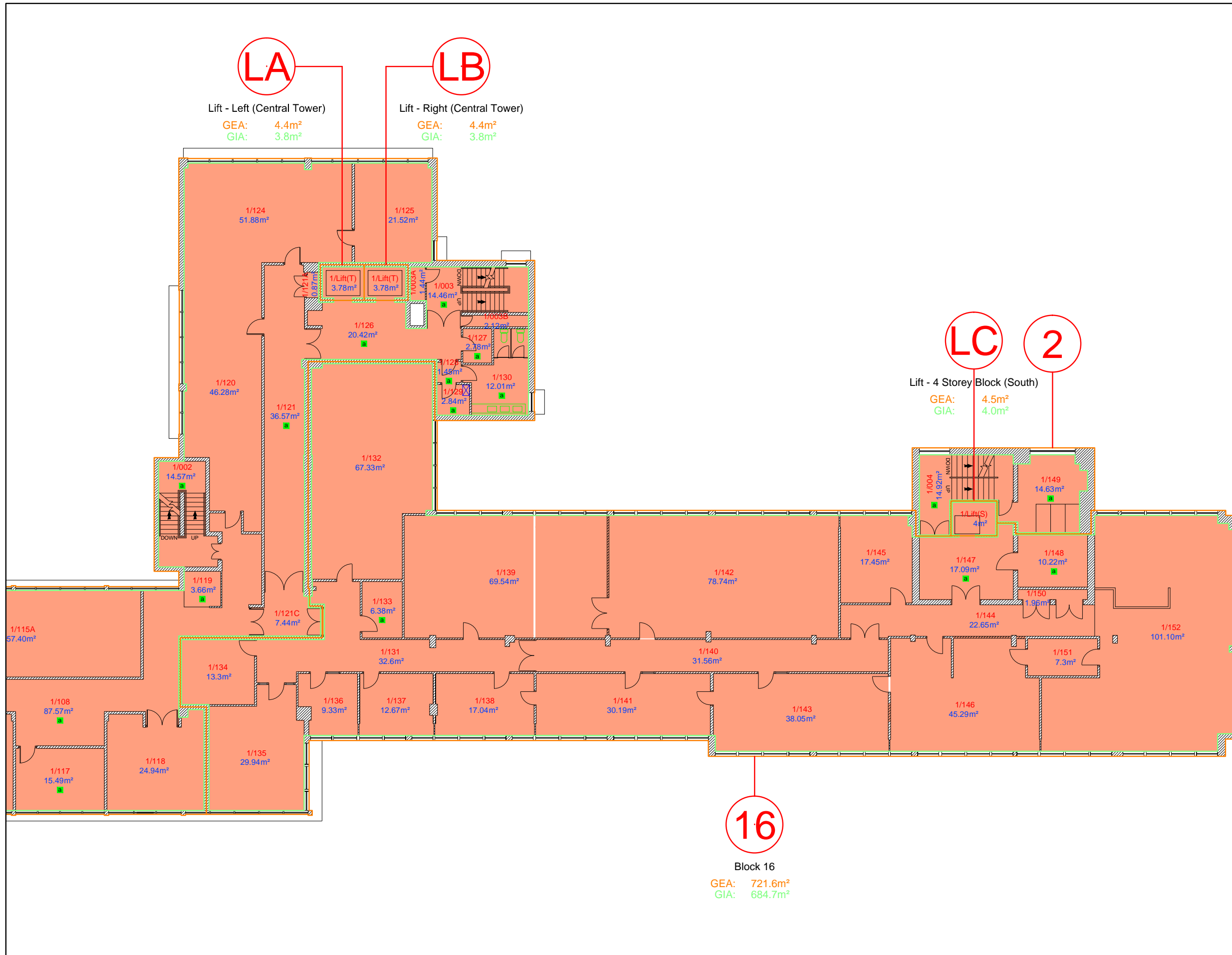

**GENERAL NOTES**

This drawing must NOT be scaled  
All dimensions and levels to be checked on site prior to commencement of work on site. Any discrepancies to be reported to the Supervising Officer. This drawing is to be read in conjunction with relevant consultants and specialists drawings

© Crown copyright and database rights [ 2011 ]  
Ordnance Survey [ 100023372 ]

- NOTES**
- = Demise of block area
  - 1 = Block reference number
  - a = Asbestos sample record available



**NPS Humber Limited**, Earle House  
Colonial Street, Hull, HU2 8JY  
email: [assetregisterhumber@nps.co.uk](mailto:assetregisterhumber@nps.co.uk)

in partnership with **Hull**  
City Council

Drawing Number  
**BON008/6 (6 of 23)**

UPRN / Property Name  
BON008 / KINGSTON HOUSE

Scale 1:200 @ A3	Date 25/02/2015
---------------------	--------------------

Ver. 2.1	Rev. L	Drawn by S - M	Amended by K.E.R.
-------------	-----------	-------------------	----------------------

**BLOCKS 2 (part), 16, FIRST FLOOR PLAN**





**GENERAL NOTES**

This drawing must NOT be scaled  
 All dimensions and levels to be checked on site prior to commencement of work on site. Any discrepancies to be reported to the Supervising Officer. This drawing is to be read in conjunction with relevant consultants and specialists drawings

© Crown copyright and database rights [ 2011 ]  
 Ordnance Survey [ 100023372 ]

**NOTES**

-  = Demise of block area
-  = Block reference number
-  = Asbestos sample record available

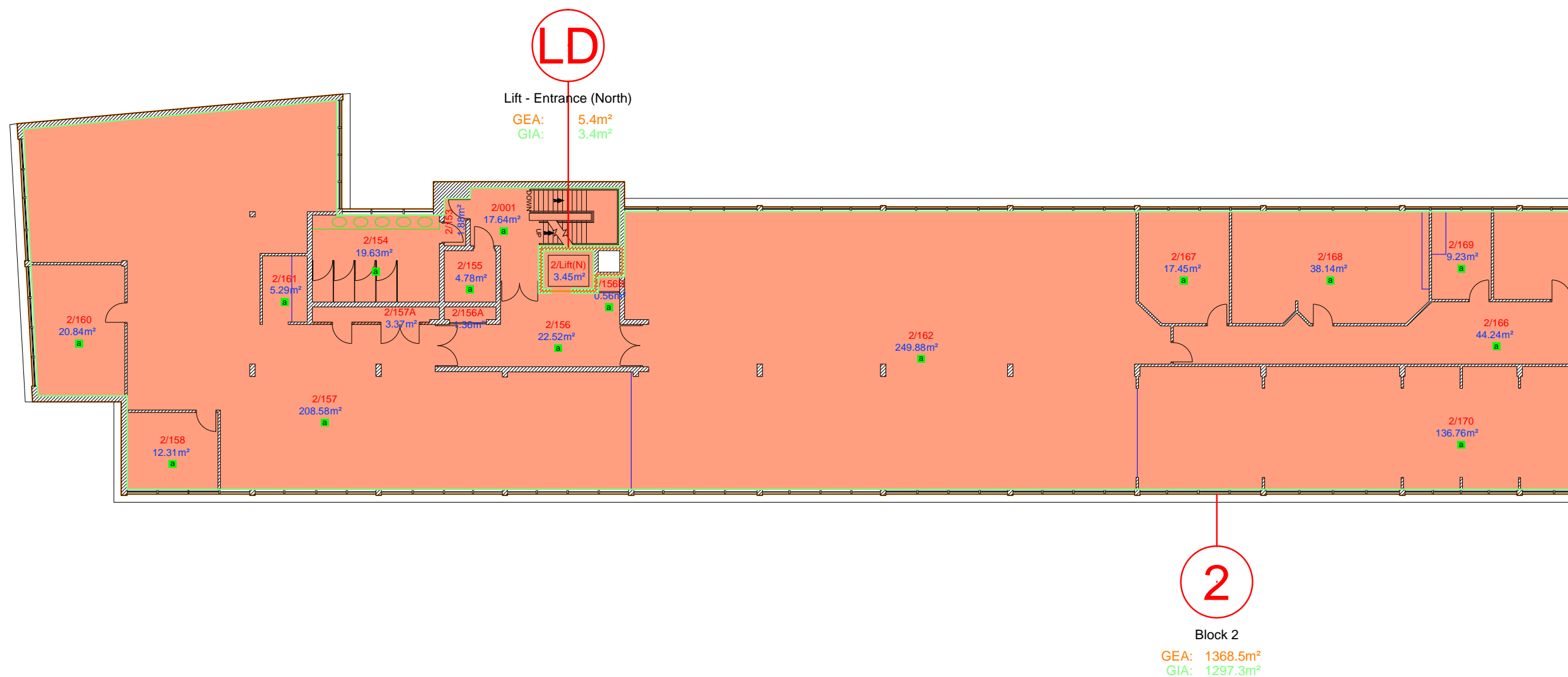

**NPS Humber Limited**, Earle House  
 Colonial Street, Hull, HU2 8JY  
 email: [assetregisterhumber@nps.co.uk](mailto:assetregisterhumber@nps.co.uk)

in partnership with  **Hull**  
 City Council

Drawing Number  
 BON008/7 (7 of 23)

UPRN / Property Name  
 BON008 / KINGSTON HOUSE

Scale  
 1:200 @ A3

Date  
 25/02/2015

Ver.	Rev.	Drawn by	Amended by
2.1	L	S - M	K.E.R.



**BLOCK 2 (part), SECOND FLOOR PLAN**

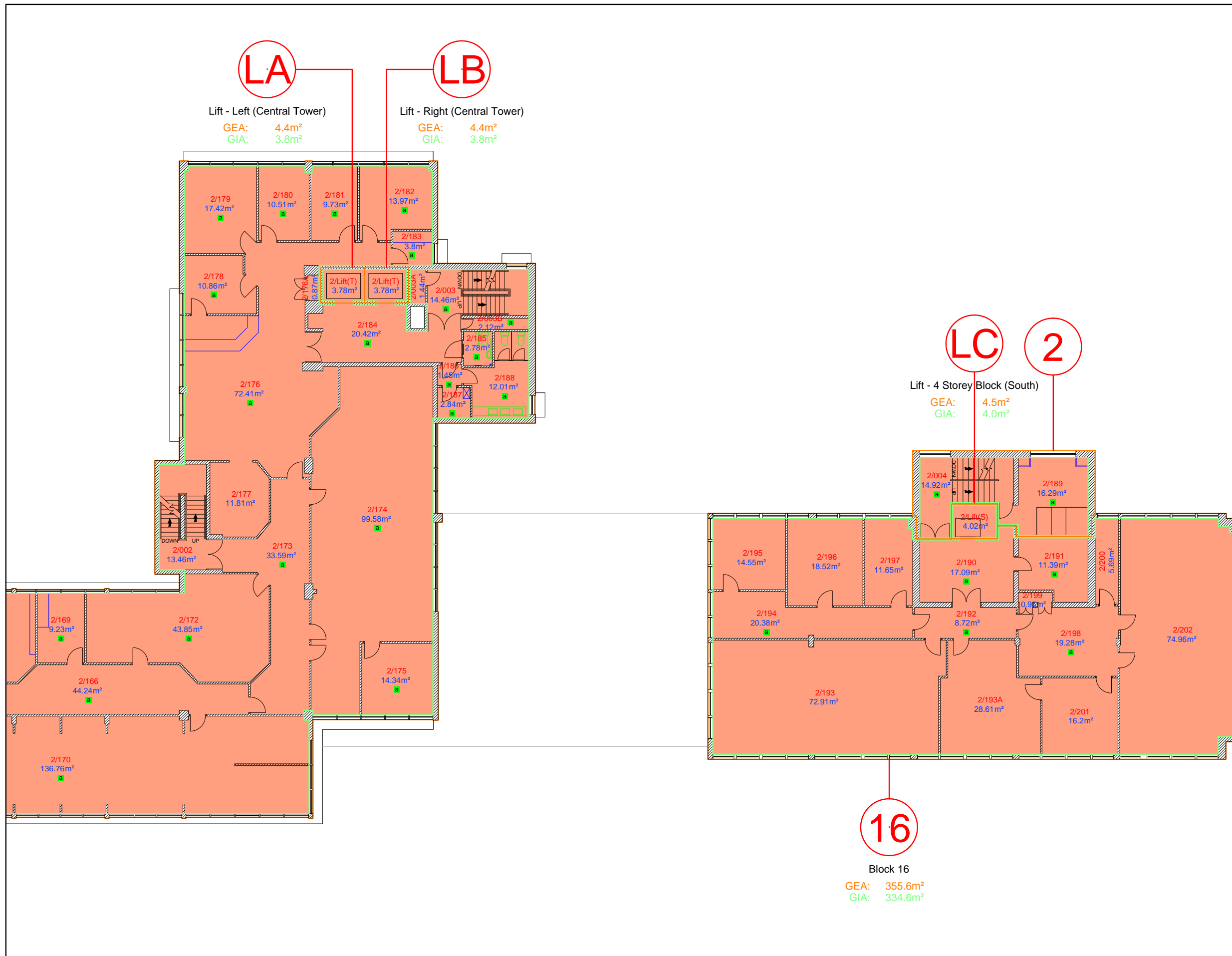

**GENERAL NOTES**

This drawing must NOT be scaled  
 All dimensions and levels to be checked on site prior to commencement of work on site. Any discrepancies to be reported to the Supervising Officer. This drawing is to be read in conjunction with relevant consultants and specialists drawings

© Crown copyright and database rights [ 2011 ]  
 Ordnance Survey [ 100023372 ]

**NOTES**

- = Demise of block area
- 1 = Block reference number
- a = Asbestos sample record available

**nps group**

**NPS Humber Limited**, Earle House  
 Colonial Street, Hull, HU2 8JY  
 email: [assetregisterhumber@nps.co.uk](mailto:assetregisterhumber@nps.co.uk)

in partnership with **Hull**  
 City Council

Drawing Number  
**BON008/8 (8 of 23)**

UPRN / Property Name  
 BON008 / KINGSTON HOUSE

Scale 1:200 @ A3		Date 25/02/2015	
Ver. 2.1	Rev. L	Drawn by S - M	Amended by K.E.R.

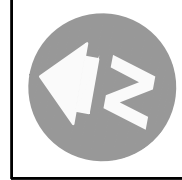



**BLOCKS 2 (part), 16, SECOND FLOOR PLAN**

**GENERAL NOTES**

This drawing must NOT be scaled  
 All dimensions and levels to be checked on site prior to commencement of work on site. Any discrepancies to be reported to the Supervising Officer. This drawing is to be read in conjunction with relevant consultants and specialists drawings

© Crown copyright and database rights [ 2011 ]  
 Ordnance Survey [ 100023372 ]

**NOTES**

-  = Demise of block area
-  = Block reference number
-  = Asbestos sample record available

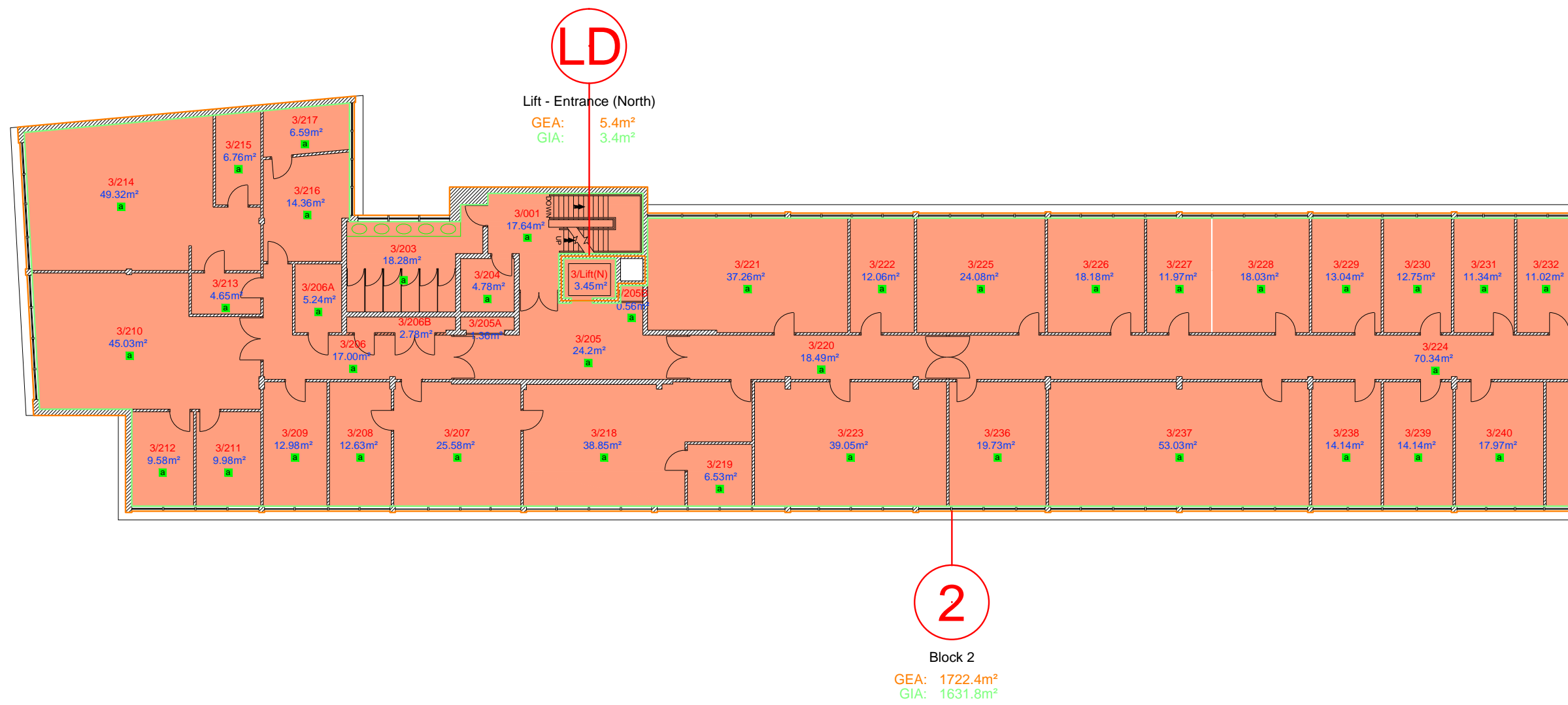

**LD**

Lift - Entrance (North)  
 GEA: 5.4m<sup>2</sup>  
 GIA: 3.4m<sup>2</sup>

**2**

Block 2  
 GEA: 1722.4m<sup>2</sup>  
 GIA: 1631.8m<sup>2</sup>



**NPS Humber Limited**, Earle House  
 Colonial Street, Hull, HU2 8JY  
 email: [assetregisterhumber@nps.co.uk](mailto:assetregisterhumber@nps.co.uk)

in partnership with  **Hull**  
 City Council

Drawing Number  
**BON008/9 (9 of 23)**

UPRN / Property Name  
 BON008 / KINGSTON HOUSE

Scale  
 1:200 @ A3

Date  
 25/02/2015

Ver.	Rev.	Drawn by	Amended by
2.1	L	S - M	K.E.R.



**BLOCK 2 (part), THIRD FLOOR PLAN**

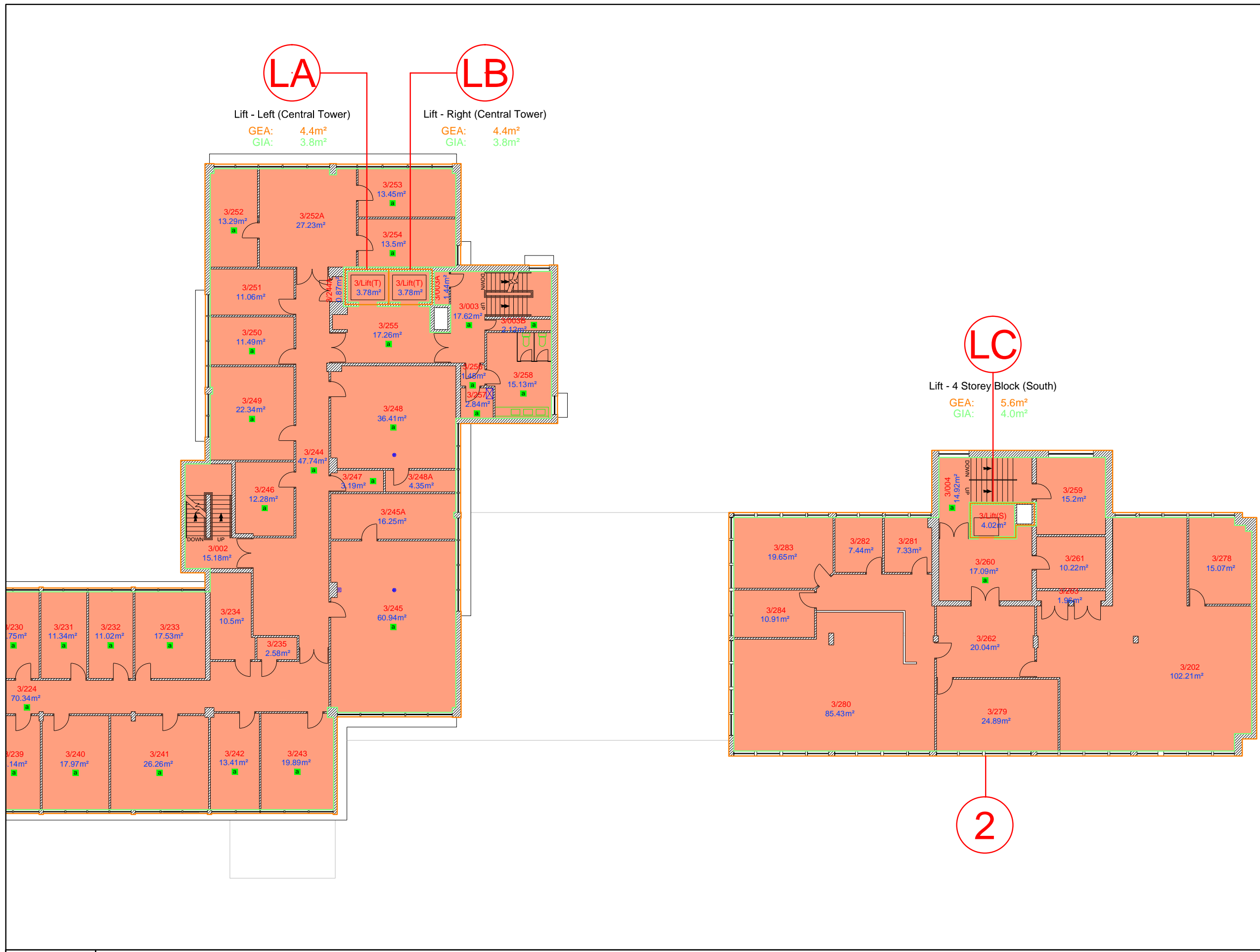

**GENERAL NOTES**

This drawing must NOT be scaled  
 All dimensions and levels to be checked on site prior to commencement of work on site. Any discrepancies to be reported to the Supervising Officer. This drawing is to be read in conjunction with relevant consultants and specialists drawings

© Crown copyright and database rights [ 2011 ]  
 Ordnance Survey [ 100023372 ]

**NOTES**

- = Demise of block area
- 1 = Block reference number
- a = Asbestos sample record available

**nps group**

**NPS Humber Limited**, Earle House  
 Colonial Street, Hull, HU2 8JY  
 email: [assetregisterhumber@nps.co.uk](mailto:assetregisterhumber@nps.co.uk)

in partnership with **Hull**  
 City Council

Drawing Number  
**BON008/10 (10 of 23)**

UPRN / Property Name  
**BON008 / KINGSTON HOUSE**

Scale 1:200 @ A3	Date 25/02/2015
---------------------	--------------------

Ver. 2.1	Rev. L	Drawn by S - M	Amended by K.E.R.
-------------	-----------	-------------------	----------------------

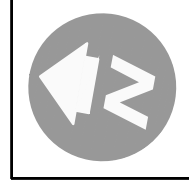



**BLOCK 2 (part), THIRD FLOOR PLAN**

**GENERAL NOTES**

This drawing must NOT be scaled  
 All dimensions and levels to be checked on site prior to commencement of work on site. Any discrepancies to be reported to the Supervising Officer. This drawing is to be read in conjunction with relevant consultants and specialists drawings

© Crown copyright and database rights [ 2011 ]  
 Ordnance Survey [ 100023372 ]

**NOTES**

-  = Demise of block area
-  = Block reference number
-  = Asbestos sample record available

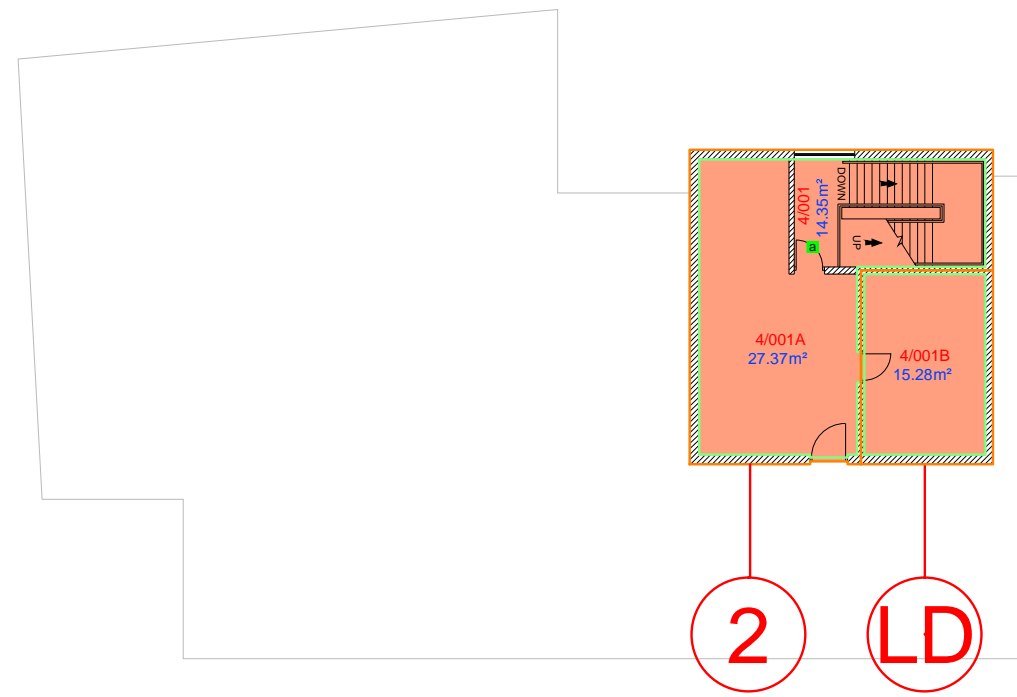

Lift - Entrance (North)  
 GEA: 17.9m<sup>2</sup>  
 GIA: 15.3m<sup>2</sup>



**NPS Humber Limited**, Earle House  
 Colonial Street, Hull, HU2 8JY  
 email: [assetregisterhumber@nps.co.uk](mailto:assetregisterhumber@nps.co.uk)



Drawing Number  
 BON008/11 (11 of 23)

UPRN / Property Name  
 BON008 / KINGSTON HOUSE

Scale  
 1:200 @ A3

Date  
 25/02/2015

Ver.	Rev.	Drawn by	Amended by
2.1	L	S - M	K.E.R.

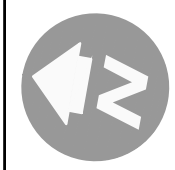

**BLOCK 2 (part), FOURTH FLOOR PLAN**

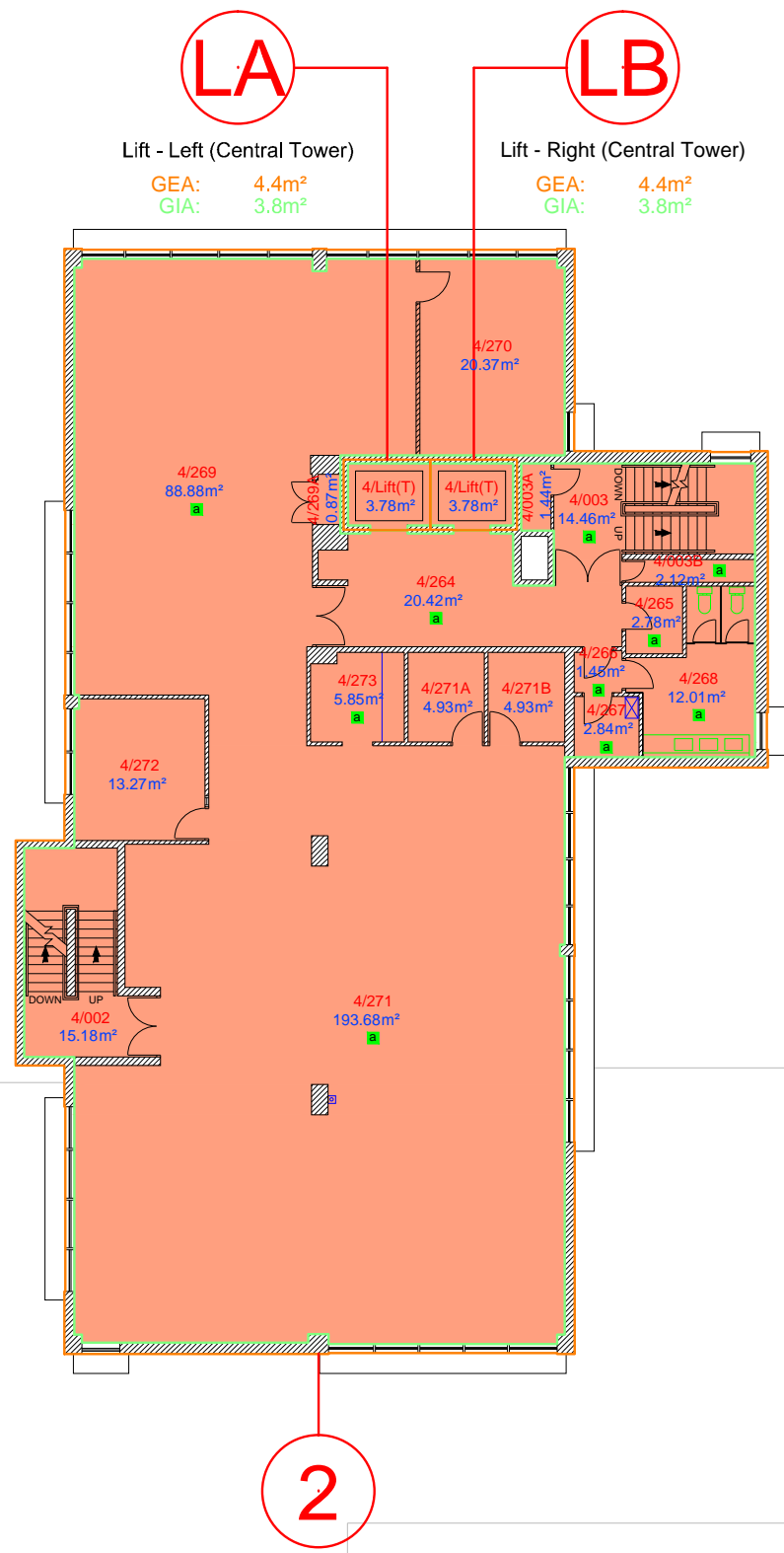

Lift - Left (Central Tower)

GEA: 4.4m²  
GIA: 3.8m²

Lift - Right (Central Tower)

GEA: 4.4m²  
GIA: 3.8m²

2

Block 2  
GEA: 535.7m²  
GIA: 490.5m²

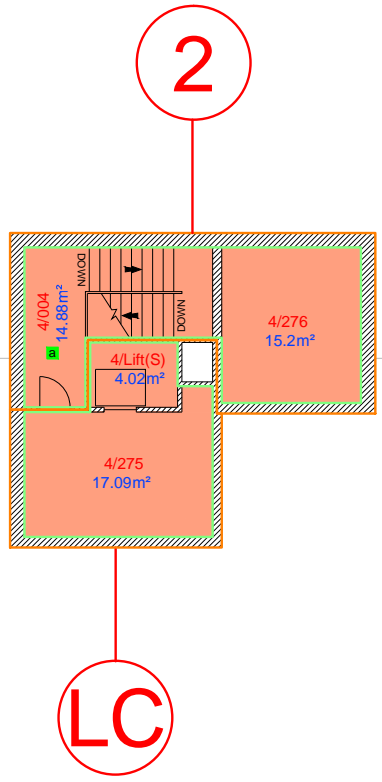

LC

Lift - 4 Storey Block (South)

GEA: 26.7m²  
GIA: 21.4m²

GENERAL NOTES

This drawing must NOT be scaled  
All dimensions and levels to be checked on site prior to commencement of work on site. Any discrepancies to be reported to the Supervising Officer. This drawing is to be read in conjunction with relevant consultants and specialists drawings

© Crown copyright and database rights [ 2011 ]  
Ordnance Survey [ 100023372 ]

NOTES

- = Demise of block area
- 1 = Block reference number
- a = Asbestos sample record available



**NPS Humber Limited**, Earle House  
Colonial Street, Hull, HU2 8JY  
*email: assetregisterhumber@nps.co.uk*

in partnership with Hull City Council

Drawing Number  
BON008/12 (12 of 23)

UPRN / Property Name  
BON008 / KINGSTON HOUSE

Scale: 1:200 @ A3  
Date: 25/02/2015

Ver.	Rev.	Drawn by	Amended by
2.1	L	S - M	K.E.R.

BLOCK 2 (part), FOURTH FLOOR PLAN



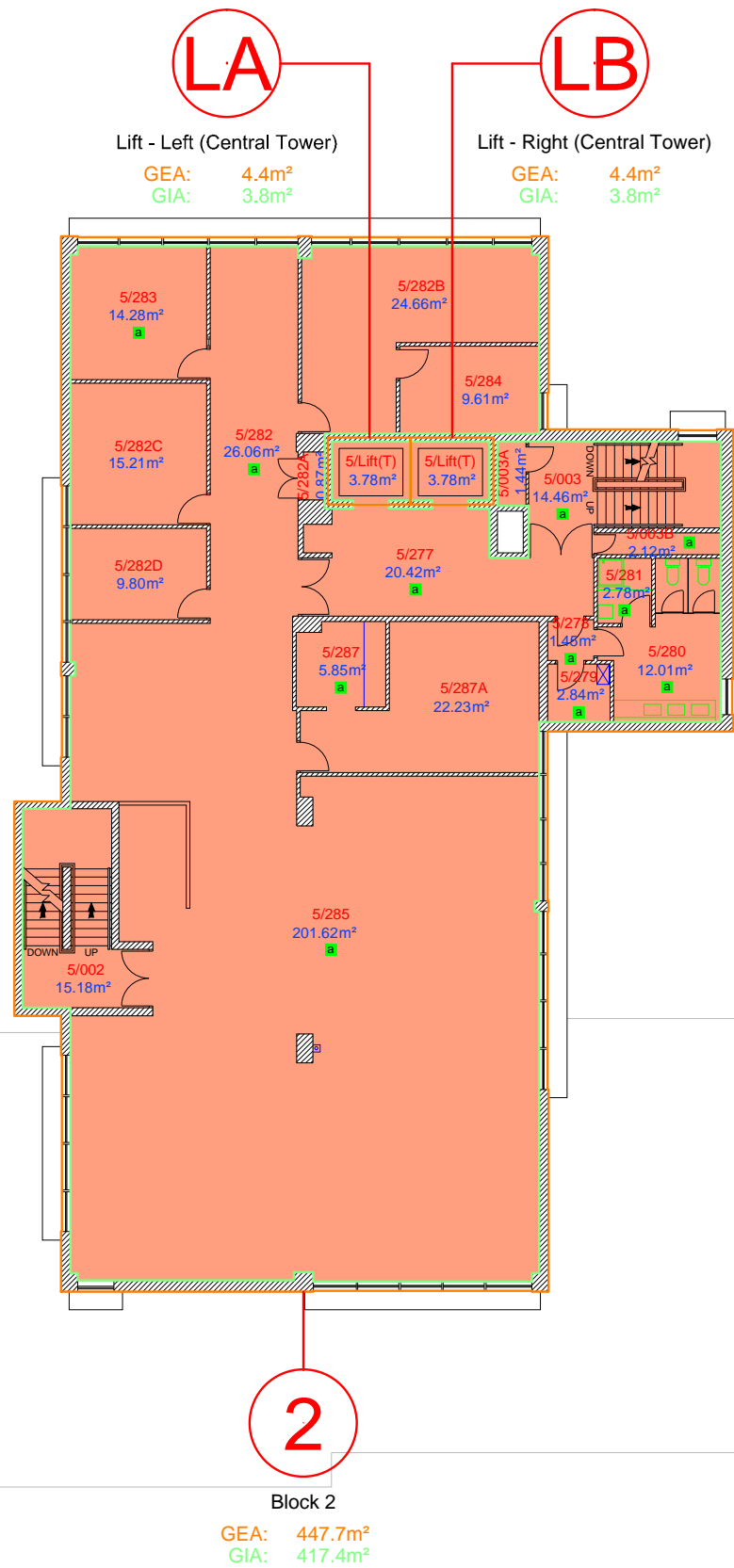

Lift - Left (Central Tower)

GEA: 4.4m<sup>2</sup>  
GIA: 3.8m<sup>2</sup>

Lift - Right (Central Tower)

GEA: 4.4m<sup>2</sup>  
GIA: 3.8m<sup>2</sup>

2

Block 2

GEA: 447.7m<sup>2</sup>  
GIA: 417.4m<sup>2</sup>

GENERAL NOTES

This drawing must NOT be scaled  
All dimensions and levels to be checked on site prior to commencement of work on site. Any discrepancies to be reported to the Supervising Officer. This drawing is to be read in conjunction with relevant consultants and specialists drawings

© Crown copyright and database rights [ 2011 ]  
Ordnance Survey [ 100023372 ]

NOTES

- = Demise of block area
- 1 = Block reference number
- a = Asbestos sample record available



**NPS Humber Limited**, Earle House  
Colonial Street, Hull, HU2 8JY  
*email: assetregisterhumber@nps.co.uk*

in partnership with **Hull**  
City Council

Drawing Number

BON008/13 (13 of 23)

UPRN / Property Name

BON008 / KINGSTON HOUSE

Scale

1:200 @ A3

Date

25/02/2015

Ver.

2.1

Rev.

L

Drawn by

S - M

Amended by

K.E.R.

BLOCK 2, FIFTH FLOOR PLAN



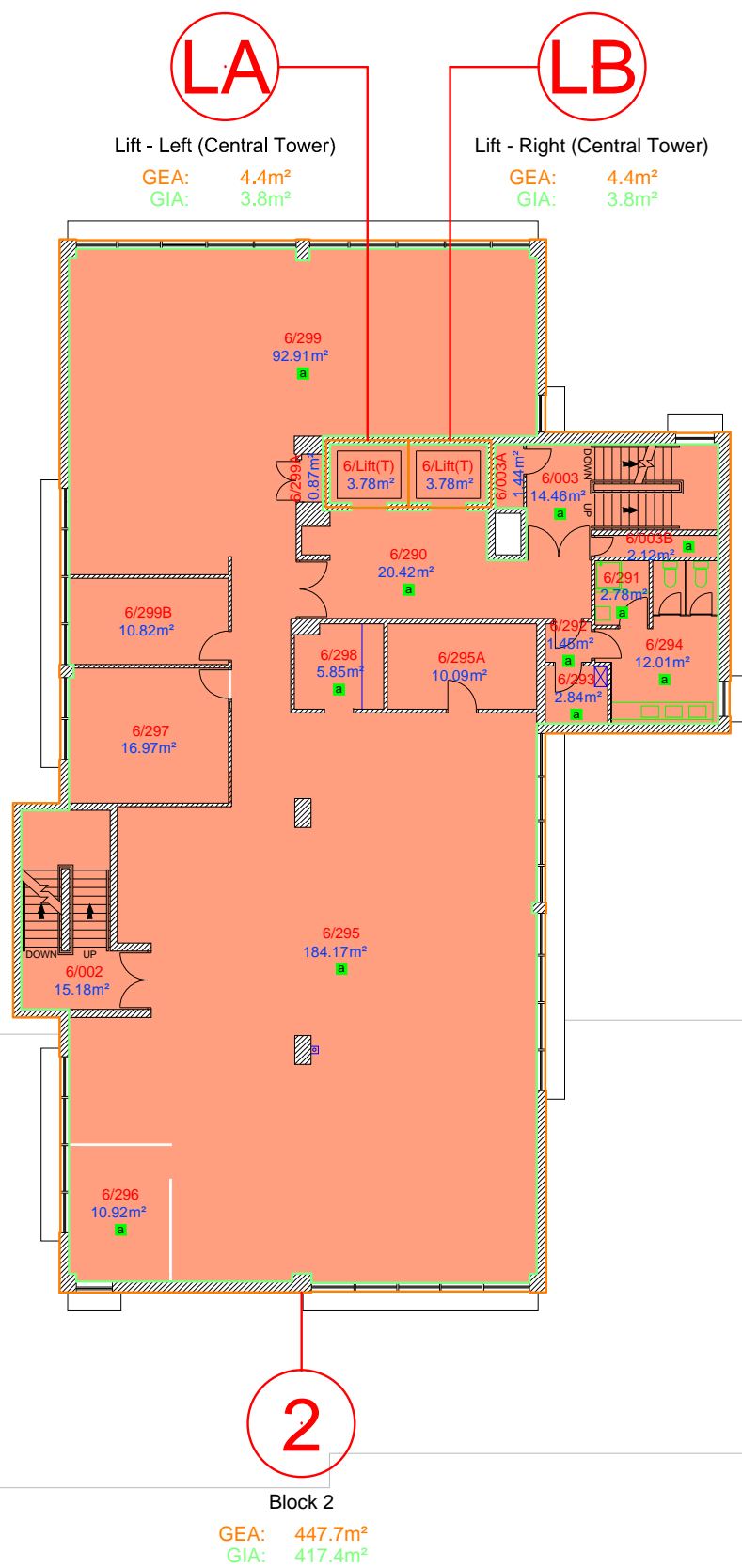

Lift - Left (Central Tower)

GEA: 4.4m<sup>2</sup>  
GIA: 3.8m<sup>2</sup>

Lift - Right (Central Tower)

GEA: 4.4m<sup>2</sup>  
GIA: 3.8m<sup>2</sup>

2

Block 2

GEA: 447.7m<sup>2</sup>  
GIA: 417.4m<sup>2</sup>

GENERAL NOTES

This drawing must NOT be scaled  
All dimensions and levels to be checked on site prior to commencement of work on site. Any discrepancies to be reported to the Supervising Officer. This drawing is to be read in conjunction with relevant consultants and specialists drawings

© Crown copyright and database rights [ 2011 ]  
Ordnance Survey [ 100023372 ]

NOTES

- = Demise of block area
- 1 = Block reference number
- a = Asbestos sample record available



**NPS Humber Limited**, Earle House  
Colonial Street, Hull, HU2 8JY  
*email: assetregisterhumber@nps.co.uk*

in partnership with Hull City Council

Drawing Number  
BON008/14 (14 of 23)

UPRN / Property Name  
BON008 / KINGSTON HOUSE

Scale 1:200 @ A3	Date 25/02/2015
---------------------	--------------------

Ver. 2.1	Rev. L	Drawn by S - M	Amended by K.E.R.
-------------	-----------	-------------------	----------------------

BLOCK 2, SIXTH FLOOR PLAN





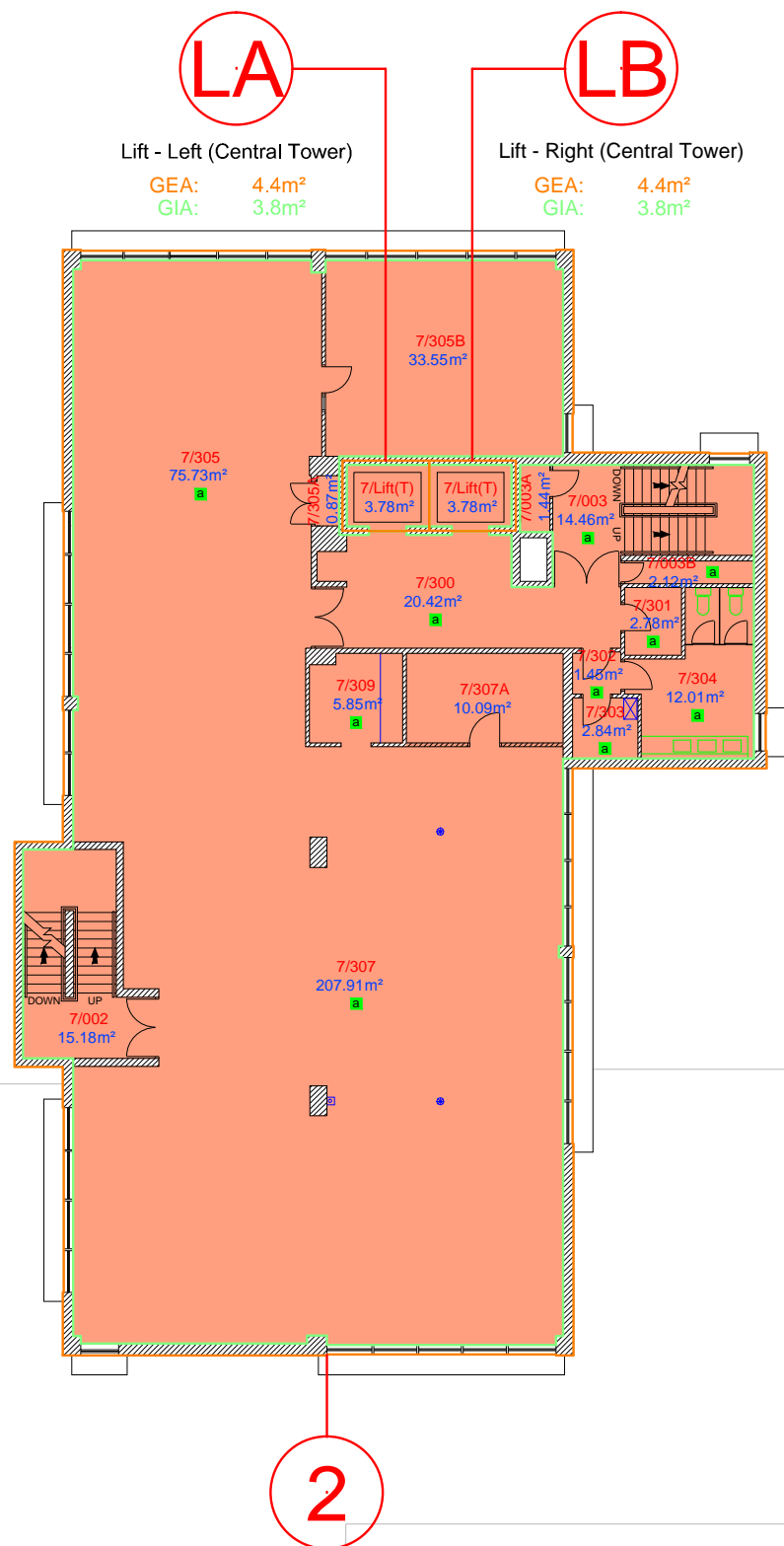

Lift - Left (Central Tower)

GEA: 4.4m<sup>2</sup>  
GIA: 3.8m<sup>2</sup>

Lift - Right (Central Tower)

GEA: 4.4m<sup>2</sup>  
GIA: 3.8m<sup>2</sup>

2

Block 2

GEA: 447.7m<sup>2</sup>  
GIA: 417.4m<sup>2</sup>

GENERAL NOTES

This drawing must NOT be scaled  
All dimensions and levels to be checked on site prior to commencement of work on site. Any discrepancies to be reported to the Supervising Officer. This drawing is to be read in conjunction with relevant consultants and specialists drawings

© Crown copyright and database rights [ 2011 ]  
Ordnance Survey [ 100023372 ]

NOTES

- = Demise of block area
- 1 = Block reference number
- a = Asbestos sample record available



**NPS Humber Limited**, Earle House  
Colonial Street, Hull, HU2 8JY  
*email: assetregisterhumber@nps.co.uk*

in partnership with **Hull**  
City Council

Drawing Number  
BON008/15 (15 of 23)

UPRN / Property Name  
BON008 / KINGSTON HOUSE

Scale 1:200 @ A3	Date 25/02/2015
---------------------	--------------------

Ver. 2.1	Rev. L	Drawn by S - M	Amended by K.E.R.
-------------	-----------	-------------------	----------------------



BLOCK 2, SEVENTH FLOOR PLAN

**GENERAL NOTES**

This drawing must NOT be scaled  
 All dimensions and levels to be checked on site prior to commencement of work on site. Any discrepancies to be reported to the Supervising Officer. This drawing is to be read in conjunction with relevant consultants and specialists drawings

© Crown copyright and database rights [ 2011 ]  
 Ordnance Survey [ 100023372 ]

**NOTES**

- = Demise of block area
- 1 = Block reference number
- a = Asbestos sample record available

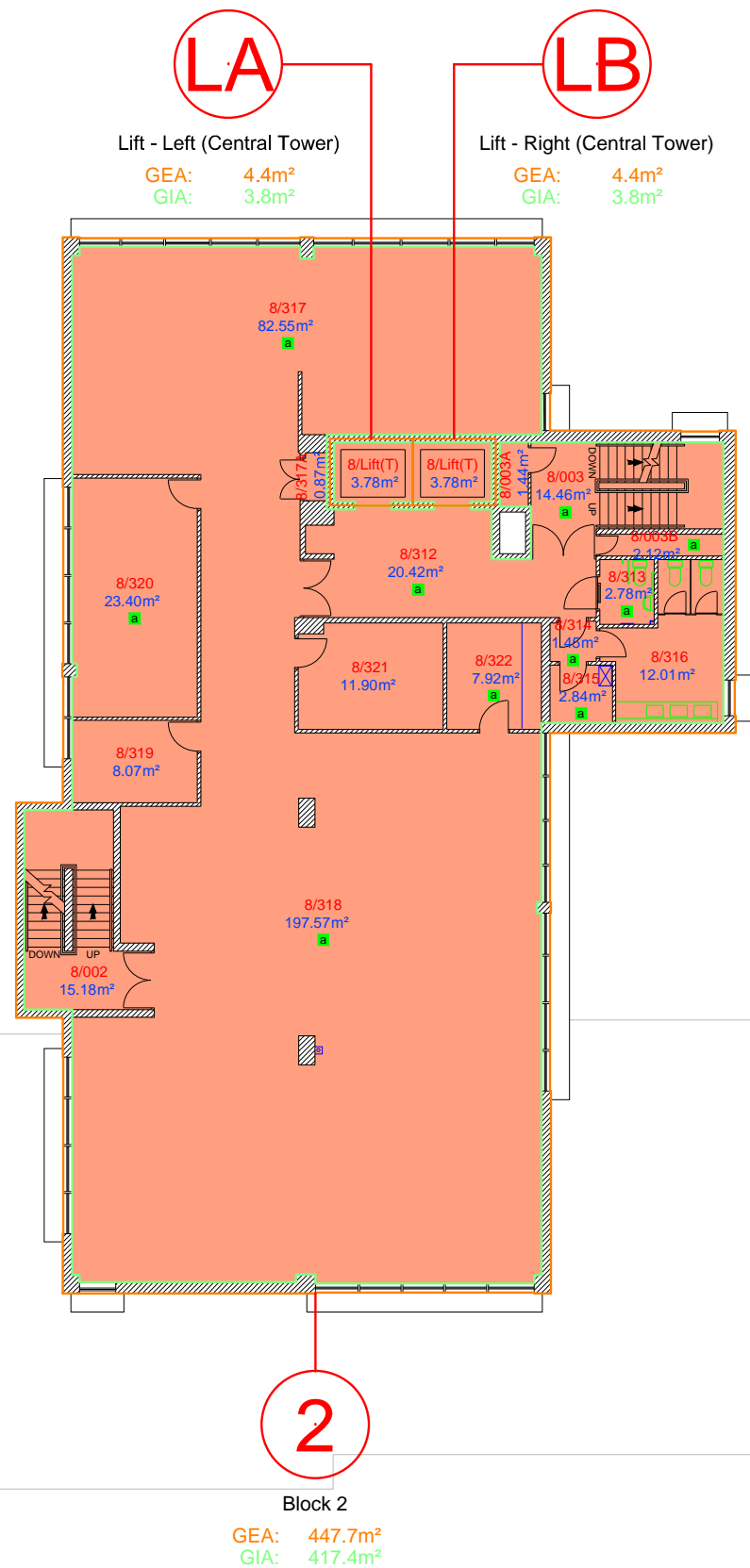

**BLOCK 2, EIGHTH FLOOR PLAN**



**NPS Humber Limited**, Earle House  
 Colonial Street, Hull, HU2 8JY  
 email: [assetregisterhumber@nps.co.uk](mailto:assetregisterhumber@nps.co.uk)



Drawing Number  
 BON008/16 (16 of 23)

UPRN / Property Name  
 BON008 / KINGSTON HOUSE

Scale 1:200 @ A3	Date 25/02/2015
---------------------	--------------------

Ver. 2.1	Rev. L	Drawn by S - M	Amended by K.E.R.
-------------	-----------	-------------------	----------------------

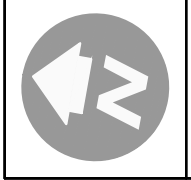

**GENERAL NOTES**

This drawing must NOT be scaled  
 All dimensions and levels to be checked on site prior to commencement of work on site. Any discrepancies to be reported to the Supervising Officer. This drawing is to be read in conjunction with relevant consultants and specialists drawings

© Crown copyright and database rights [ 2011 ]  
 Ordnance Survey [ 100023372 ]

**NOTES**

- = Demise of block area
- 1 = Block reference number
- a = Asbestos sample record available

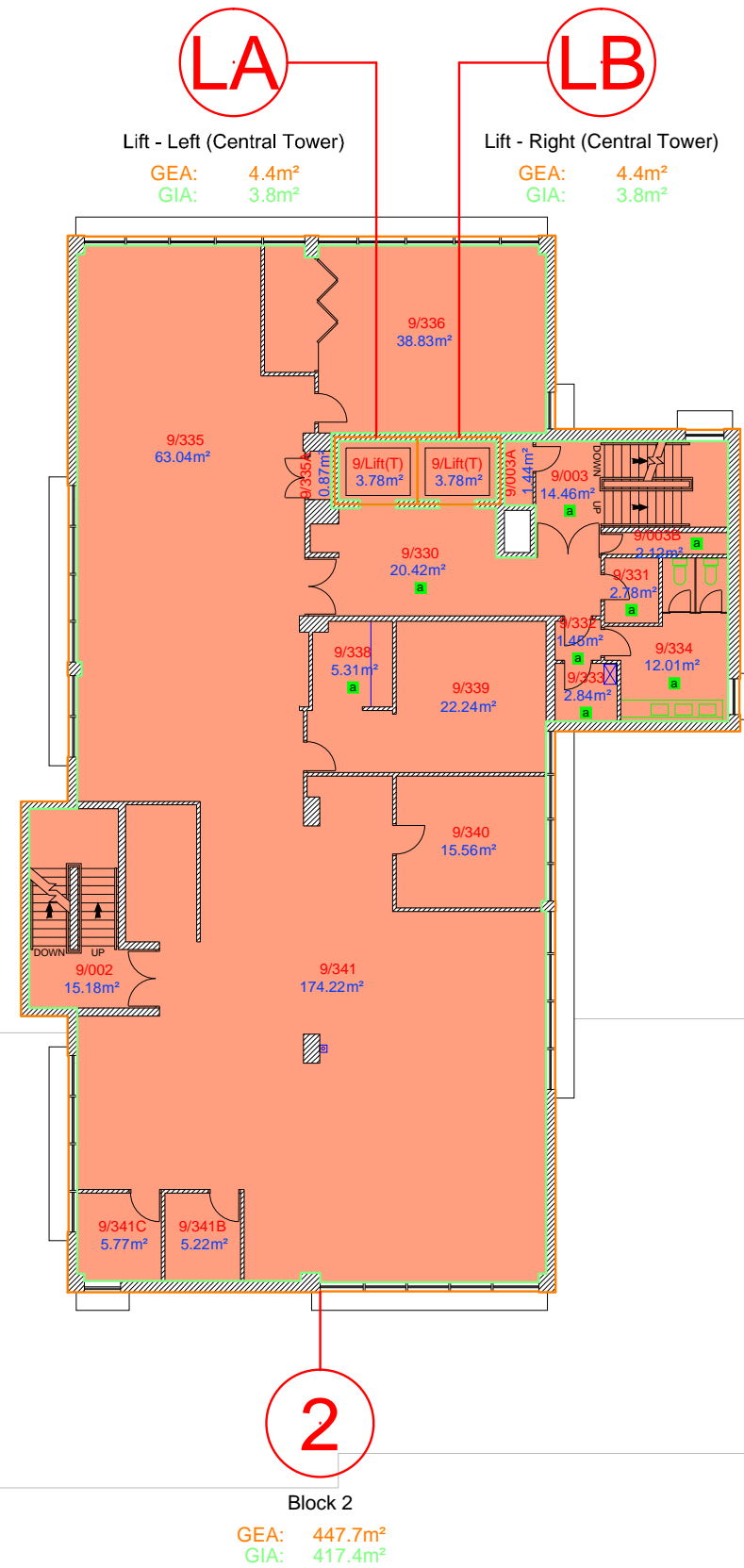

**BLOCK 2, NINTH FLOOR PLAN**



**NPS Humber Limited**, Earle House  
 Colonial Street, Hull, HU2 8JY  
 email: [assetregisterhumber@nps.co.uk](mailto:assetregisterhumber@nps.co.uk)

in partnership with **Hull**  
 City Council

**Drawing Number**

BON008/17 (17 of 23)

**UPRN / Property Name**

BON008 / KINGSTON HOUSE

**Scale**

1:200 @ A3

**Date**

25/02/2015

Ver.	Rev.	Drawn by	Amended by
2.1	L	S - M	K.E.R.



**GENERAL NOTES**

This drawing must NOT be scaled  
 All dimensions and levels to be checked on site prior to commencement of work on site. Any discrepancies to be reported to the Supervising Officer. This drawing is to be read in conjunction with relevant consultants and specialists drawings

© Crown copyright and database rights [ 2011 ]  
 Ordnance Survey [ 100023372 ]

**NOTES**

- = Demise of block area
- 1 = Block reference number
- a = Asbestos sample record available

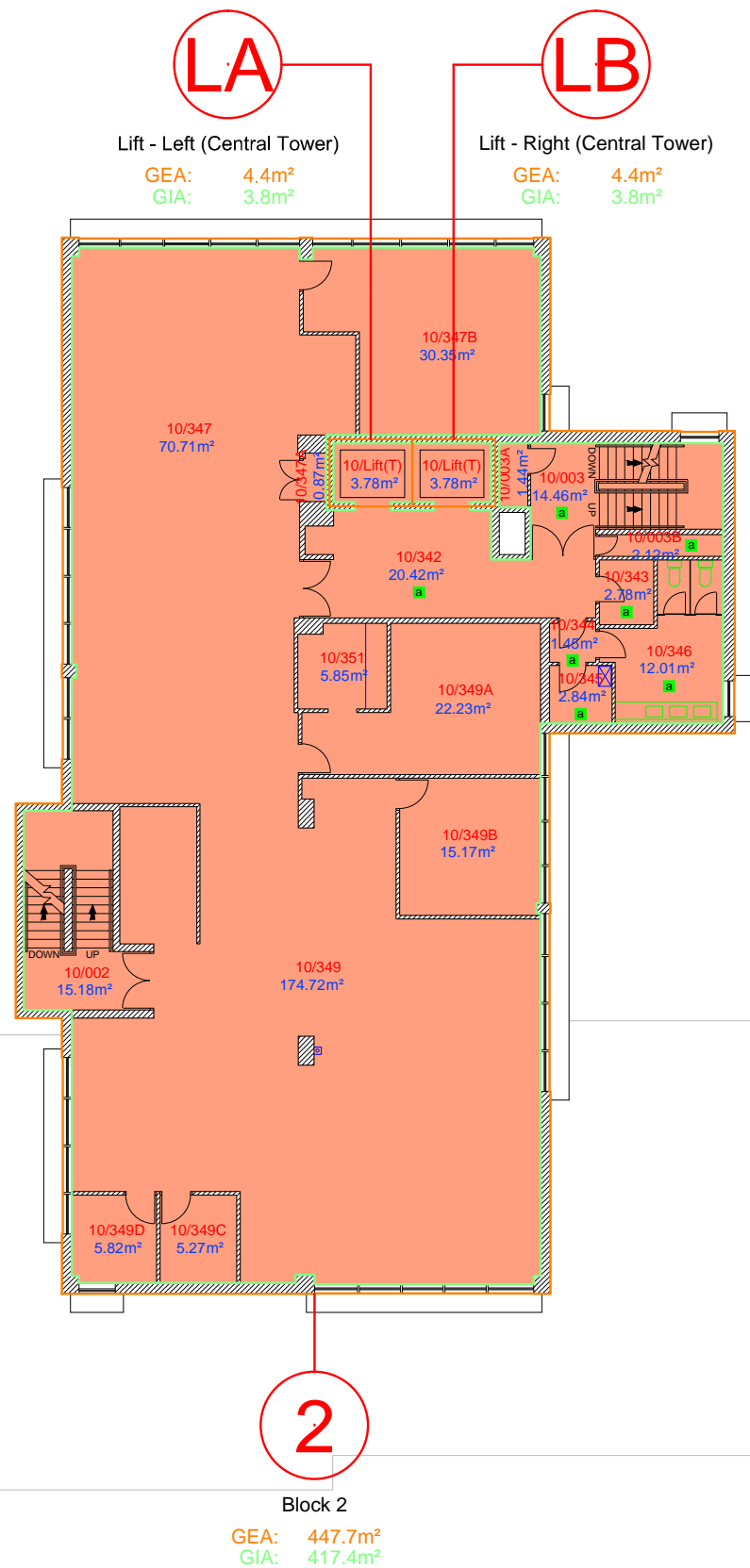

Lift - Left (Central Tower)  
 GEA: 4.4m²  
 GIA: 3.8m²

Lift - Right (Central Tower)  
 GEA: 4.4m²  
 GIA: 3.8m²

2  
 Block 2  
 GEA: 447.7m²  
 GIA: 417.4m²



**NPS Humber Limited**, Earle House  
 Colonial Street, Hull, HU2 8JY  
 email: [assetregisterhumber@nps.co.uk](mailto:assetregisterhumber@nps.co.uk)

in partnership with Hull City Council

Drawing Number  
 BON008/18 (18 of 23)

UPRN / Property Name  
 BON008 / KINGSTON HOUSE

Scale  
 1:200 @ A3

Date  
 25/02/2015

Ver.	Rev.	Drawn by	Amended by
2.1	L	S - M	K.E.R.

**BLOCK 2, TENTH FLOOR PLAN**

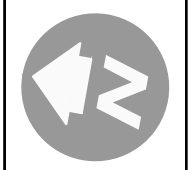

**GENERAL NOTES**

This drawing must NOT be scaled  
 All dimensions and levels to be checked on site prior to commencement of work on site. Any discrepancies to be reported to the Supervising Officer. This drawing is to be read in conjunction with relevant consultants and specialists drawings

© Crown copyright and database rights [ 2011 ]  
 Ordnance Survey [ 100023372 ]

**NOTES**

- = Demise of block area
- 1 = Block reference number
- a = Asbestos sample record available

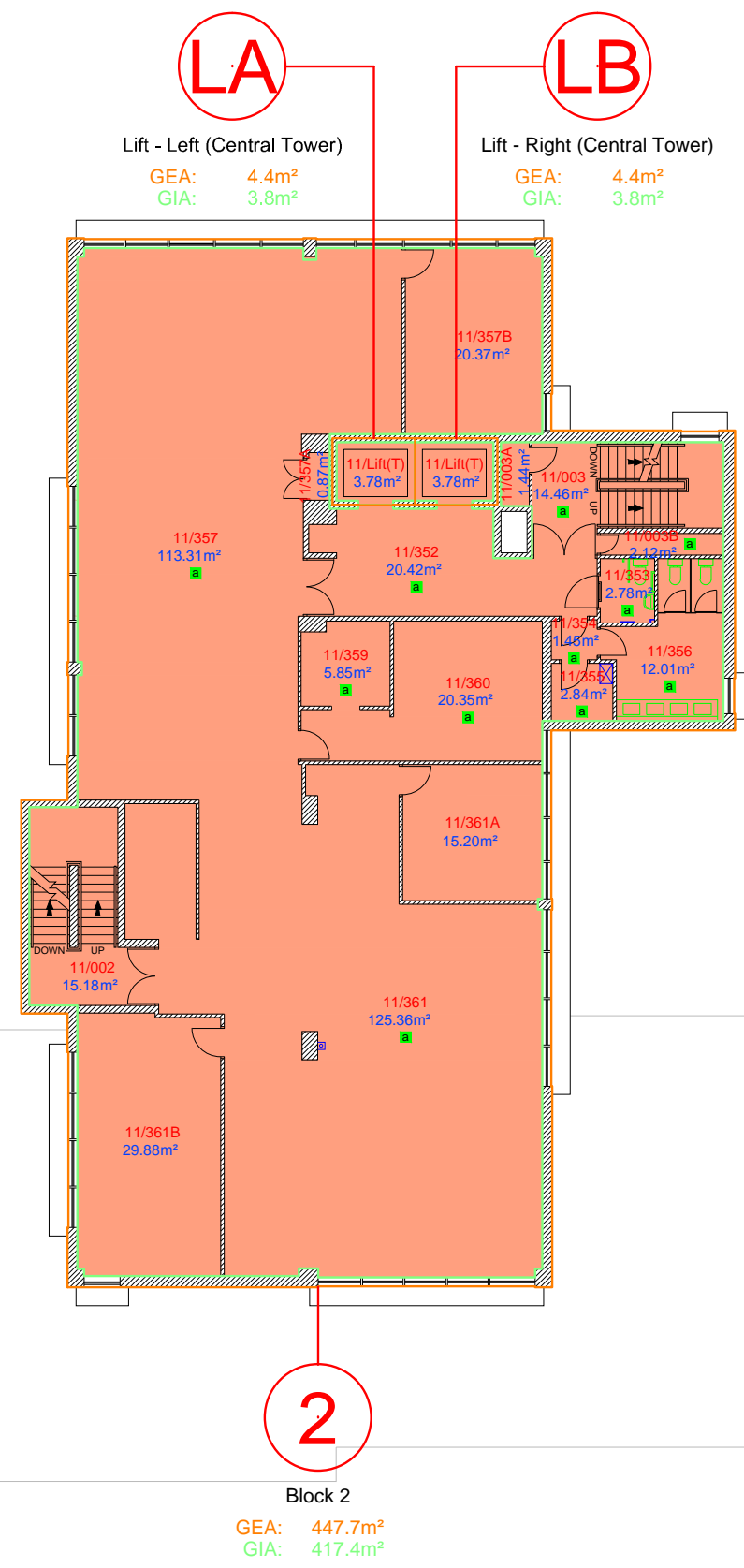

**BLOCK 2, ELEVENTH FLOOR PLAN**



**NPS Humber Limited**, Earle House  
 Colonial Street, Hull, HU2 8JY  
 email: [assetregisterhumber@nps.co.uk](mailto:assetregisterhumber@nps.co.uk)

in partnership with **Hull**  
 City Council

Drawing Number  
**BON008/19 (19 of 23)**

UPRN / Property Name  
 BON008 / KINGSTON HOUSE

Scale  
 1:200.0001 @ A3

Date  
 25/02/2015

Ver.	Rev.	Drawn by	Amended by
2.1	L	S - M	K.E.R.

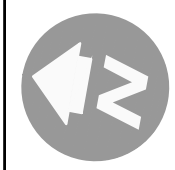

**GENERAL NOTES**

This drawing must NOT be scaled  
 All dimensions and levels to be checked on site prior to commencement of work on site. Any discrepancies to be reported to the Supervising Officer. This drawing is to be read in conjunction with relevant consultants and specialists drawings

© Crown copyright and database rights [ 2011 ]  
 Ordnance Survey [ 100023372 ]

**NOTES**

- = Demise of block area
- 1 = Block reference number
- a = Asbestos sample record available

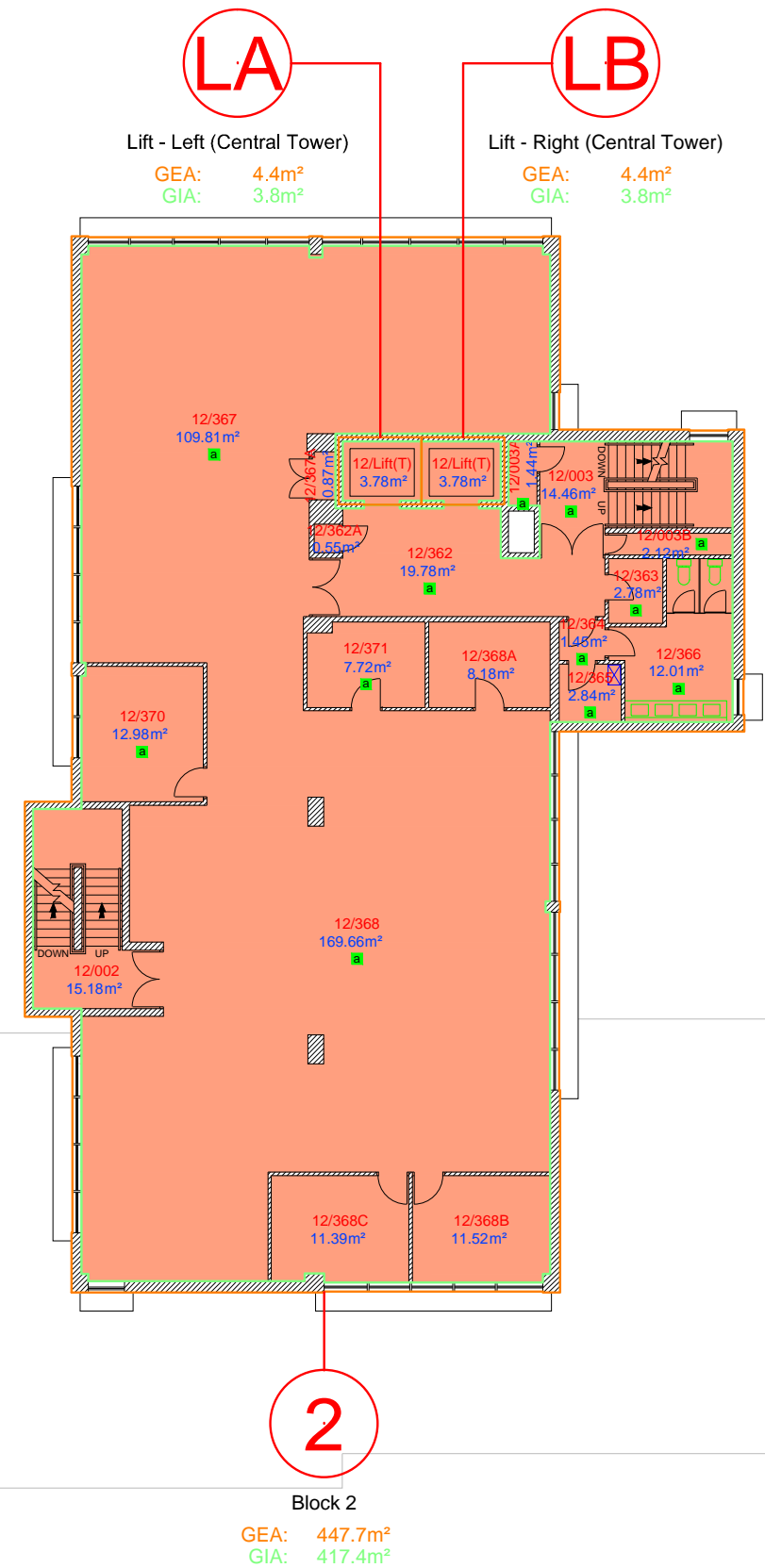

**LA**  
 Lift - Left (Central Tower)  
 GEA: 4.4m<sup>2</sup>  
 GIA: 3.8m<sup>2</sup>

**LB**  
 Lift - Right (Central Tower)  
 GEA: 4.4m<sup>2</sup>  
 GIA: 3.8m<sup>2</sup>

**2**  
 Block 2  
 GEA: 447.7m<sup>2</sup>  
 GIA: 417.4m<sup>2</sup>



**NPS Humber Limited**, Earle House  
 Colonial Street, Hull, HU2 8JY  
 email: [assetregisterhumber@nps.co.uk](mailto:assetregisterhumber@nps.co.uk)



Drawing Number  
 BON008/20 (20 of 23)

UPRN / Property Name  
 BON008 / KINGSTON HOUSE

Scale: 1:200 @ A3  
 Date: 25/02/2015

Ver.	Rev.	Drawn by	Amended by
2.1	L	S - M	K.E.R.

**BLOCK 2, TWELFTH FLOOR PLAN**

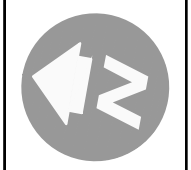



**GENERAL NOTES**

This drawing must NOT be scaled  
 All dimensions and levels to be checked on site prior to commencement of work on site. Any discrepancies to be reported to the Supervising Officer. This drawing is to be read in conjunction with relevant consultants and specialists drawings

© Crown copyright and database rights [ 2011]  
 Ordnance Survey [ 100023372]

**NOTES**

-  = Demise of block area
-  = Block reference number
-  = Asbestos sample record available

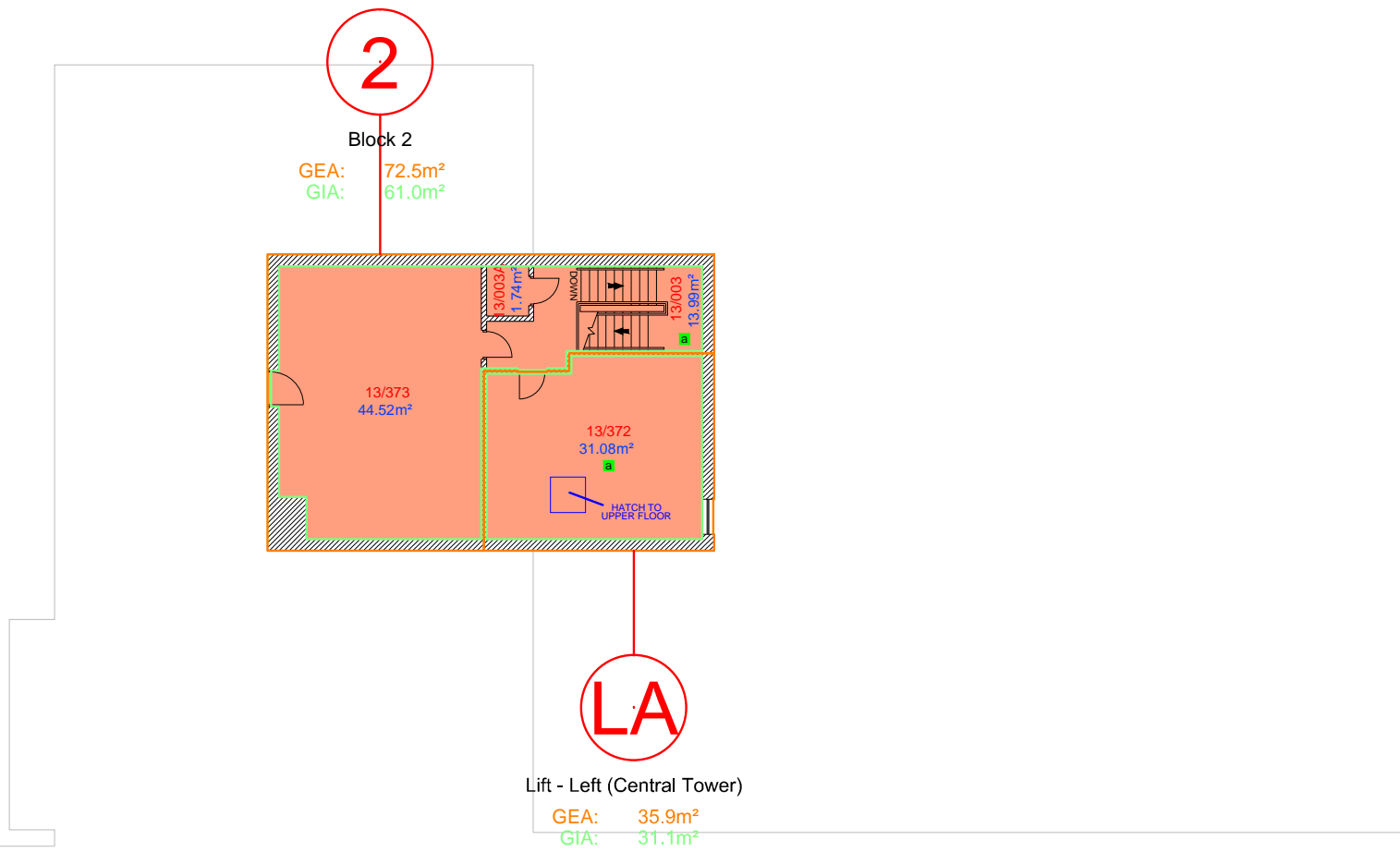

**NPS Humber Limited**, Earle House  
 Colonial Street, Hull, HU2 8JY  
 email: [assetregisterhumber@nps.co.uk](mailto:assetregisterhumber@nps.co.uk)



Drawing Number  
 BON008/21 (21 of 23)

UPRN / Property Name  
 BON008 / KINGSTON HOUSE

Scale  
 1:200 @ A3

Date  
 25/02/2015

Ver.	Rev.	Drawn by	Amended by
2.1	L	S - M	K.E.R.

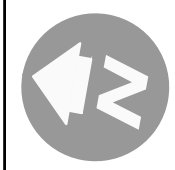



**BLOCK 2, THIRTEENTH FLOOR PLAN**

**GENERAL NOTES**

This drawing must NOT be scaled  
 All dimensions and levels to be checked on site prior to commencement of work on site. Any discrepancies to be reported to the Supervising Officer. This drawing is to be read in conjunction with relevant consultants and specialists drawings

© Crown copyright and database rights [ 2011 ]  
 Ordnance Survey [ 100023372 ]

**NOTES**

-  = Demise of block area
-  = Block reference number
-  = Asbestos sample record available

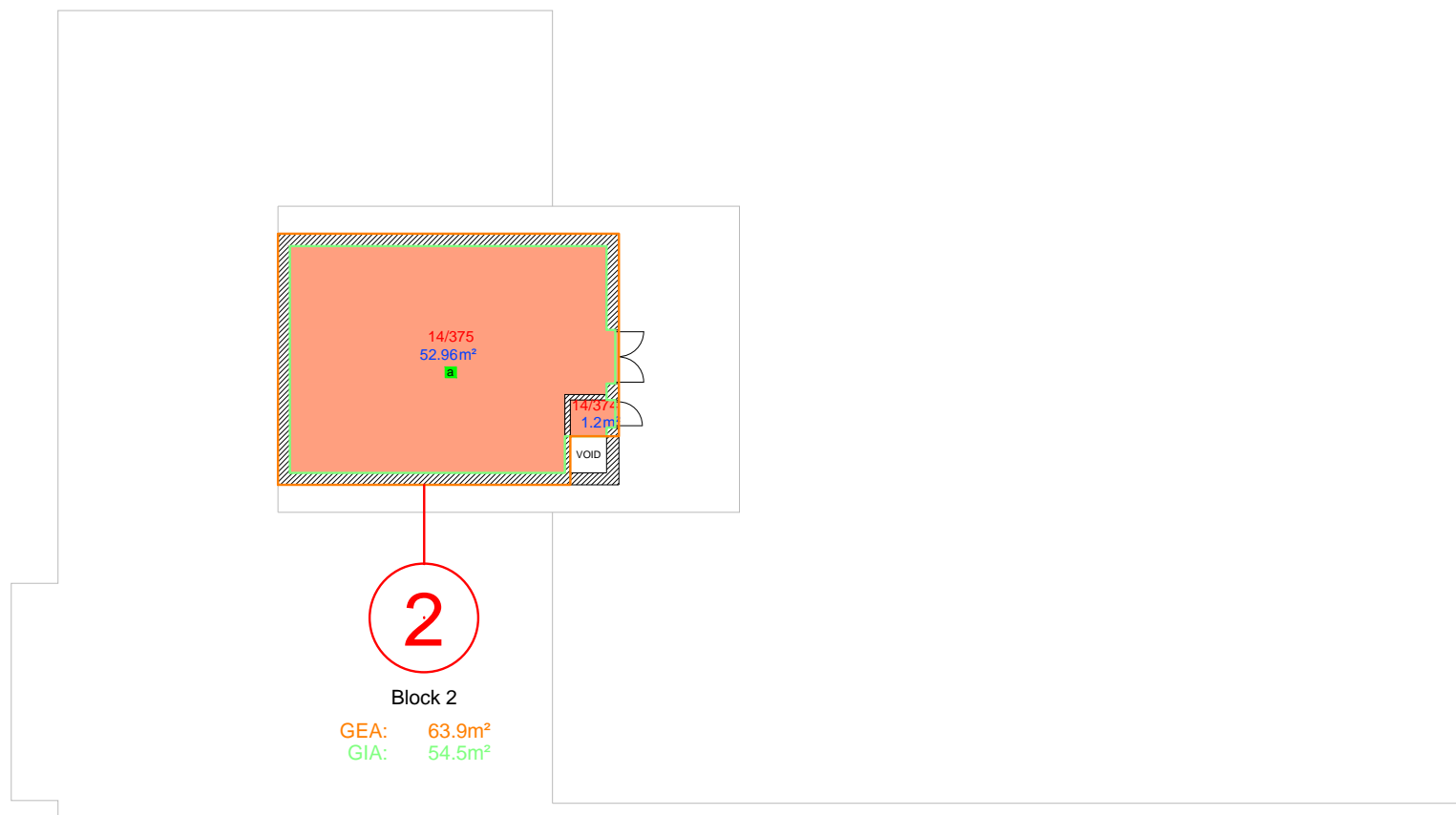

**NPS Humber Limited**, Earle House  
 Colonial Street, Hull, HU2 8JY  
 email: [assetregisterhumber@nps.co.uk](mailto:assetregisterhumber@nps.co.uk)

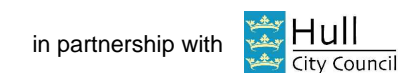

Drawing Number  
 BON008/22 (22 of 23)

UPRN / Property Name  
 BON008 / KINGSTON HOUSE

Scale  
 1:200 @ A3

Date  
 25/02/2015

Ver.	Rev.	Drawn by	Amended by
2.1	L	S - M	K.E.R.



**BLOCK 2, FOURTEENTH FLOOR PLAN**





GENERAL NOTES

This drawing must NOT be scaled  
All dimensions and levels to be checked on site prior to commencement of work on site. Any discrepancies to be reported to the Supervising Officer. This drawing is to be read in conjunction with relevant consultants and specialists drawings

© Crown copyright and database rights [ 2011 ]  
Ordnance Survey [ 100023372 ]

NOTES

-  = Demise of block area
-  = Block reference number
-  = Asbestos sample record available

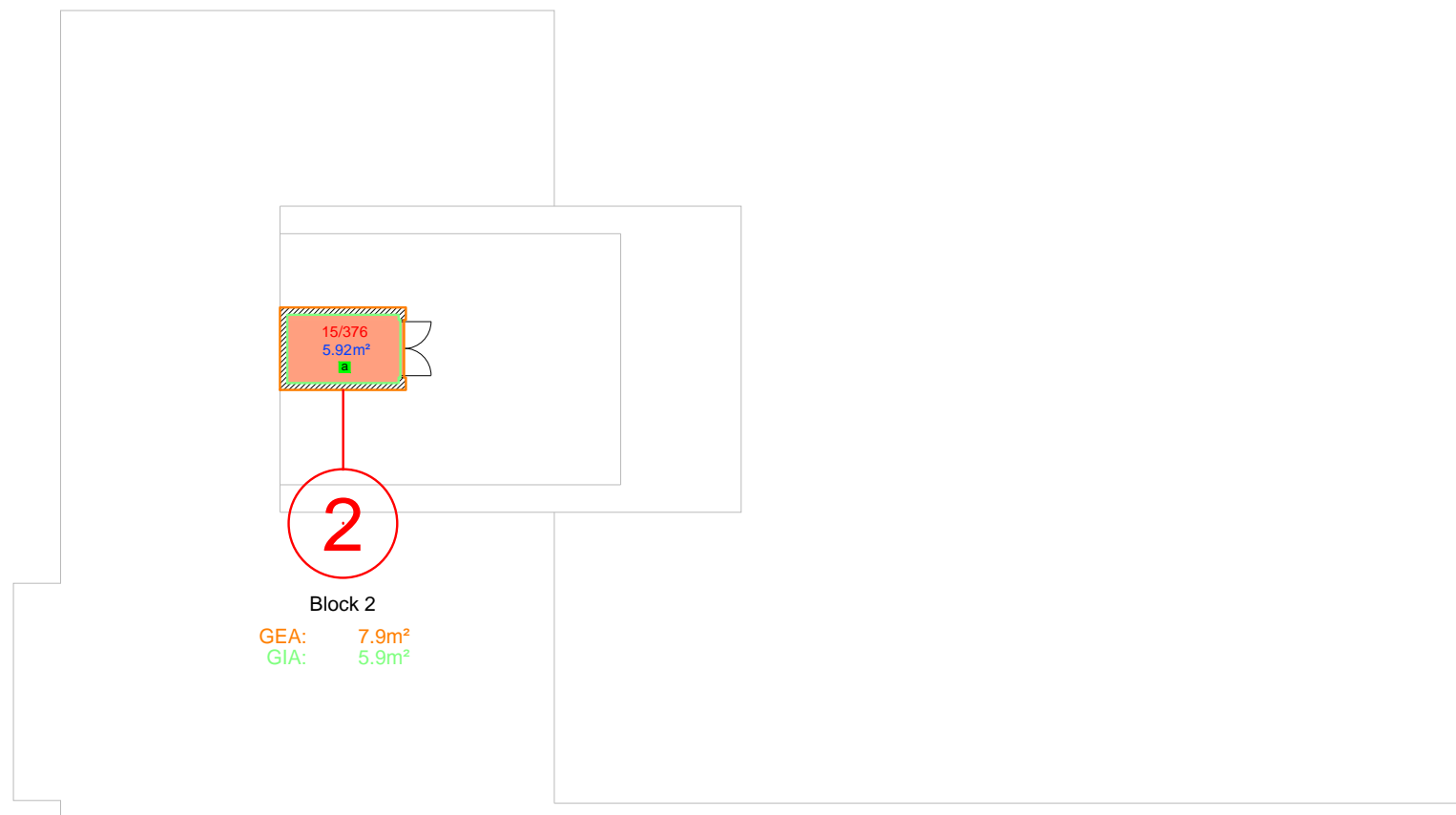

**NPS Humber Limited**, Earle House  
Colonial Street, Hull, HU2 8JY  
*email: [assetregisterhumber@nps.co.uk](mailto:assetregisterhumber@nps.co.uk)*



Drawing Number

BON008/23 (23 of 23)

UPRN / Property Name

BON008 / KINGSTON HOUSE

Scale

1:200 @ A3

Date

25/02/2015

Ver.	Rev.	Drawn by	Amended by
2.1	L	S - M	K.E.R.



BLOCK 2, FIFTEENTH FLOOR PLAN