

# Radio 1 Big Weekend 2017 Burton Constable Hall

**Saturday 27<sup>th</sup> – 28<sup>th</sup> May 2017**

[Transport Operational Plan](#)

*Version 1.2 02/05/2017*

*Prepared by SEP Ltd*



Tracsis<sub>plc</sub>

## Contents

Amendments From V1 .....	1
Amendments From V1.1 .....	1
SECTION 1 - Traffic Management Required .....	2
1.1 - Road Closures .....	2
1.2 - Access Routes for Residents .....	3
1.3 - Route for vehicles without passes that arrive on site and re-routed to park and rides .....	4
1.4 - One way route North to South up until 14:00 .....	5
1.5 - One way Route South to North from 14:30 .....	6
SECTION 2 - Junctions Requiring active traffic control due to increased volumes of traffic .....	7
2.1 - Main St Junction with Grange Rd .....	7
2.2 - A165 Junction with Mullberry Ln .....	8
2.3 - Lambwath Junction with Mullberry Ln .....	9
2.4 - Ouhbrough Ln A165 Junction with Crab Tree Ln .....	10
2.5 - Main Street Junction with Preston Rd .....	11
2.6 - Park Rd – Narrow road section prior to the caravan park .....	12
2.7 - Caravan Park access road .....	13

## Amendments From V1

**PAGE CHANGE**

13	Additional control measure
14	Additional control measure
	Additional wording throughout the document

## Amendments From V1.1

**PAGE CHANGE**

2	Amendments to the map

# SECTION 1 - Traffic Management Required

## 1.1 - Road Closures

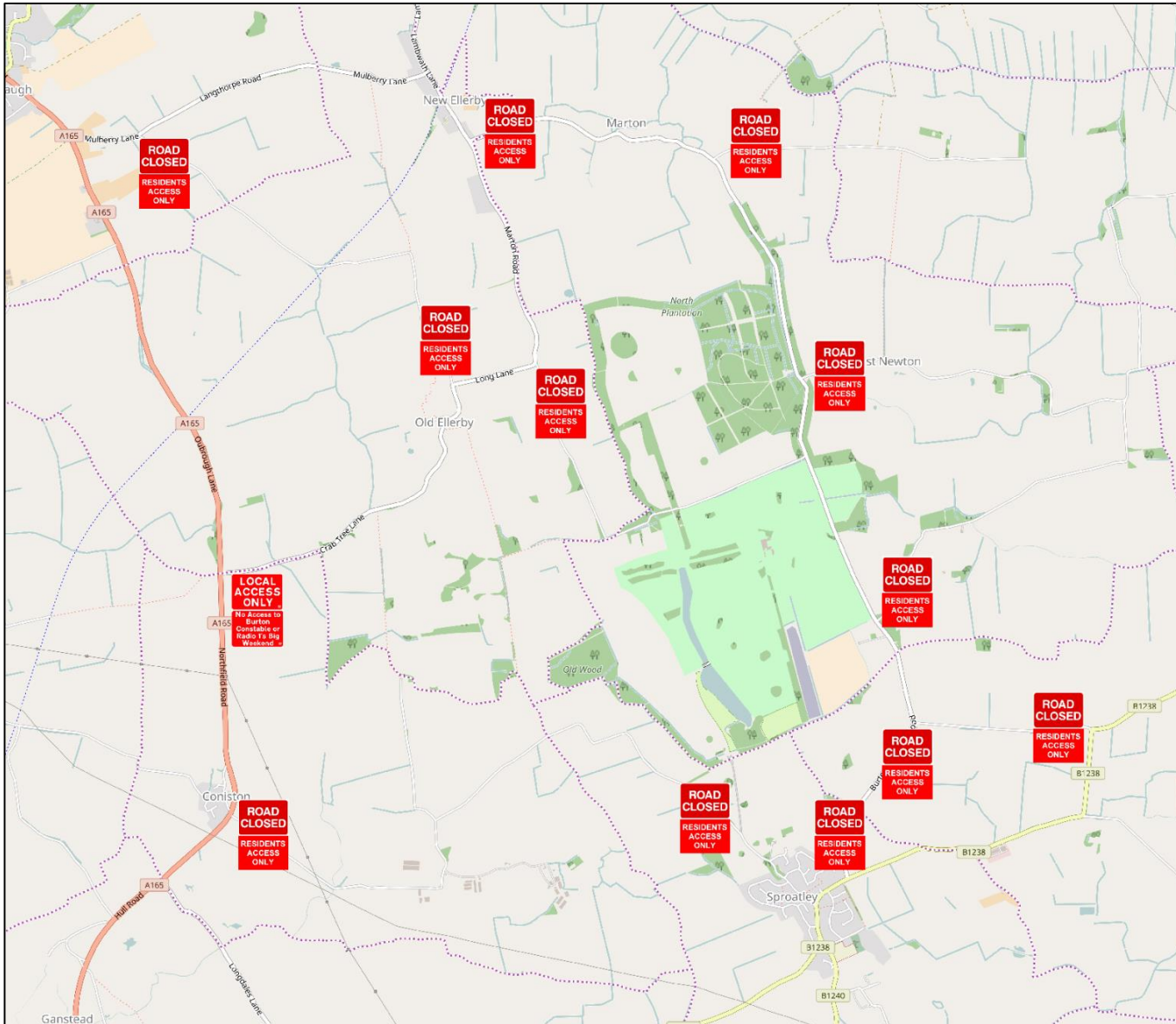

Road Closures to be manned during operational hours. The closures are to be put in place to deter festival goers from trying to park close to the event as there is no onsite parking, and to allow residents to still be able to go about their normal routine, causing as little disruption as possible.

Staff to have detailed briefing on what vehicles are allowed through road closures and in what direction the traffic is flowing (only applicable on the one way, see page 6 & 7). Additionally they will all be briefed to direct any festival goers to the closest park and ride site.

## 1.2 - Access Routes for Residents

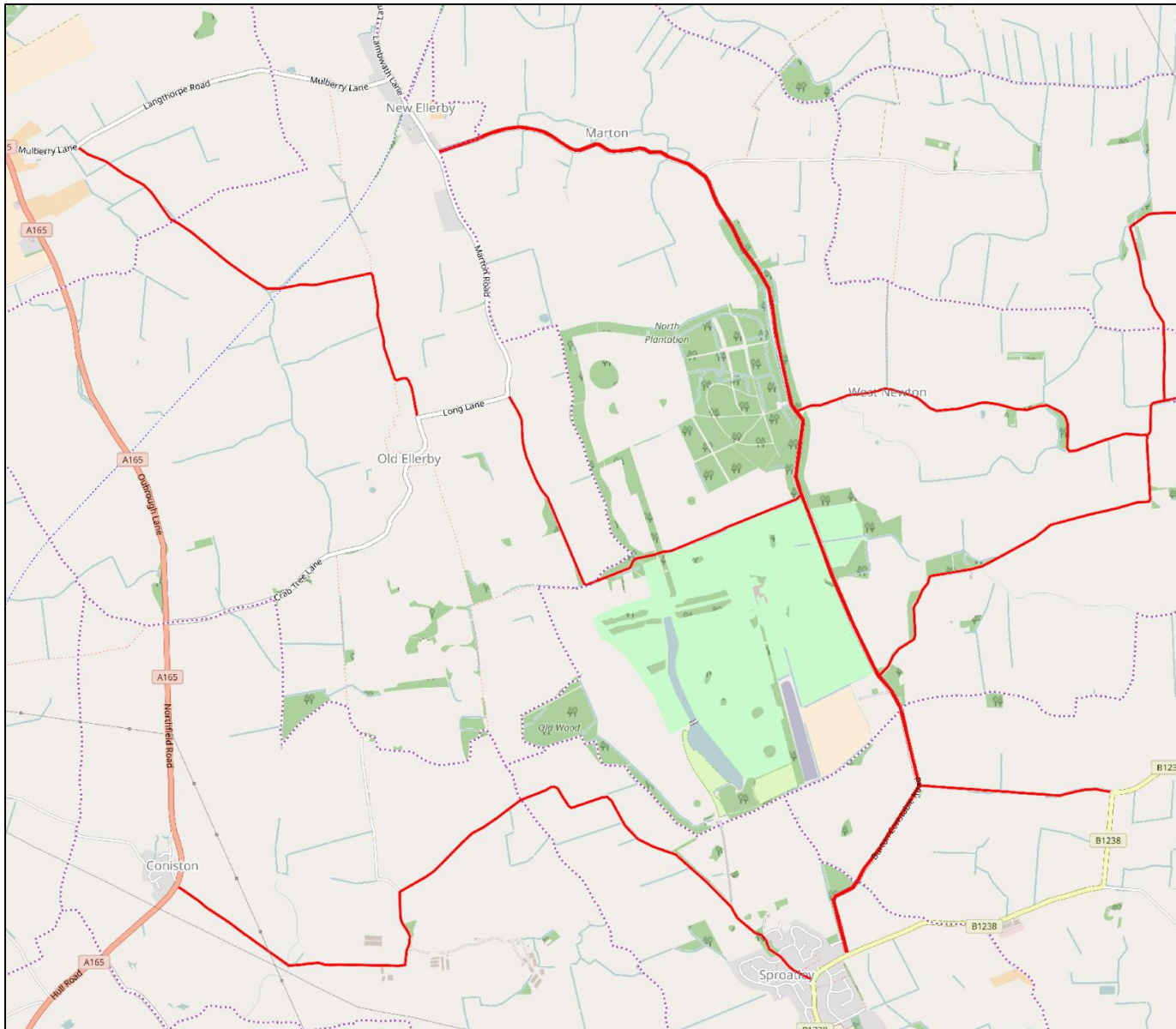

All resident access routes will be manned. Passes will be issued, but where no pass is shown a pragmatic approach will be taken as to whether or not to let a vehicle gain access, if the occupants of the vehicle are clearly not festival goers then they will be allowed.

### 1.3 - Route for vehicles without passes that arrive on site and re-routed to park and rides

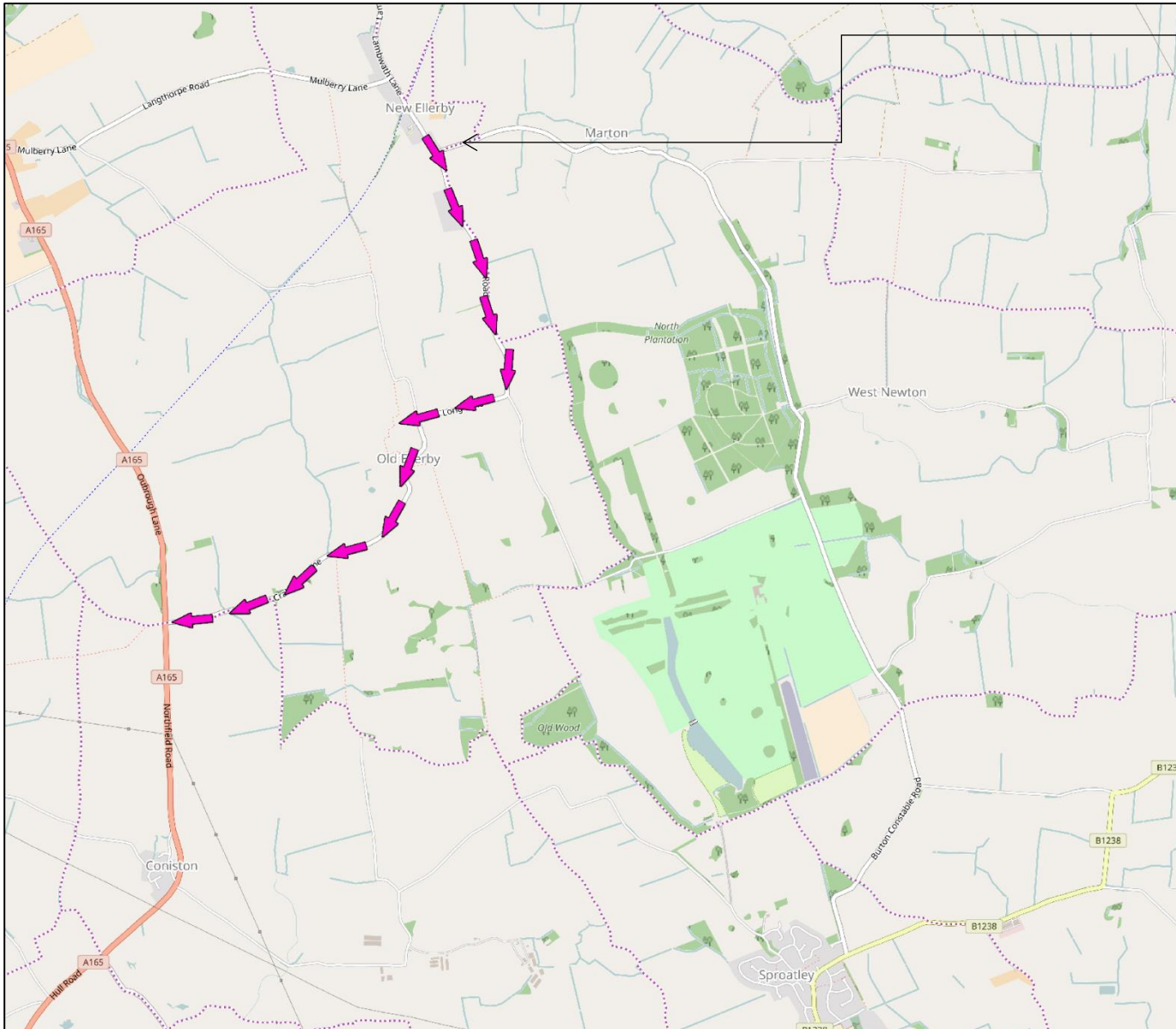

Vehicles that arrive who wish to park or drop off without the correct passes who arrive at the road closure here will be directed to follow the signed route to the closest park and ride.

## 1.4 - One way route North to South up until 14:00

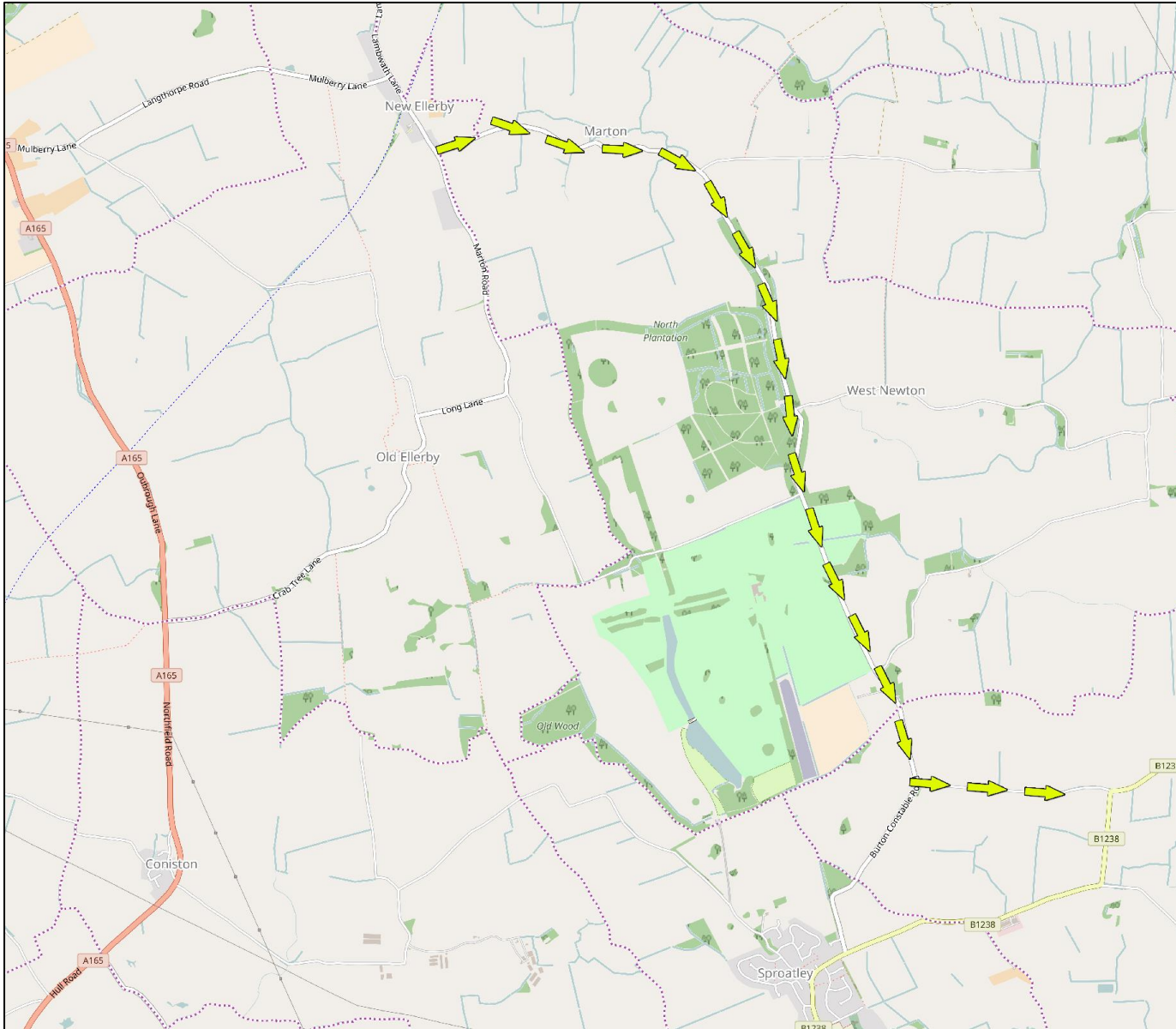

The one way system is to allow vehicles, especially busses to have easier access to the drop of area along what is a narrow road.

During the day between 14:00 and 14:30 the one way system will be reversed to allow for a faster recycling of the buses during egress.

## 1.5 - One way Route South to North from 14:30

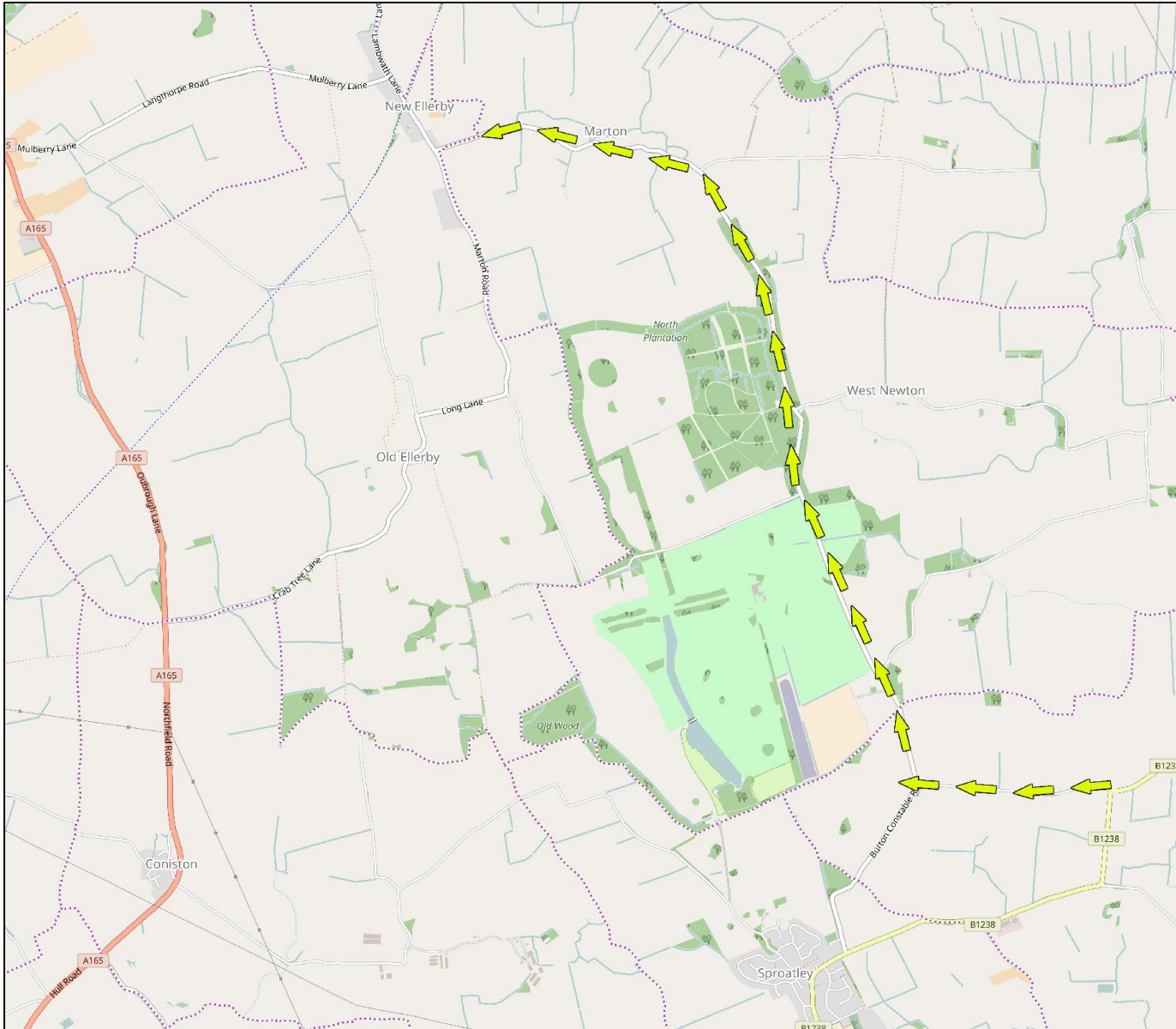

The one way system is to allow vehicles, especially busses to have easier access to the drop of area along what is a narrow road.

During the day between 14:00 and 14:30 the one way system will be reversed to allow for a faster recycling of the buses during egress.



# SECTION 2 - Junctions Requiring active traffic control due to increased volumes of traffic

## 2.1 - Main St Junction with Grange Rd

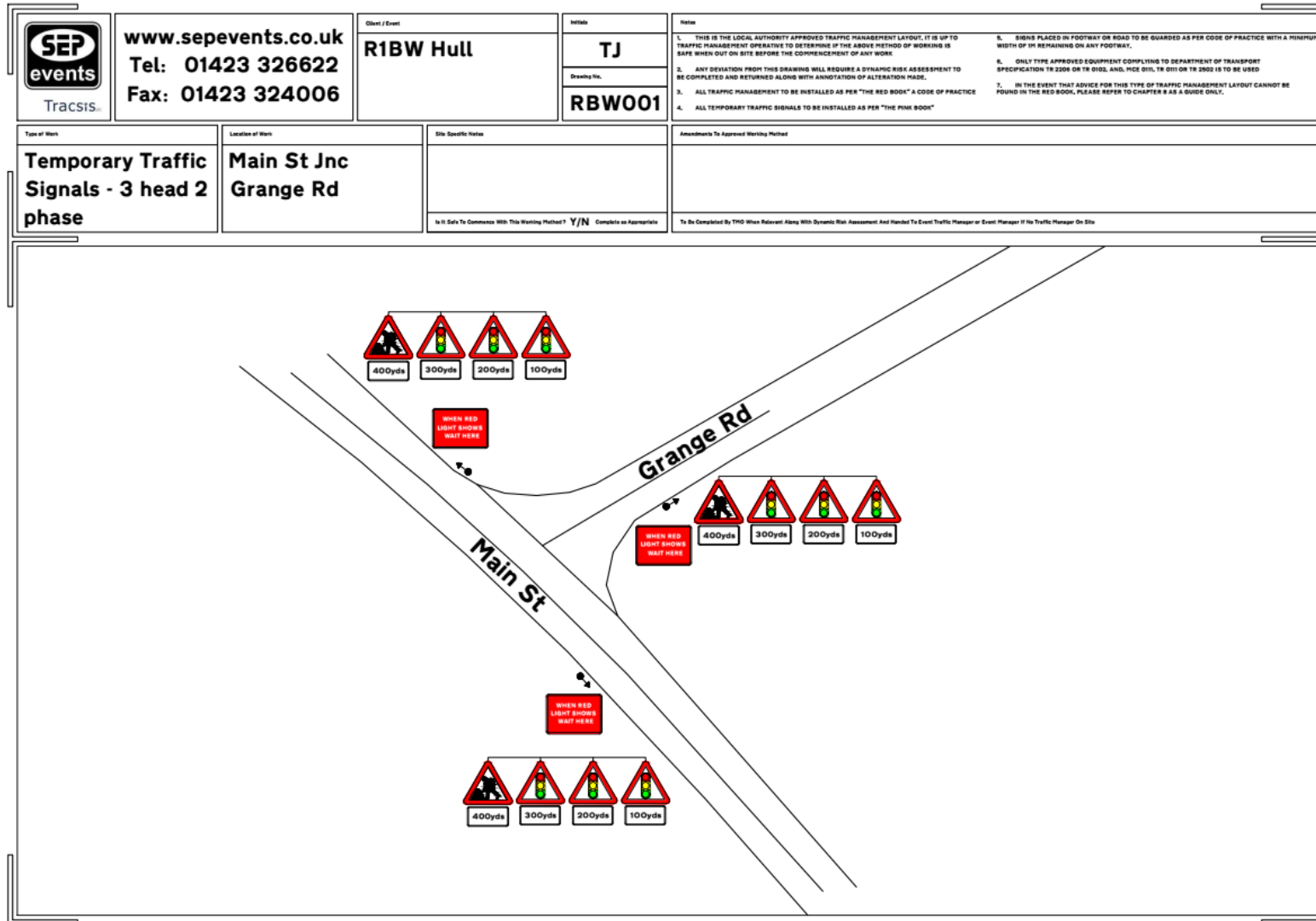

## 2.2 - A165 Junction with Mullberry Ln

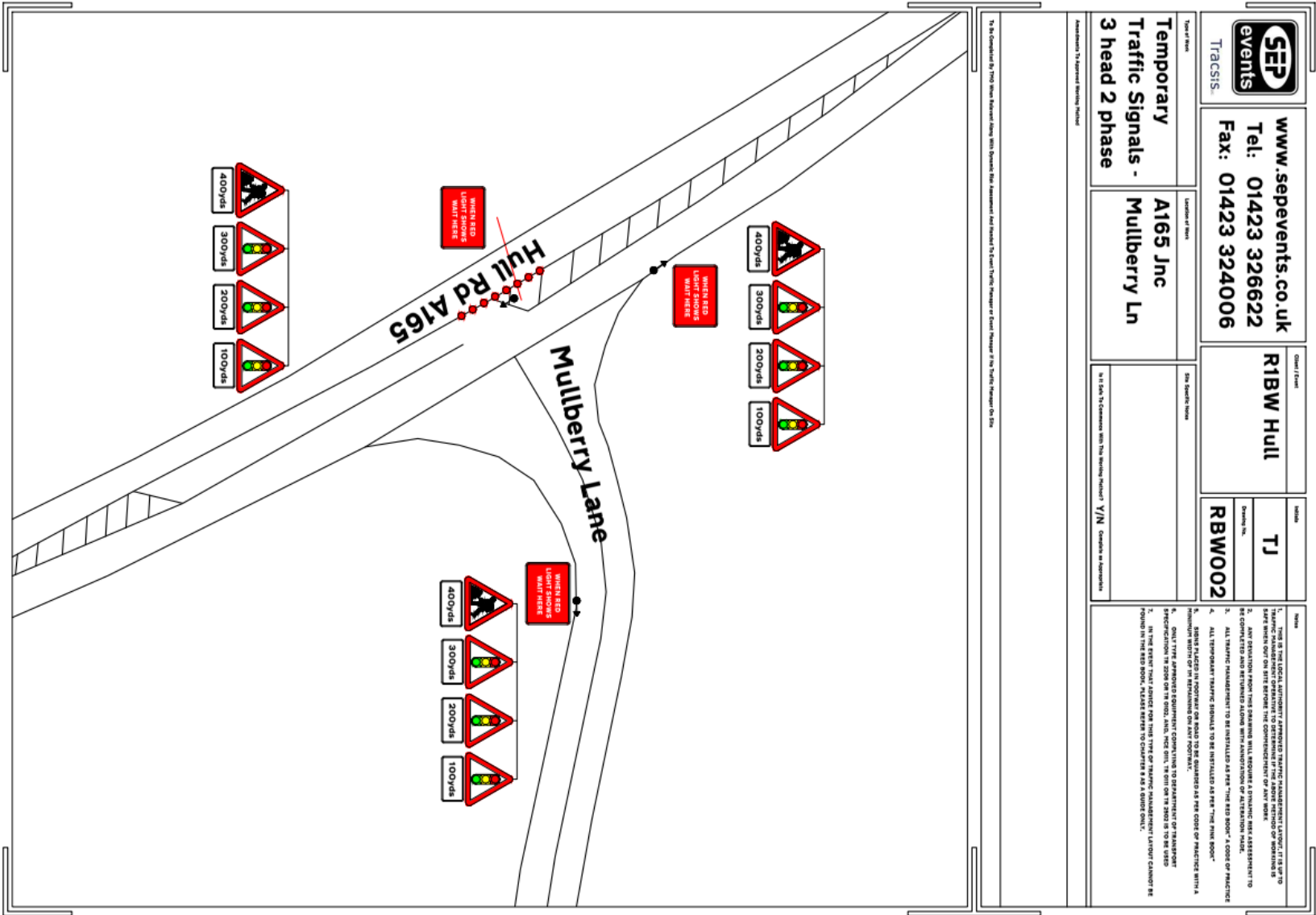

		<b>www.sepevents.co.uk</b> <b>Tel: 01423 326622</b> <b>Fax: 01423 324006</b>		<b>RIBW Hull</b>		<b>TJ</b>	
<b>Temporary Traffic Signals - 3 head 2 phase</b>		<b>A165 Jnc Mullberry Ln</b>		Site Specific Notes		<b>RBW002</b>	
Approved by Transport Planning Director		Approved by 1st Command into The National Police V/N. Complete as appropriate		Notes		Notes	
To Be Completed By: 1700 (Date Released) Along With: 1700 (Date Released) This Assessment And Incident 7/1 (Start Traffic) Manager or Road Manager if No Traffic Manager On Site				<ol style="list-style-type: none"> <li>1. THIS IS THE LOCAL AUTHORITY'S APPROVED TRAFFIC MANAGEMENT PLAN. IT IS TO BE COMPLETED BY THE LOCAL AUTHORITY'S TRAFFIC MANAGEMENT TEAM. IT IS TO BE COMPLETED ON SITE BEFORE THE COMMENCEMENT OF ANY WORK.</li> <li>2. ANY DEVIATION FROM THIS PLAN WILL REQUIRE A DYNAMIC RISK ASSESSMENT TO BE COMPLETED AND RETURNED ALONG WITH ANNOTATION OF ALTERATION MADE.</li> <li>3. ALL TRAFFIC MANAGEMENT TO BE INSTALLED AS PER "THE RED BOOK" A COPY OF PRACTICE</li> <li>4. ALL TEMPORARY TRAFFIC SIGNALS TO BE INSTALLED AS PER "THE RED BOOK"</li> <li>5. SIGNING PLACED IN FRONT OF OR AHEAD TO BE QUANTIFIED AS PER CODE OF PRACTICE WITH A MINIMUM WIDTH OF 10 METRES ON ANY FOOTWAY.</li> <li>6. ONLY THE APPROVED EQUIPMENT CONSULTING TO DEPARTMENT OF TRANSPORT SPECIFICATION IS TO BE USED. ALSO, THE SIGN ON THE ROAD IS TO BE USED</li> <li>7. IN THE EVENT THAT ANY OF THIS TYPE OF TRAFFIC MANAGEMENT LAID OUT CANNOT BE FOUND IN THE RED BOOK, PLEASE REFER TO CHAPTER 8 AND 9 ONLY.</li> </ol>			

## 2.3 - Lambwath Junction with Mullberry Ln

	<p><b>www.sepevents.co.uk</b>  <b>Tel: 01423 326622</b>  <b>Fax: 01423 324006</b></p>	<p><b>Client / Title</b>  <b>R1BW Hull</b></p>	<p><b>Notes</b></p> <p>THIS IS THE LOCAL AUTHORITY APPROVED TRAFFIC MANAGEMENT LAYOUT. IT IS UP TO TRAFFIC MANAGEMENT OPERATIVE TO DETERMINE IF THE ABOVE METHOD OF WORKING IS FEASIBLE ON THE DATE AND TIME OF THE WORK. THE LOCAL AUTHORITY HAS AGREED TO BE CONTACTED AND RETURNED ALONG WITH APPROVISION OF ALTERNATION MARKS.</p> <p>1. ALL TRAFFIC MANAGEMENT TO BE INSTALLED AS PER THE RED BOOK* A CODE OF PRACTICE</p> <p>2. ALL TEMPORARY TRAFFIC SIGNALS TO BE INSTALLED AS PER THE RED BOOK*</p> <p>3. ALL TEMPORARY TRAFFIC SIGNALS TO BE INSTALLED AS PER THE RED BOOK*</p> <p>4. ALL TEMPORARY TRAFFIC SIGNALS TO BE INSTALLED AS PER THE RED BOOK*</p> <p>5. ALL TEMPORARY TRAFFIC SIGNALS TO BE INSTALLED AS PER THE RED BOOK*</p> <p>6. ALL TEMPORARY TRAFFIC SIGNALS TO BE INSTALLED AS PER THE RED BOOK*</p> <p>7. IN THE EVENT THAT AGENCY FOR THIS TYPE OF TRAFFIC MANAGEMENT LAYOUT CANNOT BE FOUND IN THE RED BOOK, PLEASE REFER TO CHAPTER 8 AS A GUIDE ONLY.</p>
<p><b>Temporary Traffic Signals - 3 head 3 phase</b></p>		<p><b>Location of work</b>  <b>Lambwath Jnc Mullberry Ln</b></p>	
<p><b>Site Specific Notes</b></p>		<p><b>Notes</b></p>	
<p><small>To Be Completed By Third Party Approved Agency With Signature And Date/Time And Printed By Client / Title Holder or Client Designer or Site Agent Approved By Site</small></p>			

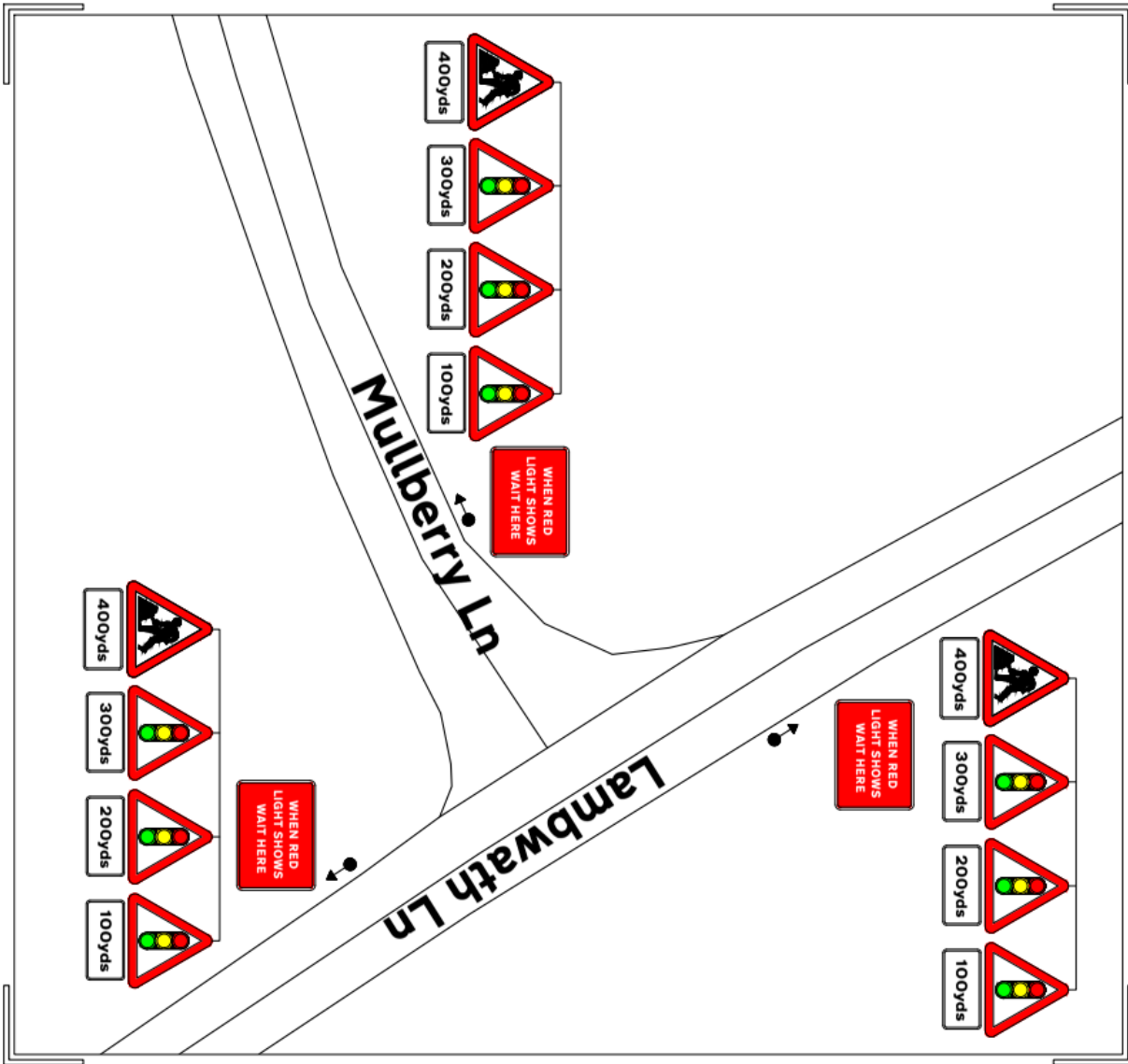
## 2.4 - Ouhbrough Ln A165 Junction with Crab Tree Ln

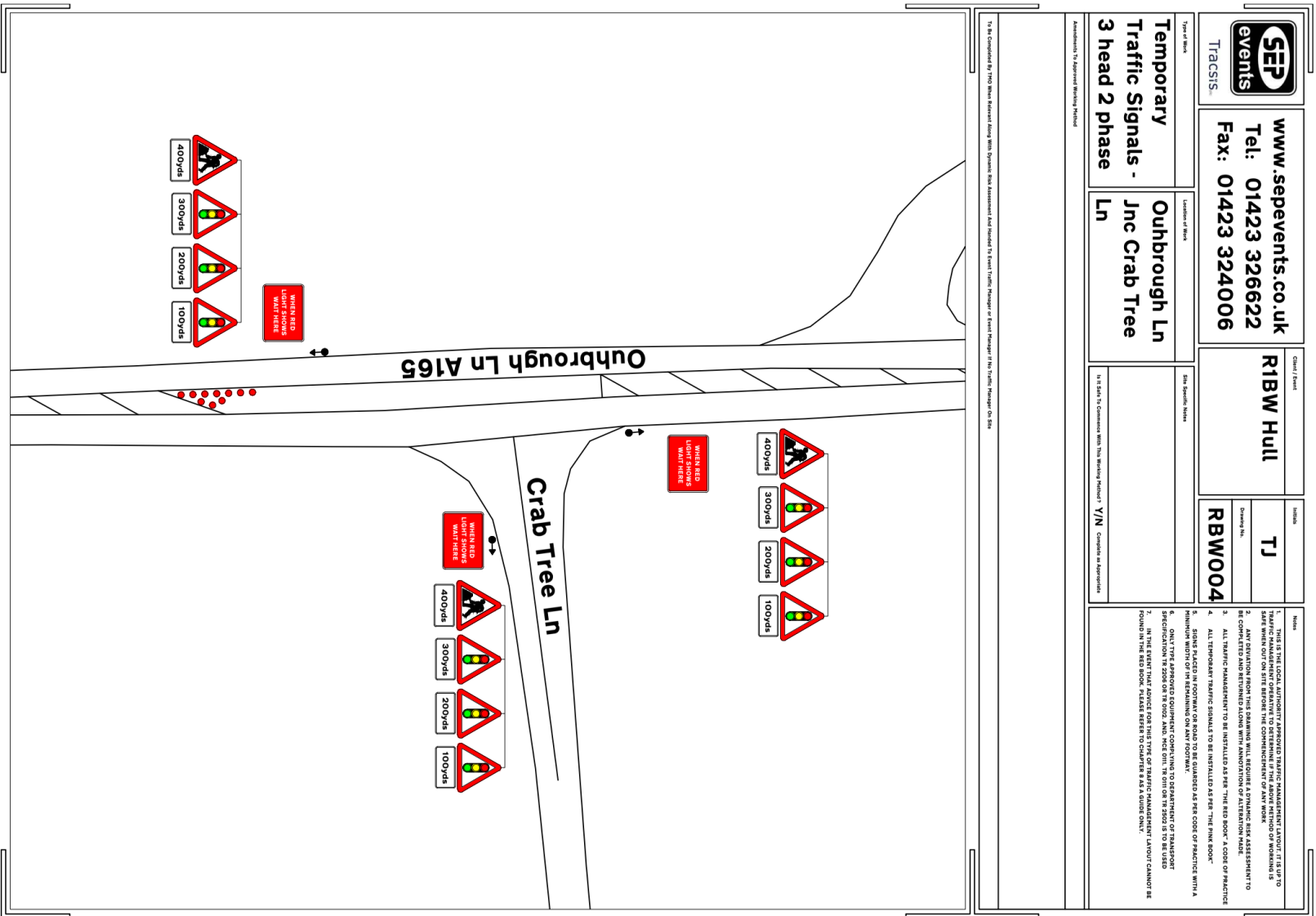

## 2.5 - Main Street Junction with Preston Rd

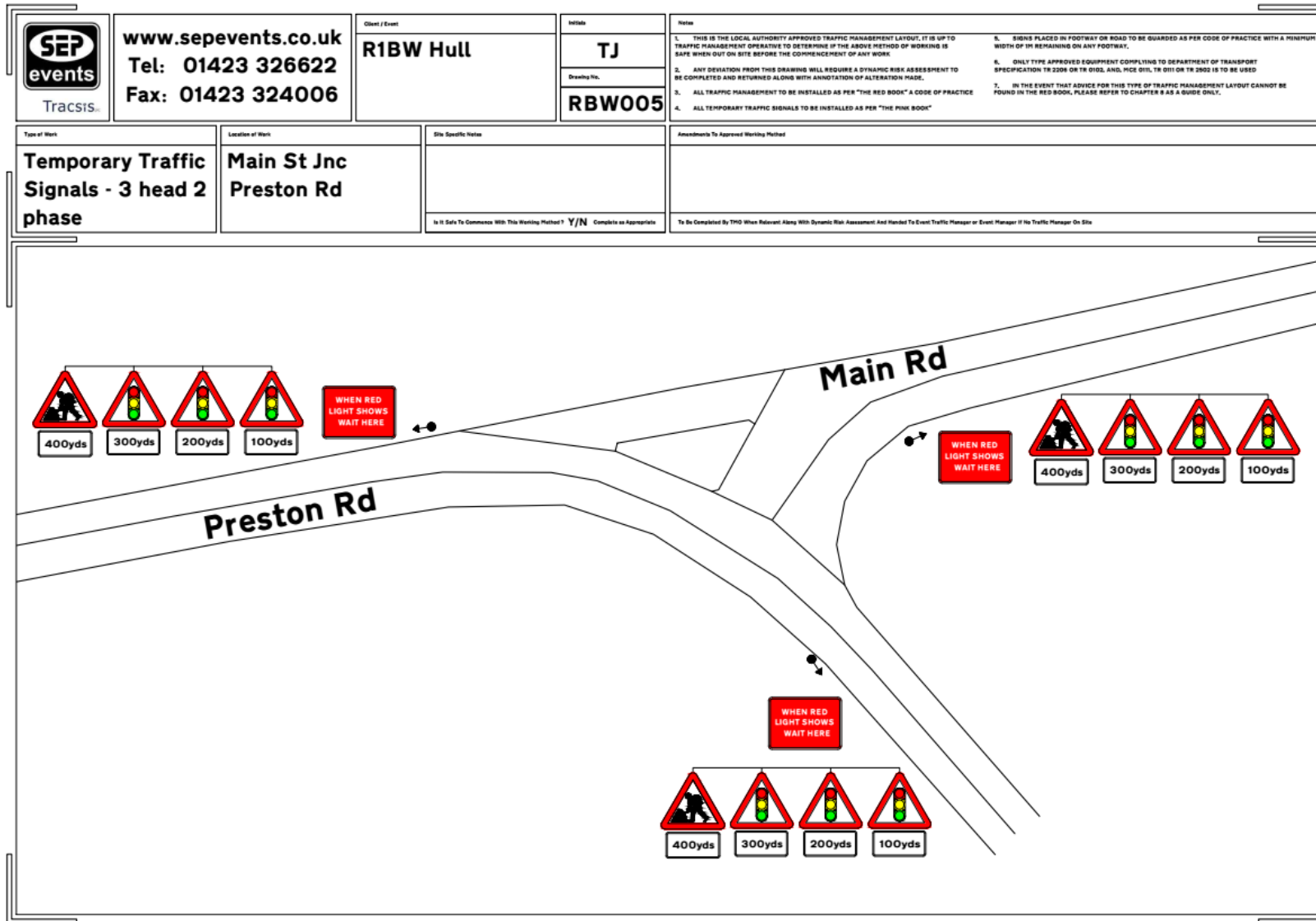

## 2.6 - Park Rd – Narrow road section prior to the caravan park

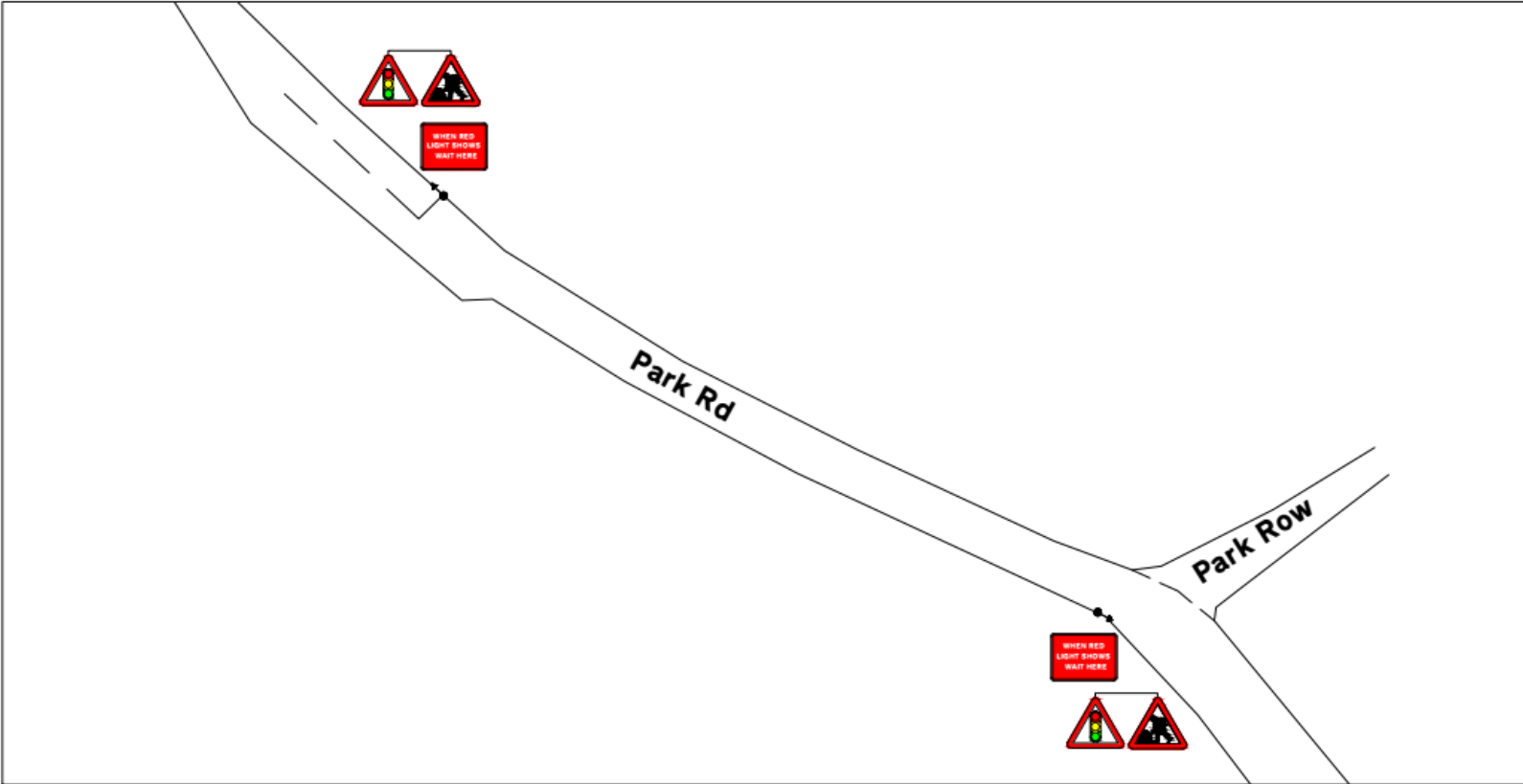
		<b>www.sepevents.co.uk</b> <b>Tel: 01423 326622</b> <b>Fax: 01423 324006</b>		<b>Client / Event</b> <b>R1BW Hull</b>	<b>Mobile</b> <b>TJ</b>	<b>Notes</b> 1. THIS IS THE LOCAL AUTHORITY APPROVED TRAFFIC MANAGEMENT LAYOUT. IT IS UP TO TRAFFIC MANAGEMENT OPERATIVE TO DETERMINE IF THE ABOVE METHOD OF WORKING IS SAFE WHEN OUT ON SITE BEFORE THE COMMENCEMENT OF ANY WORK. 2. ANY DEVIATION FROM THIS DRAWING WILL REQUIRE A DYNAMIC RISK ASSESSMENT TO BE COMPLETED AND RETURNED ALONG WITH ANNOTATION OF ALTERATION MADE. 3. ALL TRAFFIC MANAGEMENT TO BE INSTALLED AS PER "THE RED BOOK" A CODE OF PRACTICE 4. ALL TEMPORARY TRAFFIC SIGNALS TO BE INSTALLED AS PER "THE PINK BOOK" 5. SIGNS PLACED IN FOOTWAY OR ROAD TO BE GUARDED AS PER CODE OF PRACTICE WITH A MINIMUM WIDTH OF 1M REMAINING ON ANY FOOTWAY. 6. ONLY TYPE APPROVED EQUIPMENT COMPLYING TO DEPARTMENT OF TRANSPORT SPECIFICATION TR 2006 OR TR 2002, AND, HCE 091, TR 091 OR TR 2002 IS TO BE USED 7. IN THE EVENT THAT ADVICE FOR THIS TYPE OF TRAFFIC MANAGEMENT LAYOUT CANNOT BE FOUND IN THE RED BOOK, PLEASE REFER TO CHAPTER 8 AS A GUIDE ONLY.
				<b>Drawing No.</b> <b>RBW006</b>		
<b>Type of Work</b> <b>Temporary Traffic Signals - 2 head 2 phase</b>	<b>Location of Work</b> <b>Park Rd - Narrow section of road</b>	<b>Site Specific Notes</b> <b>Will need to be worked in conjunction with drawing RBW007 to allow vehicles to leave the holiday park</b> <small>Is It Safe To Commence With This Working Method? Y/N Complete as Appropriate</small>		<b>Amendments To Approved Working Method</b> <small>To Be Completed By TMO When Relevant Along With Dynamic Risk Assessment And Handled To Event Traffic Manager or Event Manager If No Traffic Manager On Site</small>		
						

## 2.7 - Caravan Park access road

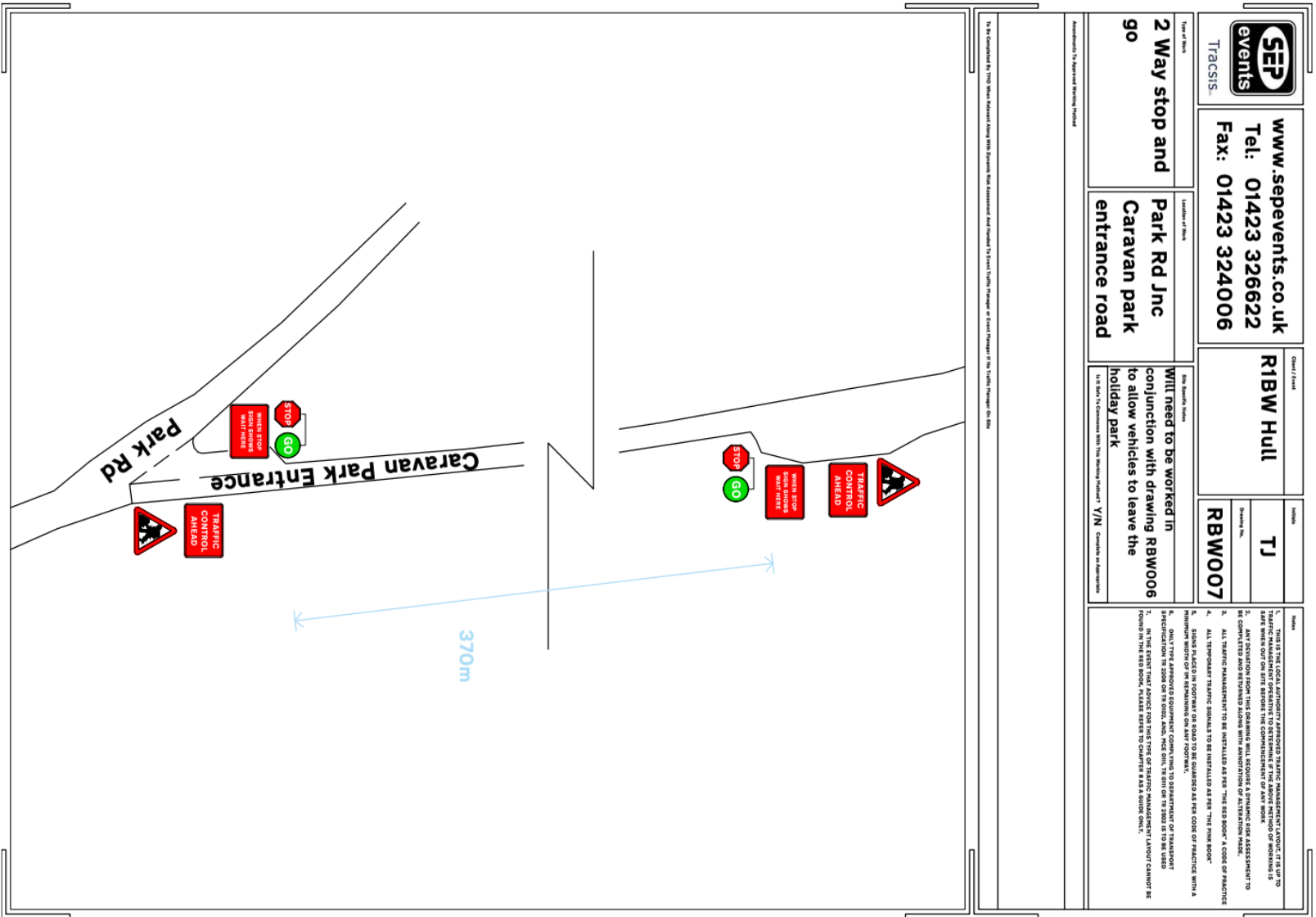

SEP  
events  
Tracsis

www.sepevents.co.uk  
Tel: 01423 326622  
Fax: 01423 324006

2 Way stop and go  
Park Rd Jnc  
Caravan park  
entrance road

RIBW Hull  
TJ  
RBW007

Will need to be worked in conjunction with drawing RBW006 to allow vehicles to leave the holiday park

1. THIS IS THE LOCAL AUTHORITY APPROVED TRAFFIC MANAGEMENT LAYOUT. IT IS UP TO TRAFFIC MANAGEMENT OPERATORS TO DETERMINE IF THE ABOVE METHOD OF WORKING IS SUITABLE FOR THE EVENT. THE LOCAL AUTHORITY WILL NOT BE RESPONSIBLE FOR ANY DAMAGE TO BE COMPLETED AND RETURNED ALONG WITH AMENDMENT OF ATTENTION MARKS.

2. ALL TRAFFIC MANAGEMENT TO BE INSTALLED AS PER "THE RED BOOK" A CODE OF PRACTICE

3. ALL TEMPORARY TRAFFIC SIGNALS TO BE INSTALLED AS PER "THE BLUE BOOK"

4. ALL TEMPORARY TRAFFIC SIGNALS TO BE INSTALLED AS PER "THE BLUE BOOK"

5. ONLY TYPE APPROVED EQUIPMENT ONLY TO BE USED FOR TRAFFIC MANAGEMENT OPERATIONS. EQUIPMENT MUST BE SPECIFICATION TO 2008 OR TO 2008, AND, MUST ONLY BE USED IN 2008 TO BE USED IN THE EVENT THAT ADVICE FOR THIS TYPE OF TRAFFIC MANAGEMENT LAYOUT CANNOT BE FOUND IN THE RED BOOK, PLEASE REFER TO CHAPTER 8 AS A GUIDE ONLY.