

A1
1
2
3
4
5
6
7
8
9
10
11

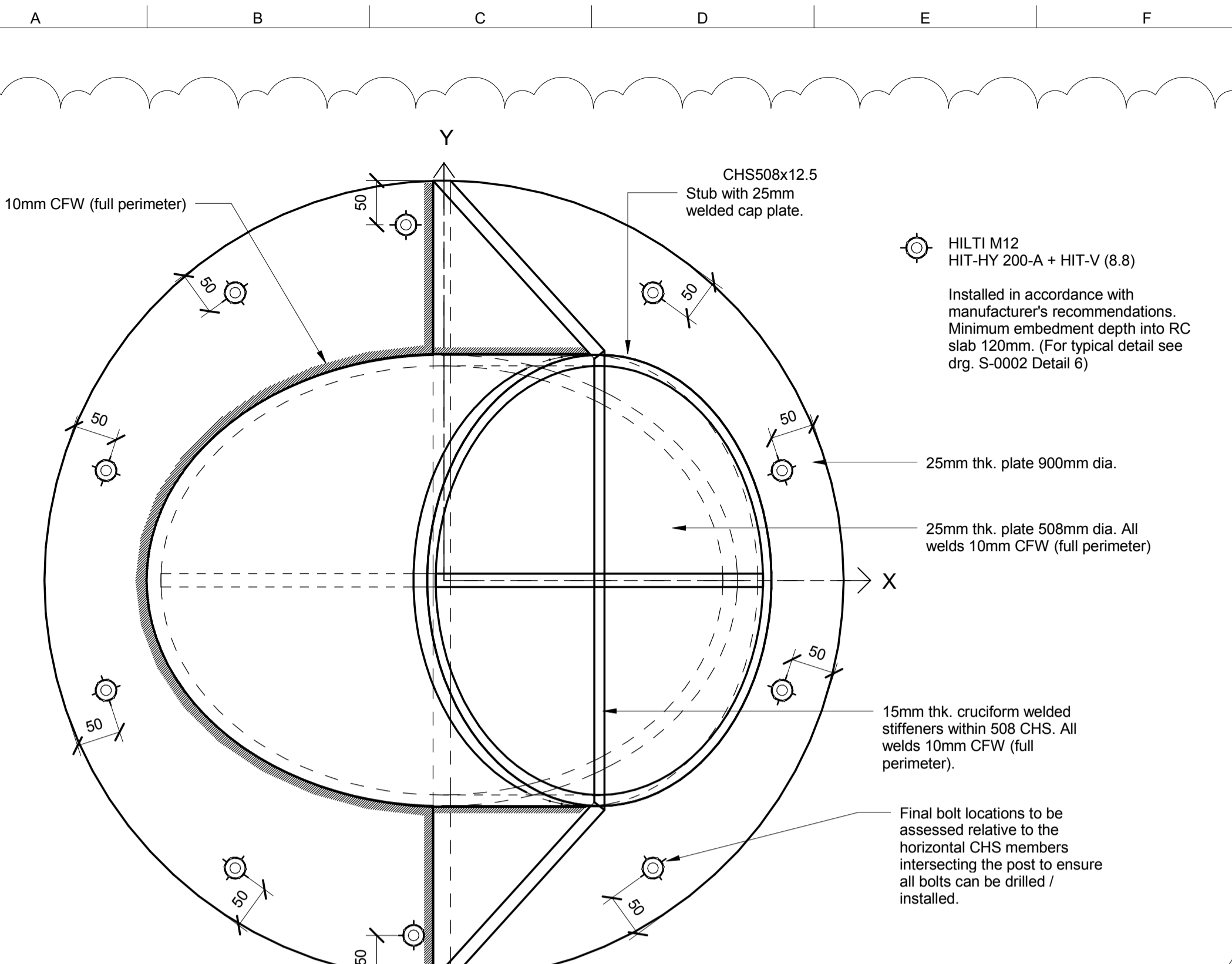

1 Base Plate Detail - Tip Support
1:5

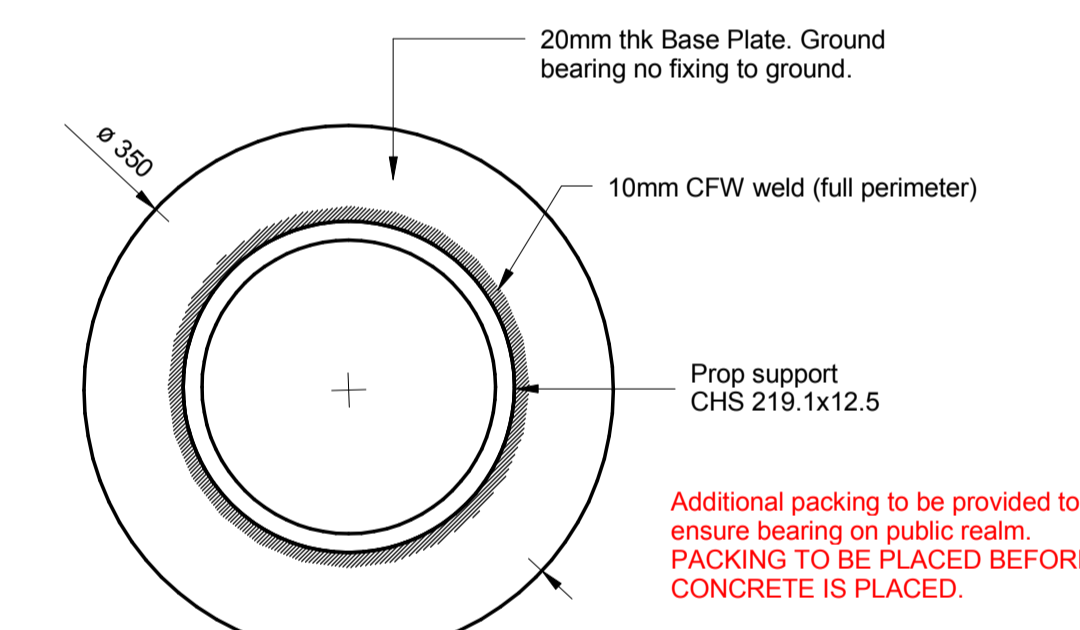

9 Prop Base Plate
1:5

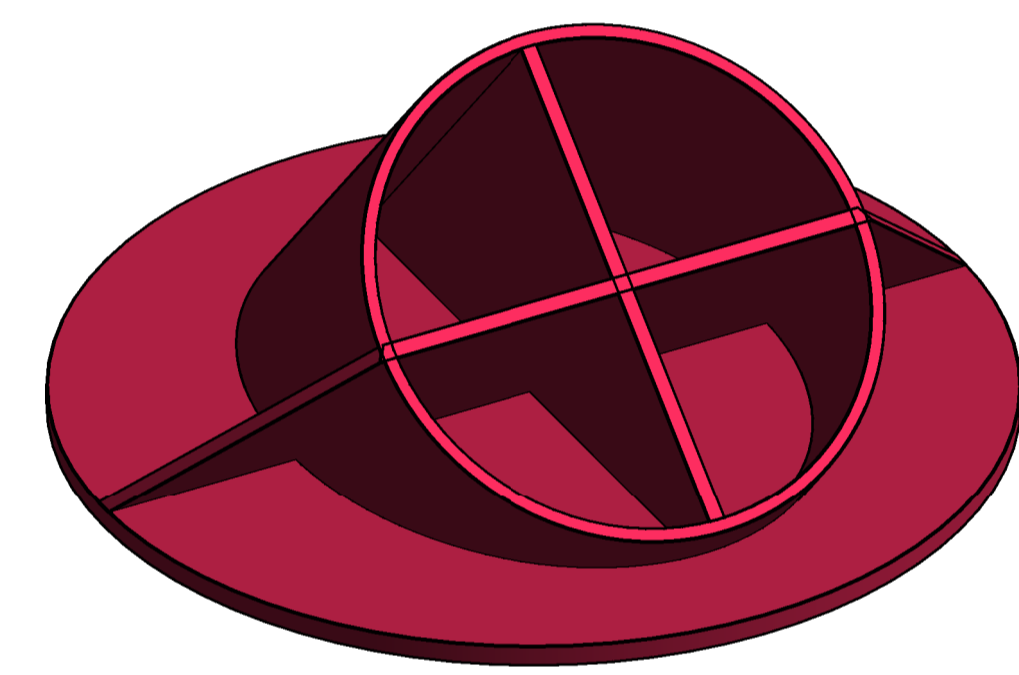

10 Isometric View

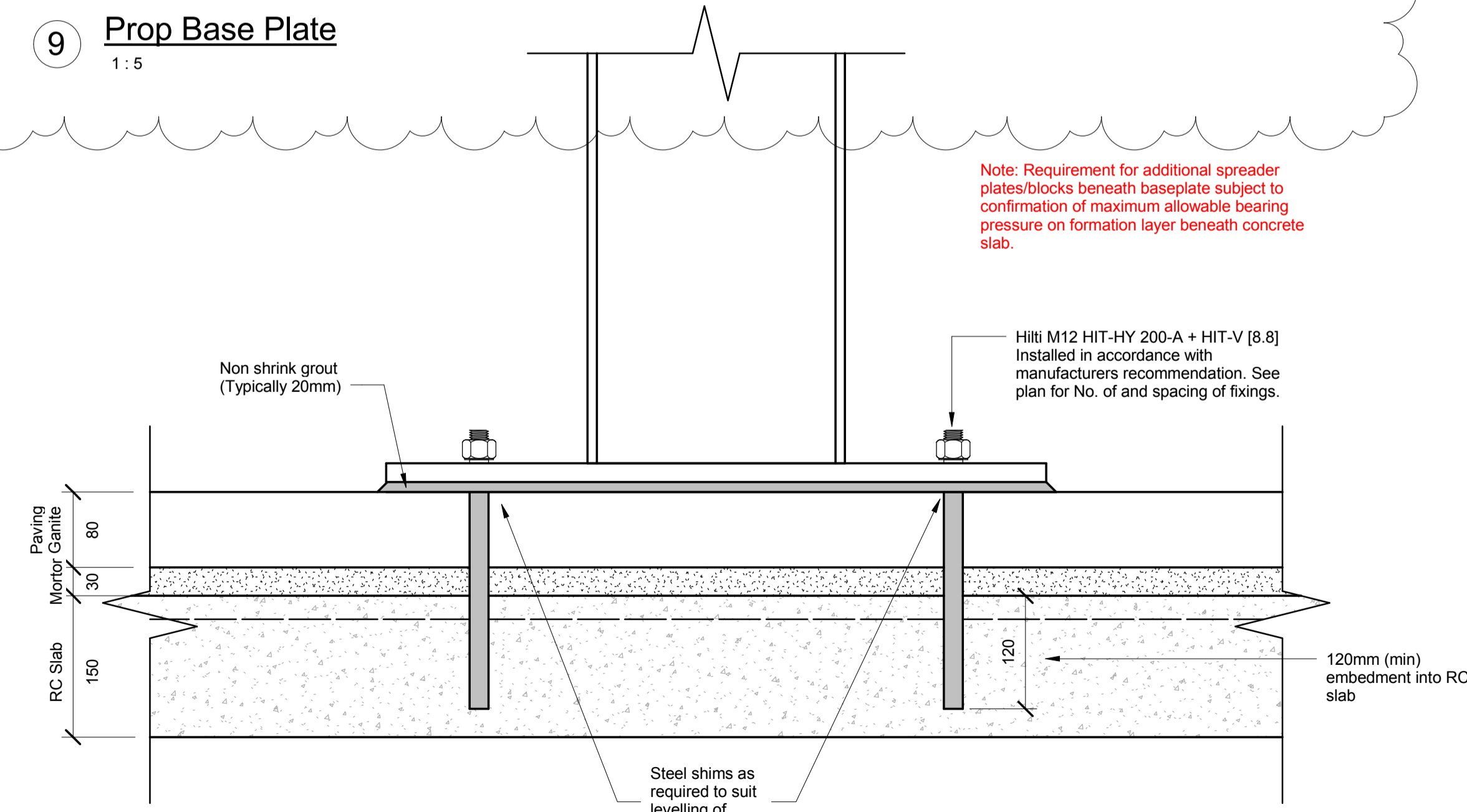

6 Typical Base Fixing Detail
1:5

4 Concrete Precast Planks Plan View
1:50

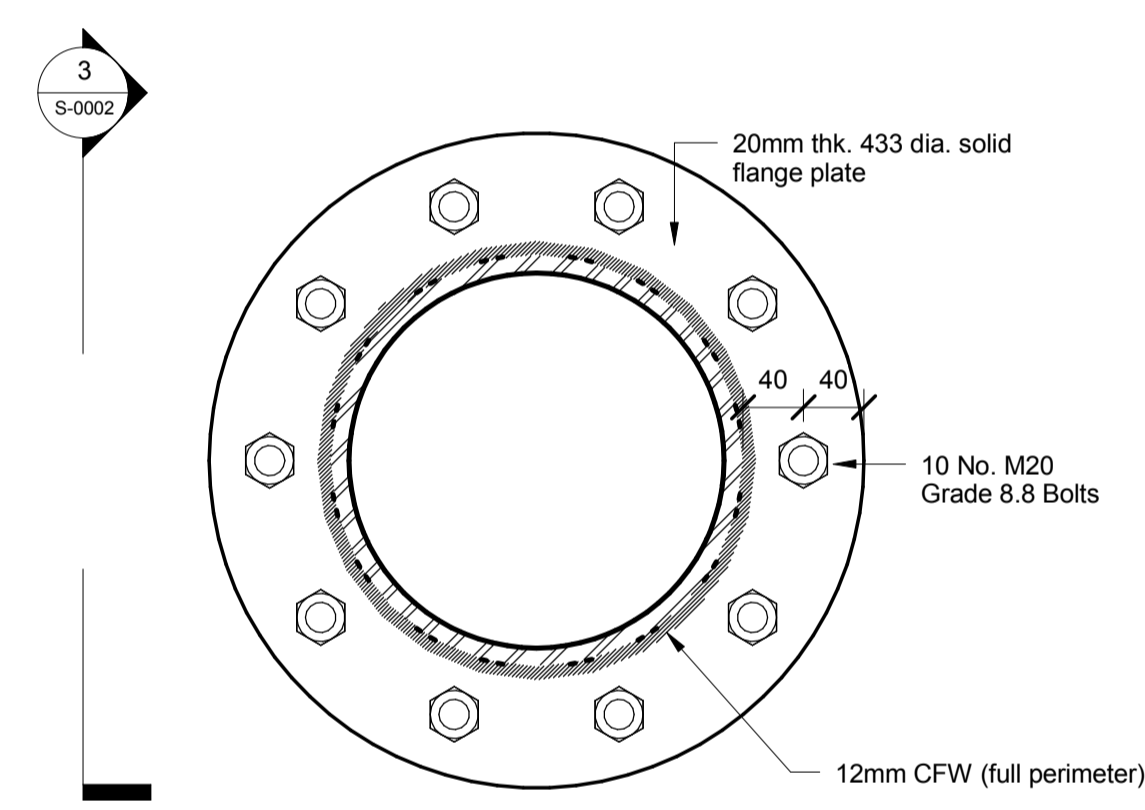
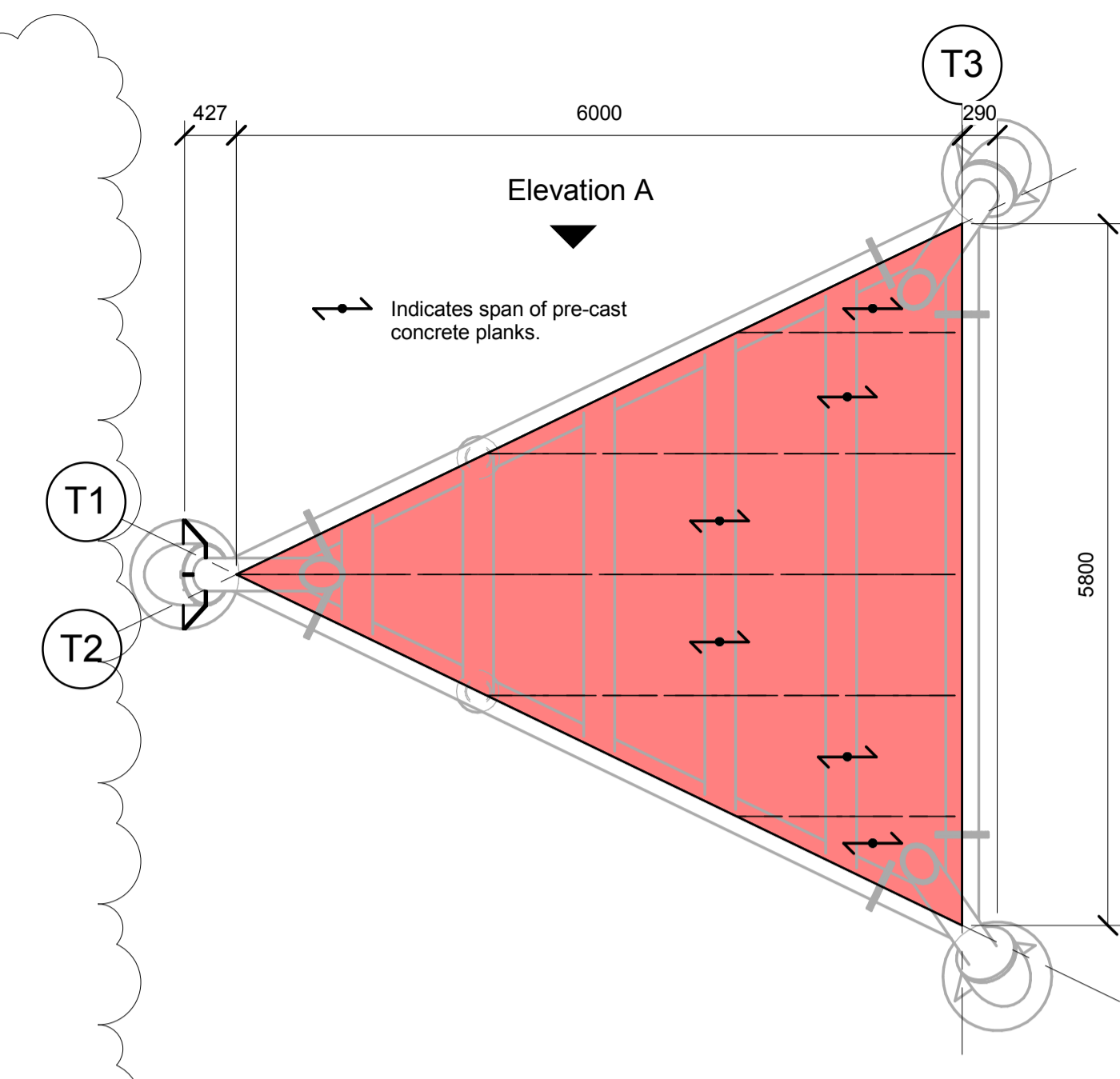

2 Splice Connection A Section 1
1:5

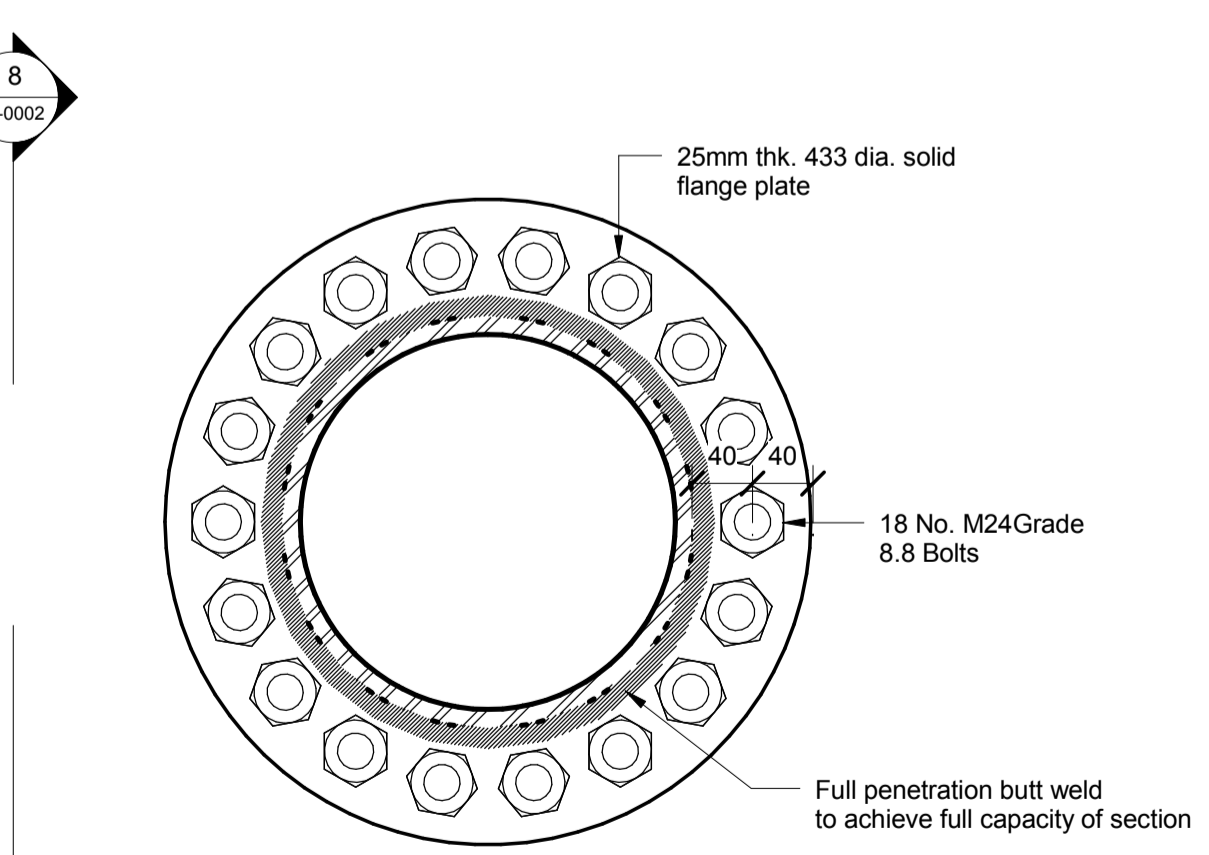

7 Splice Connection B Section 1
1:5

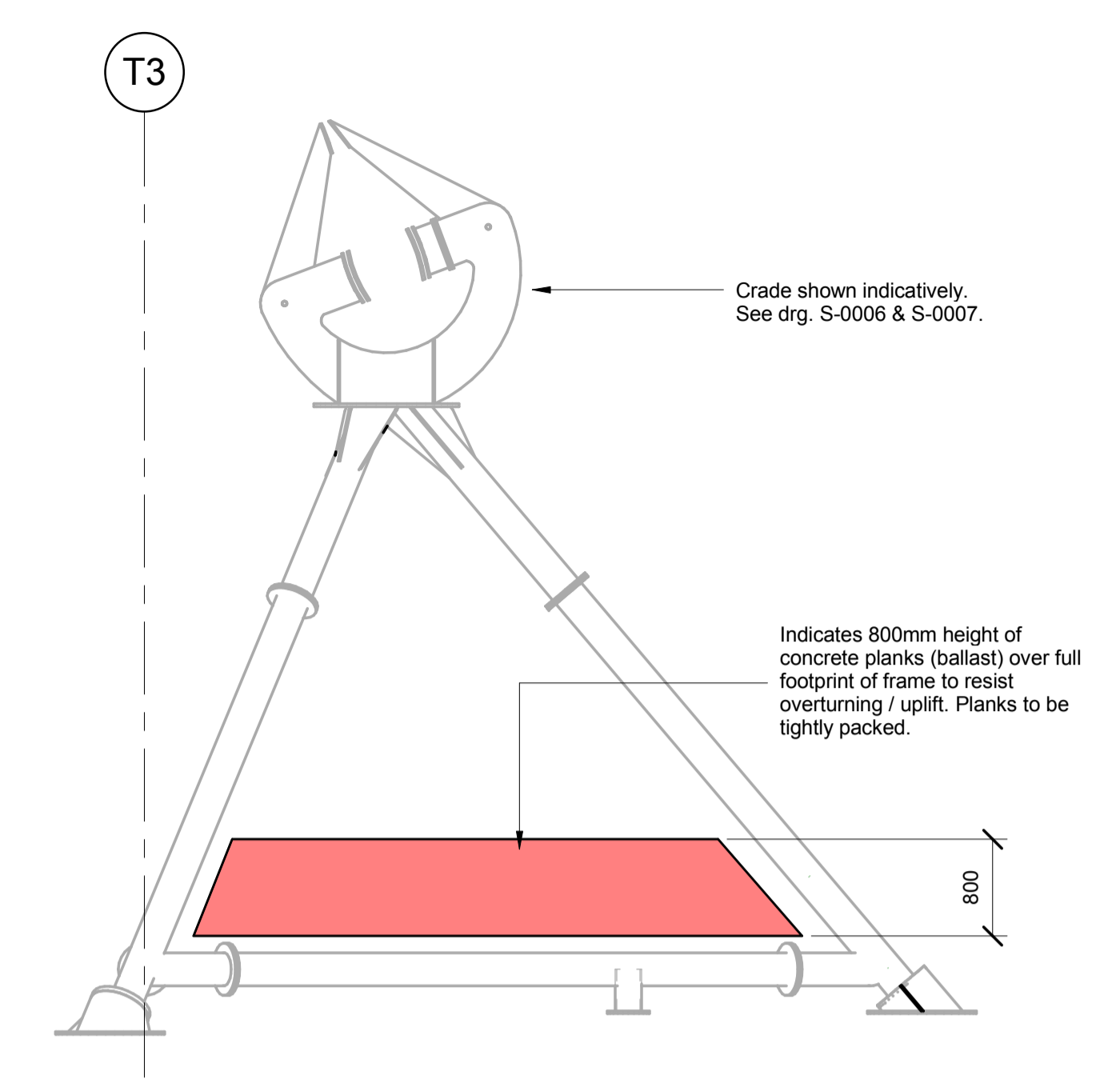

5 Elevation A
1:50

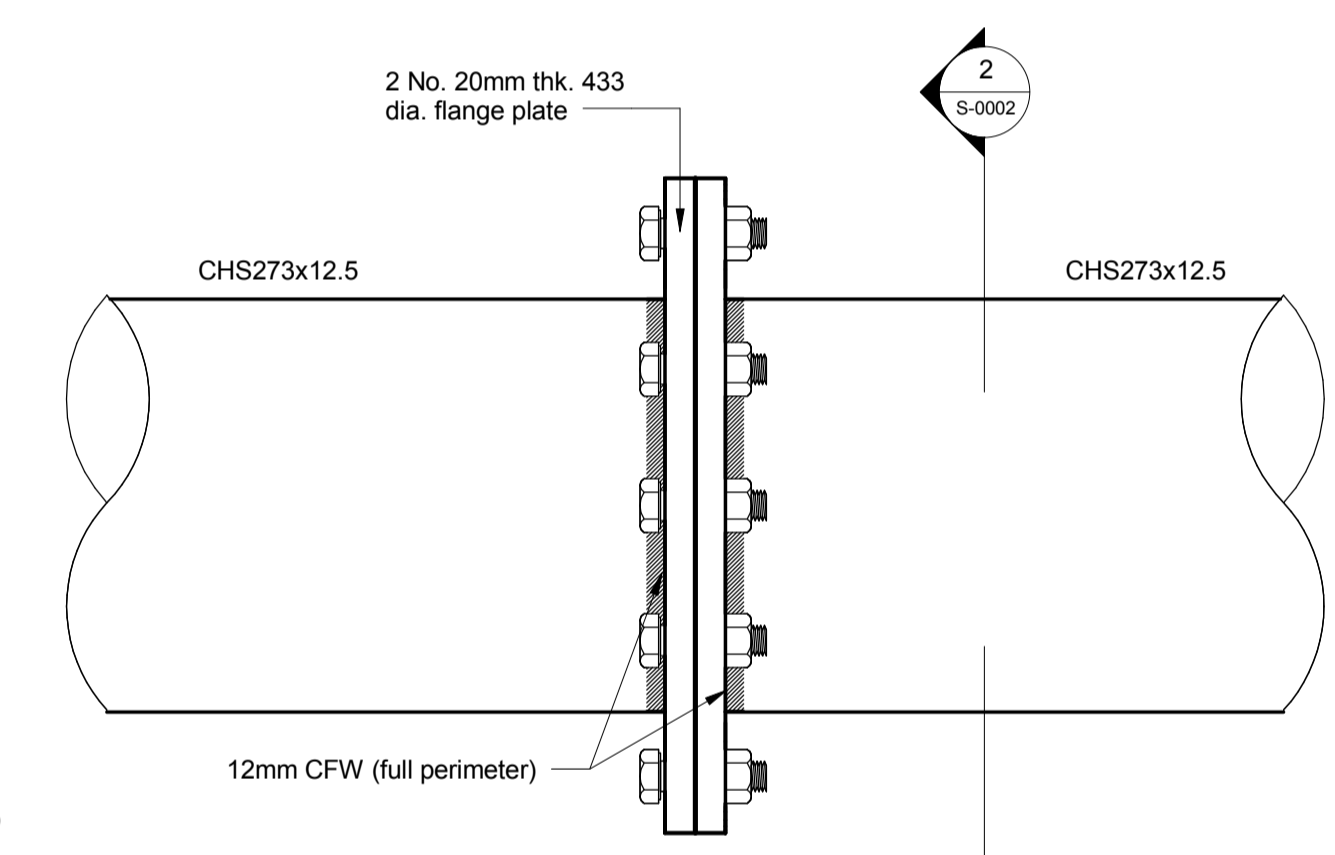

3 Splice Connection A Section 2
1:5

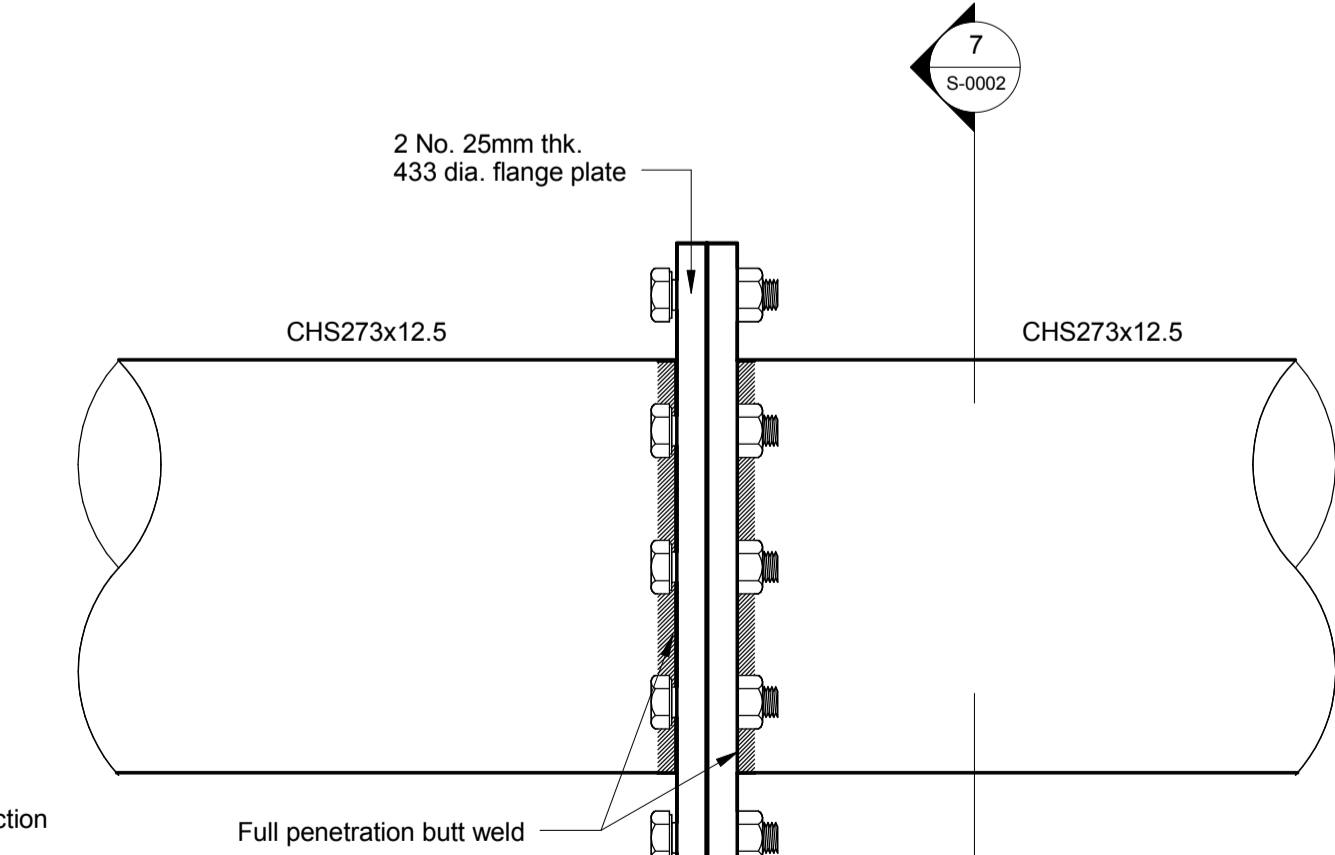

8 Splice Connection B Section 2
1:5

- Notes:
1. Refer to General Notes drawing S-0000
 2. All Steel to be hot rolled S355 J0
 3. CHS to CHS connections to be full strength welded connections. Weld to achieve full capacity of section. Full penetration butt welds or similar.
 4. All bolts to be M20 Grade 8.8 unless noted otherwise.
 5. Refer to typical details for weld requirements. No welds to be less than 6mm CFW.

C3	02/12/16	DE	DS	MMcG
Issued for Construction				
C2	25/11/16	DE	DS	MMcG
Issued for Construction				
C1	22/11/16	DE	DS	MMcG
Issued for Construction				
Rev	Date	By	Chkd	Appd

ARUP

Admiral House Rose Wharf
75 East Street, Leeds, LS9 9EE
Tel+44(113) 242 8498 Fax+44(113)242 8573
www.arup.com

Client
Hull UK City of Culture 2017

Project Title
Hull Zephyr

Drawing Title
**Blade Tip Tripod
Sheet 2 of 2**

Scale at A1	As indicated
Role	Structural
Suitability	Construction
Arup Job No	249697
Name	BLADE-ARUP-XX-XX-DR-S-0002
Rev	C3