

Radio 1 Big Weekend 2017 Burton Constable Hall

Saturday 27th – 28th May 2017

Transport Operational Plan

Version 1.1 02/05/2017

Prepared by SEP Ltd



Tracsis_{plc}

Contents

Amendments From V1	1
SECTION 1 - Traffic Management Required	2
1.1 - Road Closures	2
1.2 - Access Routes for Residents	3
1.3 - Route for vehicles without passes that arrive on site and re-routed to park and rides	4
1.4 - One way route North to South up until 14:00	5
1.5 - One way Route South to North from 14:30	6
SECTION 2 - Junctions Requiring active traffic control due to increased volumes of traffic	7
2.1 - Main St Junction with Grange Rd	7
2.2 - A165 Junction with Mullberry Ln	8
2.3 - Lambwath Junction with Mullberry Ln	9
2.4 - Ouhbrough Ln A165 Junction with Crab Tree Ln	10
2.5 - Main Street Junction with Preston Rd	11
2.6 - Park Rd – Narrow road section prior to the caravan park	12
2.7 - Caravan Park access road	13

Amendments From V1

PAGE CHANGE

PAGE	CHANGE
13	Additional control measure
14	Additional control measure
	Additional wording throughout the document

SECTION 1 - Traffic Management Required

1.1 - Road Closures

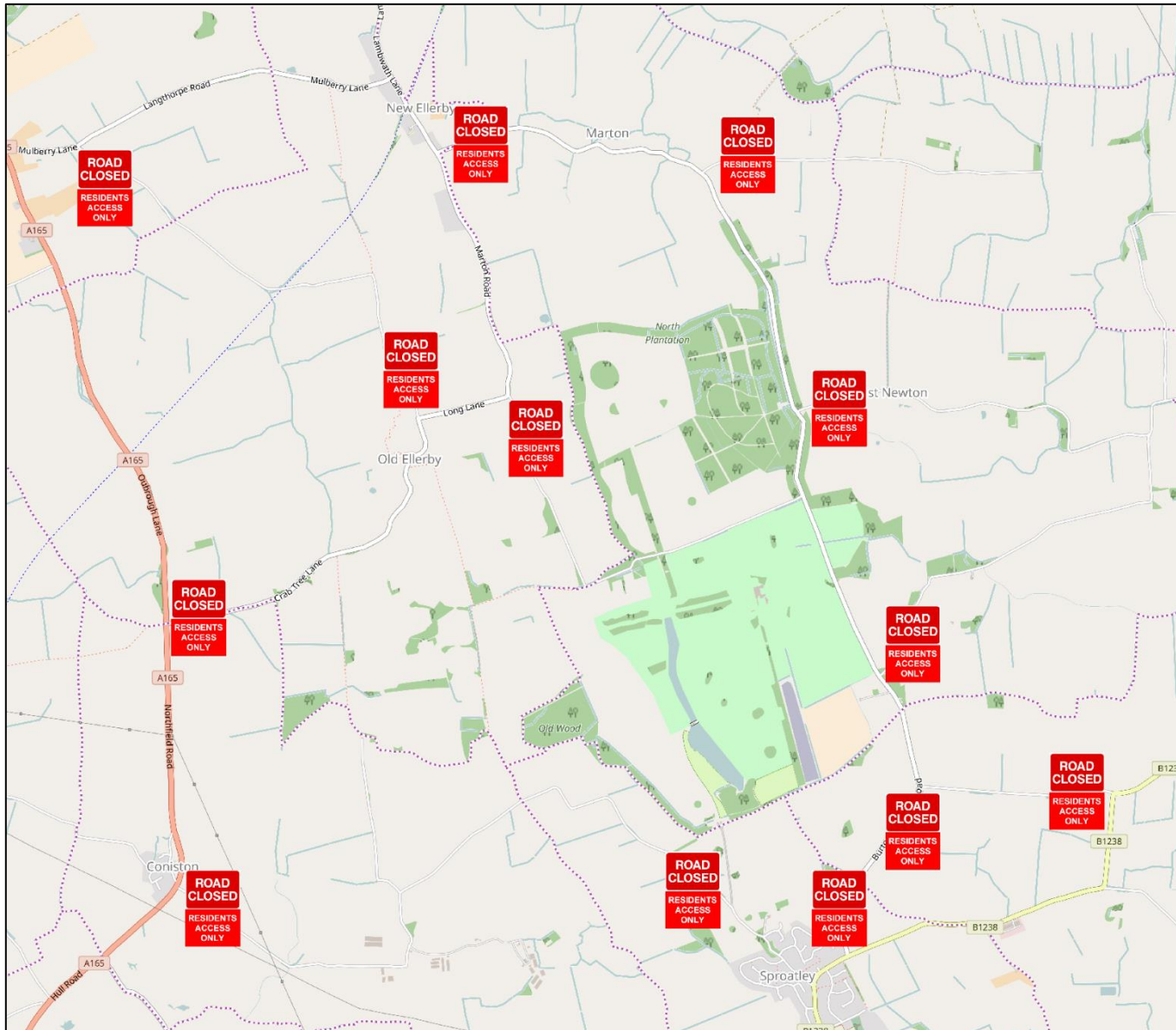

Road Closures to be manned during operational hours. The closures are to be put in place to deter festival goes from trying to park close to the event as there is no onsite parking, and to allow residents to still be able to go about their normal routine, causing as little disruption as possible.

Staff to have detailed briefing on what vehicles are allowed through road closures and in what direction the traffic is flowing (only applicable on the one way, see page 6 & 7). Additionally they will all be briefed to direct any festival goes to the closest park and ride site.

1.2 - Access Routes for Residents

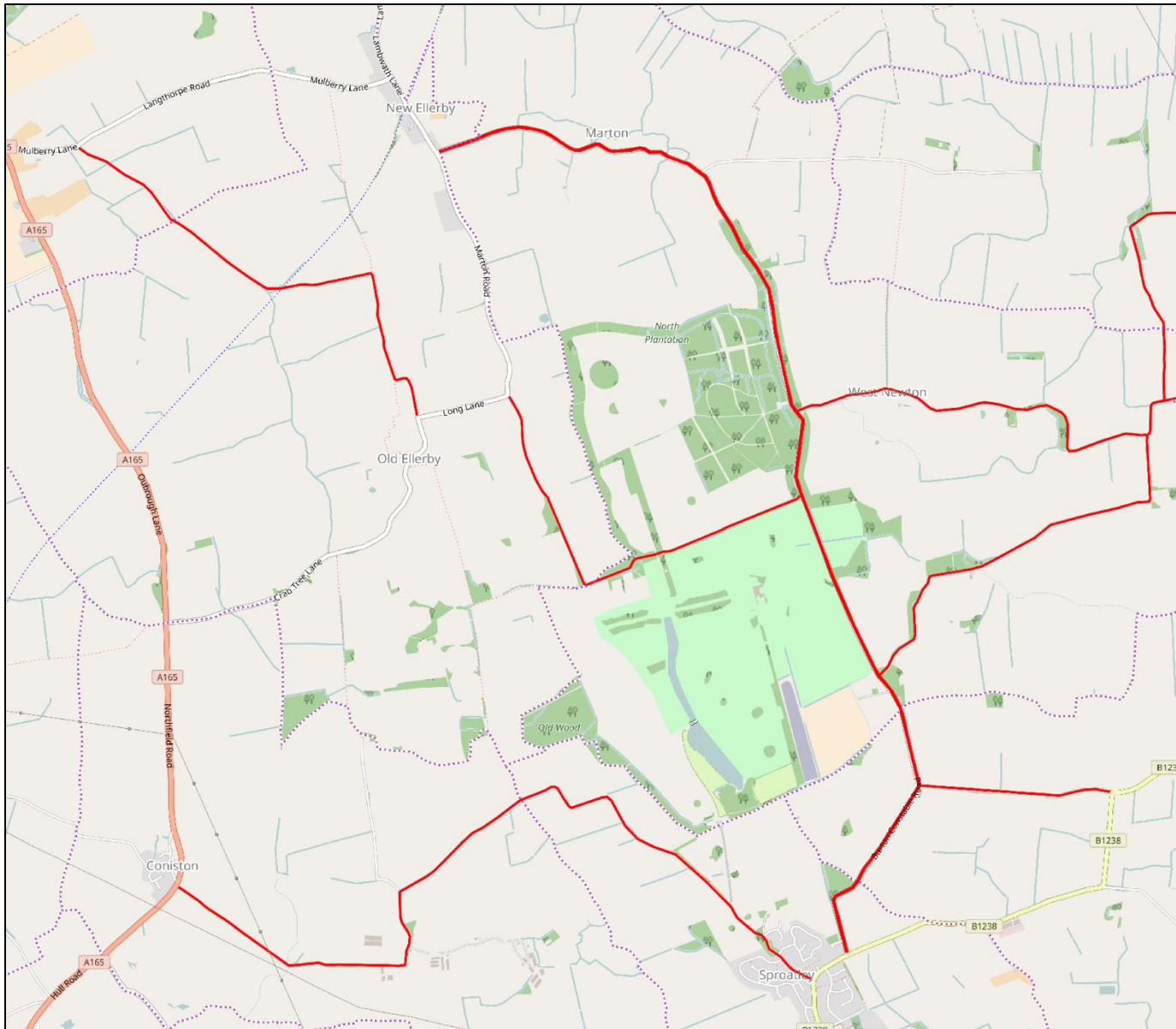

All resident access routes will be manned. Passes will be issued, but where no pass is shown a pragmatic approach will be taken as to whether or not to let a vehicle gain access, if the occupants of the vehicle are clearly not festival goers then they will be allowed.

1.3 - Route for vehicles without passes that arrive on site and re-routed to park and rides

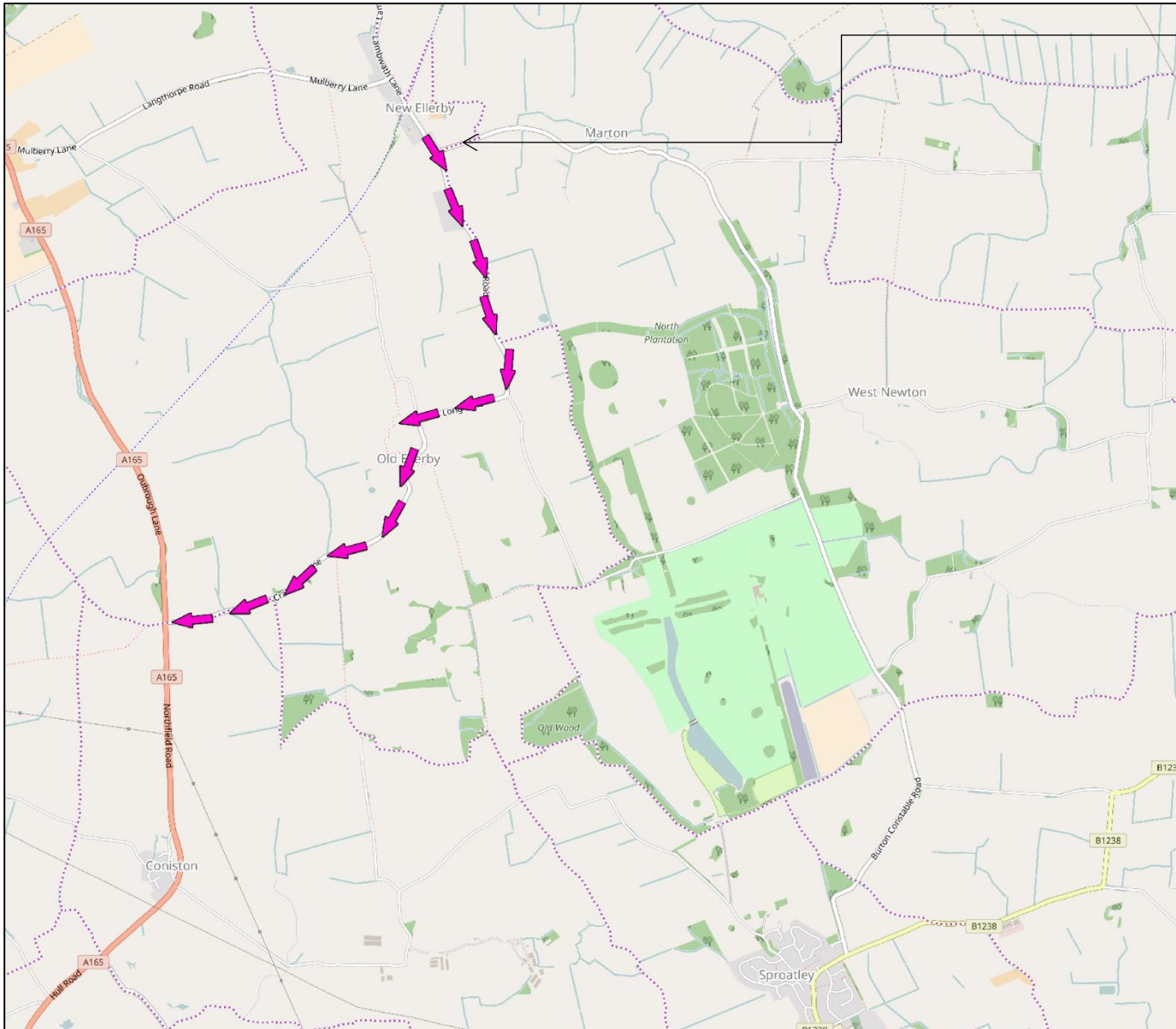

Vehicles that arrive who wish to park or drop off without the correct passes who arrive at the road closure here will be directed to follow the signed route to the closest park and ride.

1.4 - One way route North to South up until 14:00

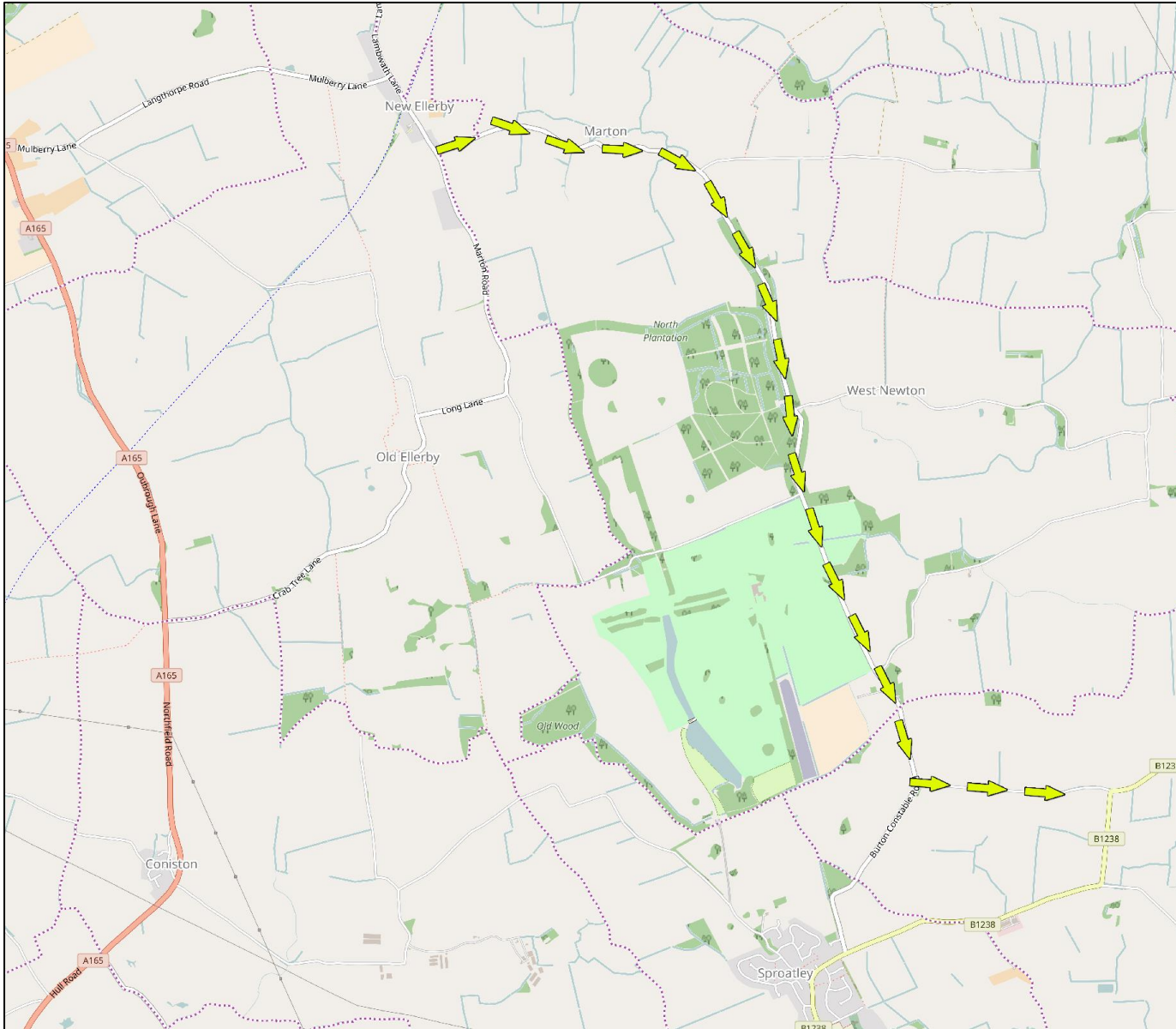

The one way system is to allow vehicles, especially busses to have easier access to the drop of area along what is a narrow road.

During the day between 14:00 and 14:30 the one way system will be reversed to allow for a faster recycling of the buses during egress.

1.5 - One way Route South to North from 14:30

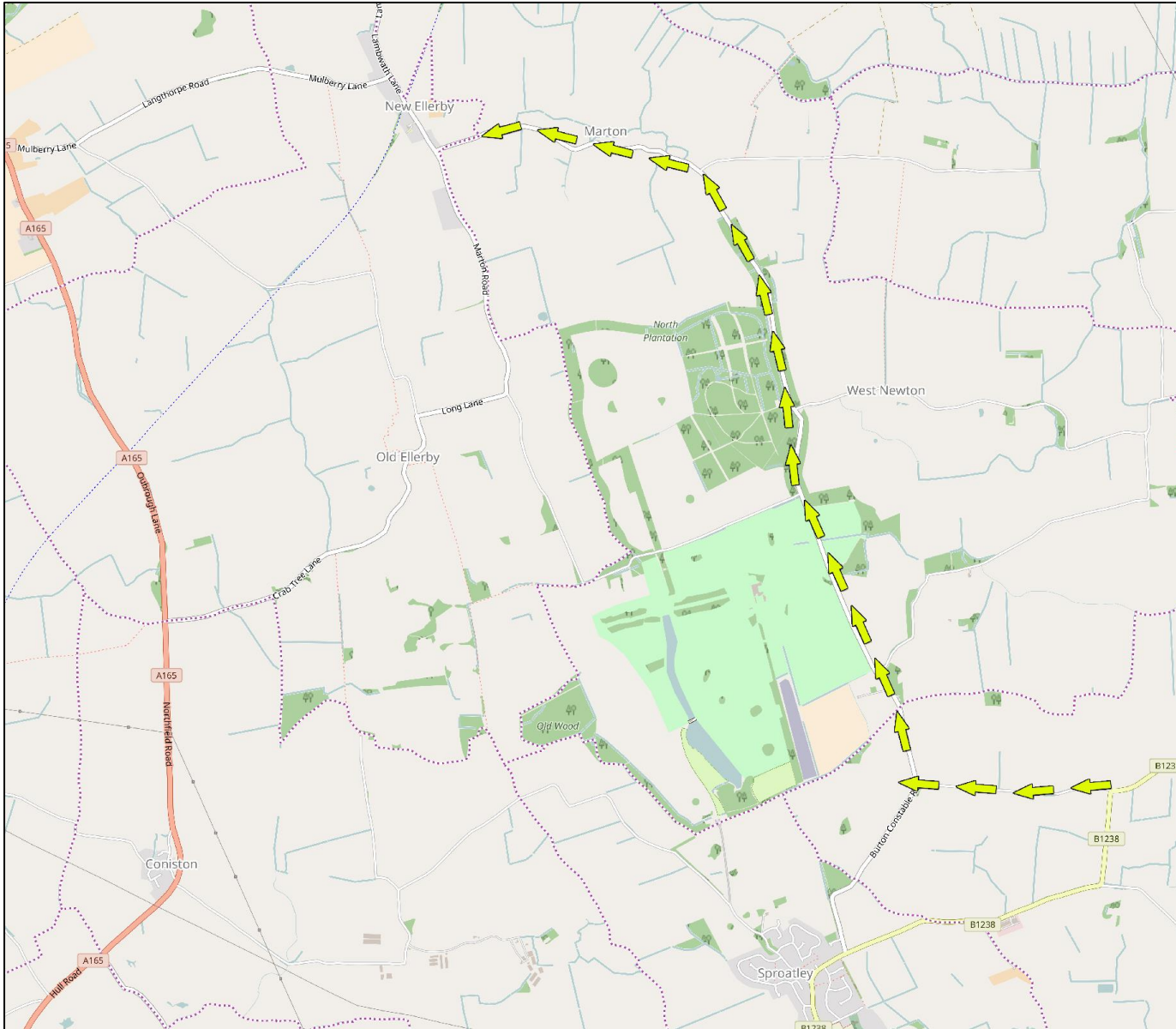

The one way system is to allow vehicles, especially busses to have easier access to the drop of area along what is a narrow road.

During the day between 14:00 and 14:30 the one way system will be reversed to allow for a faster recycling of the buses during egress.

SECTION 2 - Junctions Requiring active traffic control due to increased volumes of traffic

2.1 - Main St Junction with Grange Rd

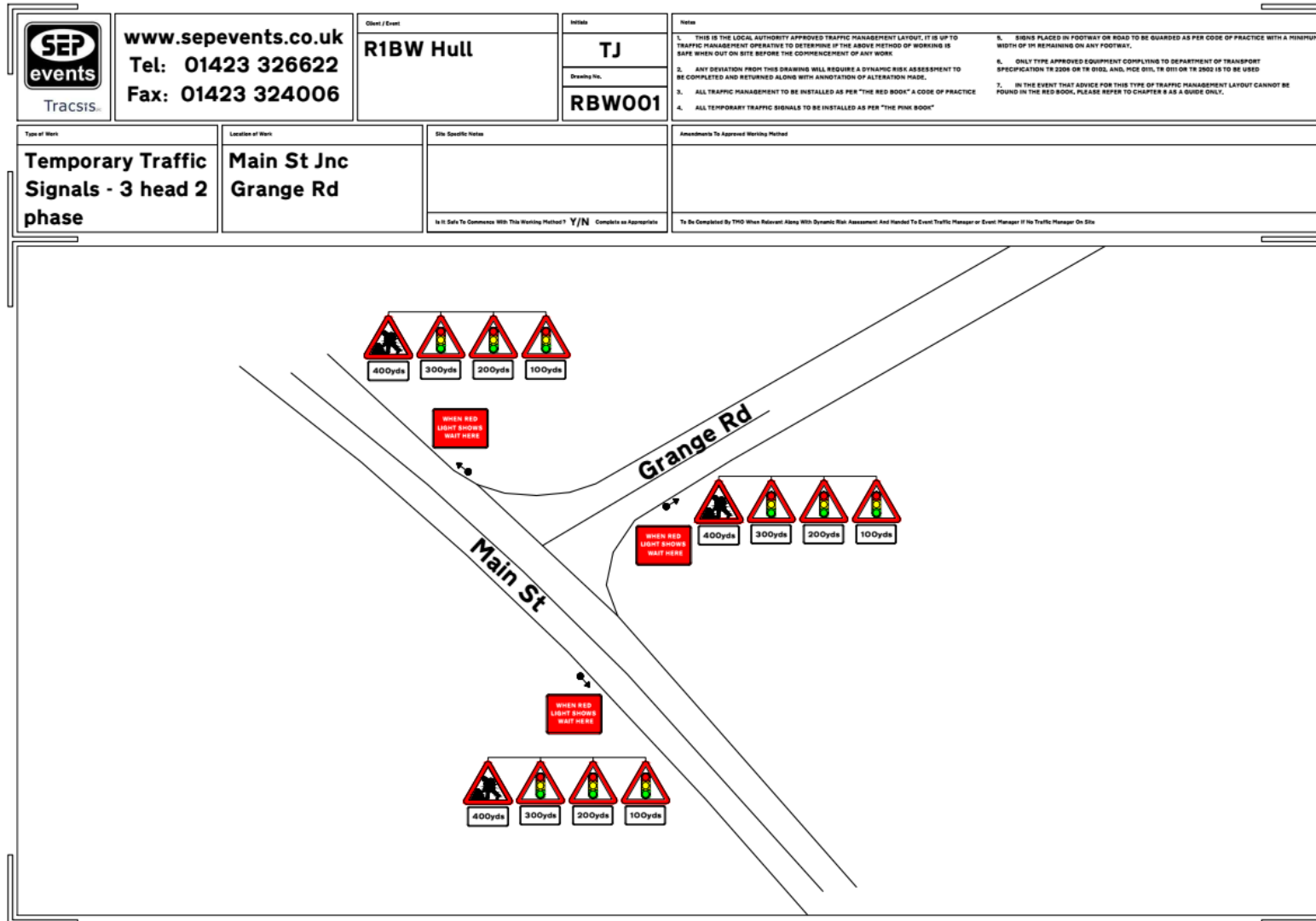

2.2 - A165 Junction with Mullberry Ln

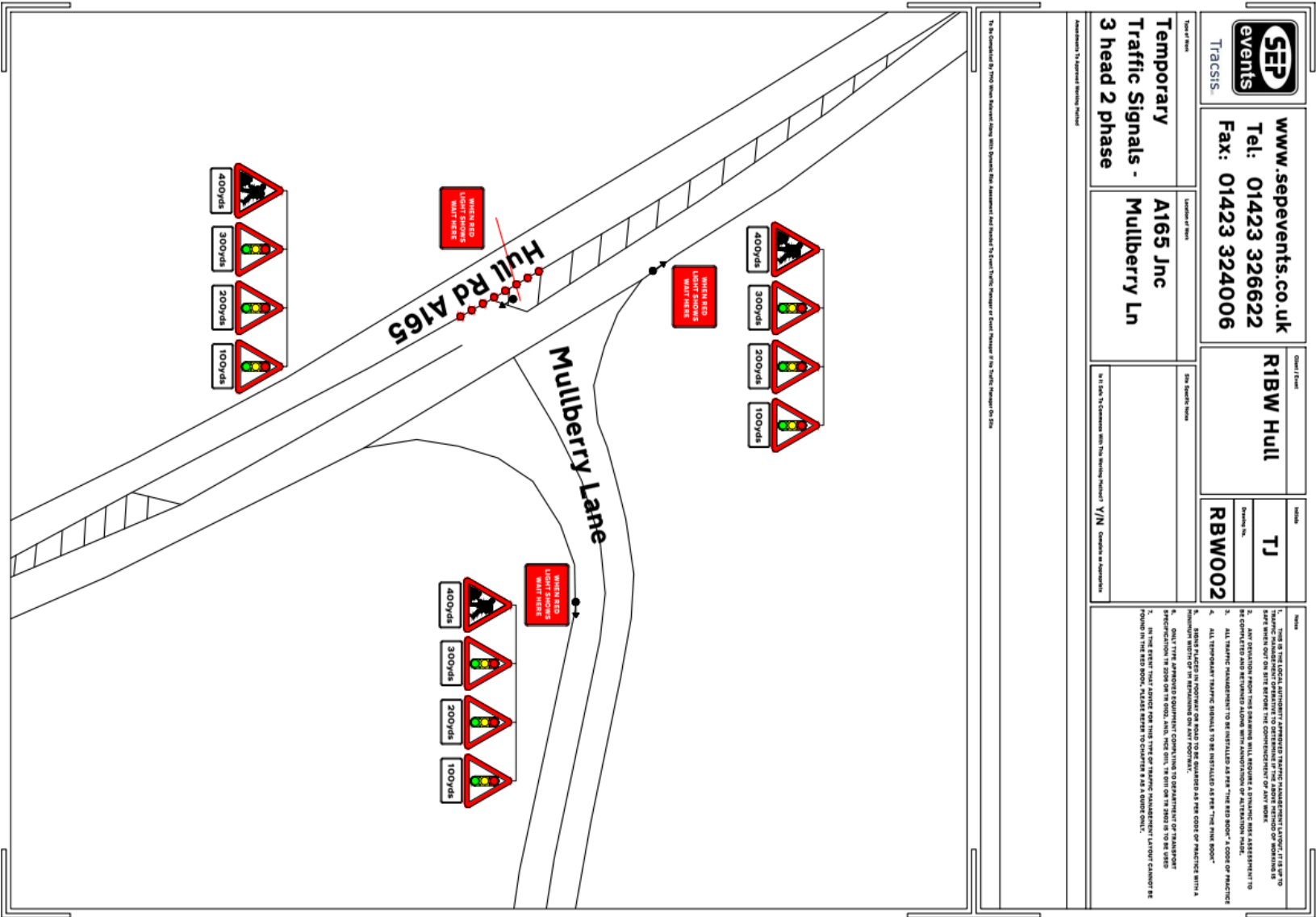

		www.sepevents.co.uk Tel: 01423 326622 Fax: 01423 324006		RIBW Hull		TJ		RBW002	
Temporary Traffic Signals - 3 head 2 phase		A165 Jnc Mullberry Ln		Site Specific Notes		In 1:500 N/Coverage with The Main Plan of V/N. Coverage as Appropriate		Notes 1. THIS IS THE LOCAL AUTHORITY'S APPROVED TRAFFIC MANAGEMENT PLAN. IT IS NOT TO BE DEVIATED FROM WITHOUT THE PERMISSION OF THE LOCAL AUTHORITY. 2. ANY DEVIATION FROM THIS SIGNALING WILL REQUIRE A DYNAMIC RISK ASSESSMENT TO BE COMPLETED AND RETURNED ALONG WITH APPLICATION OF ALTERATION MADE. 3. ALL TRAFFIC MANAGEMENT TO BE INSTALLED AS PER "THE RED BOOK" A CODE OF PRACTICE 4. ALL TEMPORARY TRAFFIC SIGNALS TO BE INSTALLED AS PER "THE RED BOOK" 5. SIGNING PLACED IN FRONT OF OR BEHIND AS PER CODE OF PRACTICE WITH A MINIMUM SPACING OF 10 METRES ON ANY FOOTWAY. 6. ONLY TYPE APPROVED EQUIPMENT CONFORMING TO DEPARTMENT OF TRANSPORT SPECIFICATION IS TO BE USED. ALSO, VMC GILL TR 8011 OR TR 2002 IS TO BE USED 7. IN THE EVENT THAT ANY OF THIS TYPE OF TRAFFIC MANAGEMENT LAYOUT CANNOT BE FOUND IN THE RED BOOK, PLEASE REFER TO CHAPTER 8 AND 9 ONLY.	

To Be Completed By Third Party Following Design With Dynamic Risk Assessment And Included In Final Traffic Management or Road Closure Plan. To Be Returned To Site

2.4 - Ouhbrough Ln A165 Junction with Crab Tree Ln

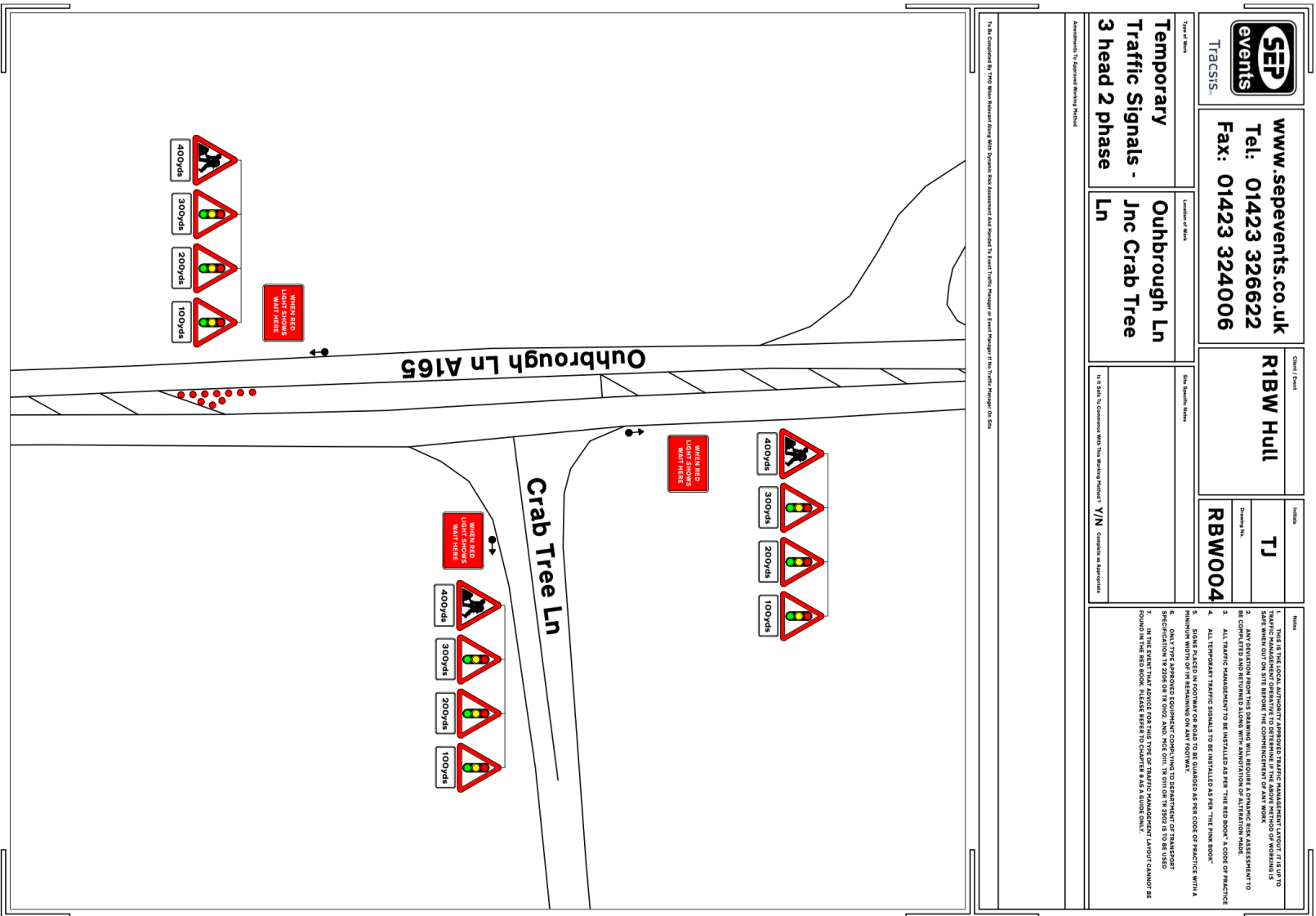

2.5 - Main Street Junction with Preston Rd

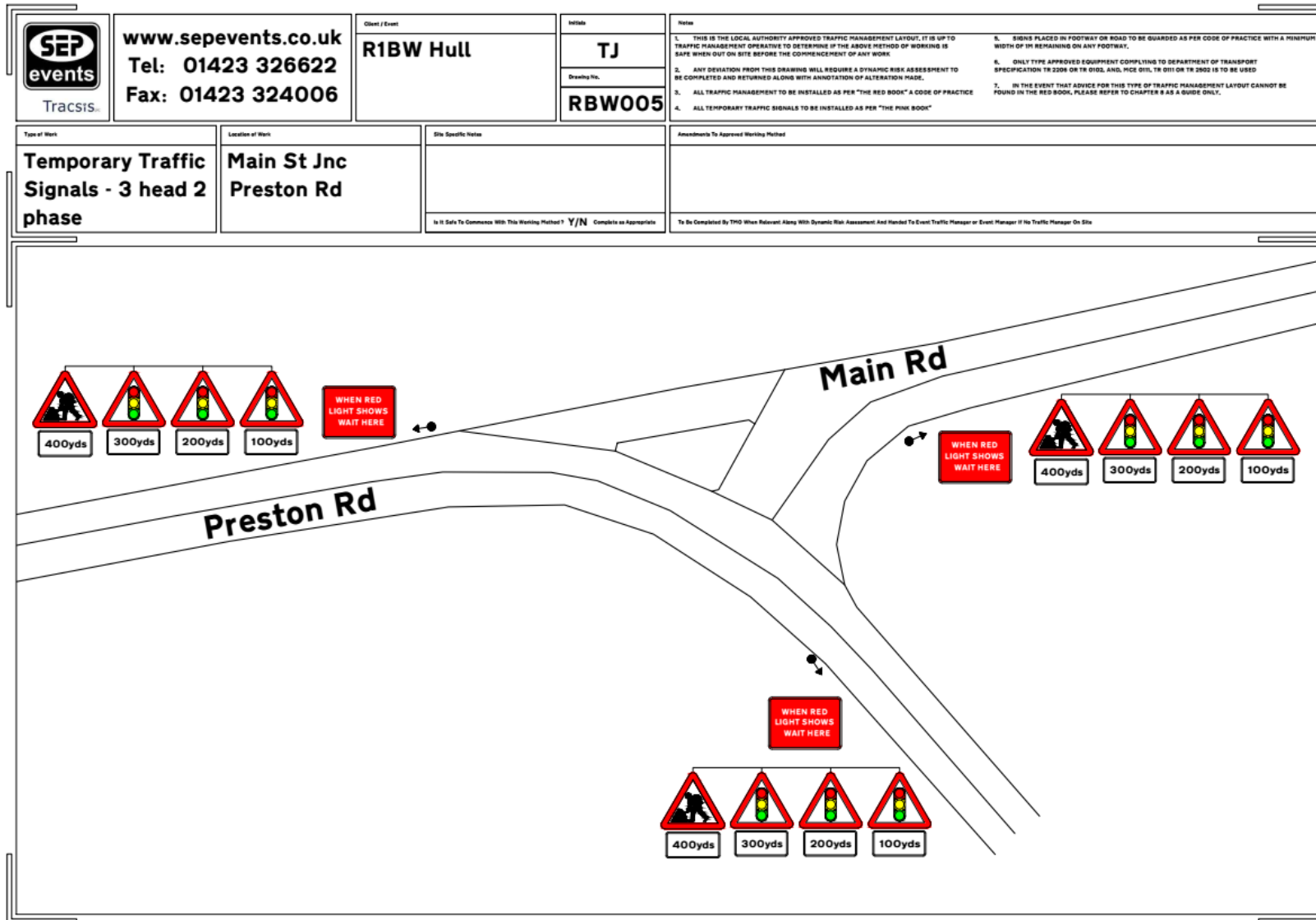

2.6 - Park Rd – Narrow road section prior to the caravan park

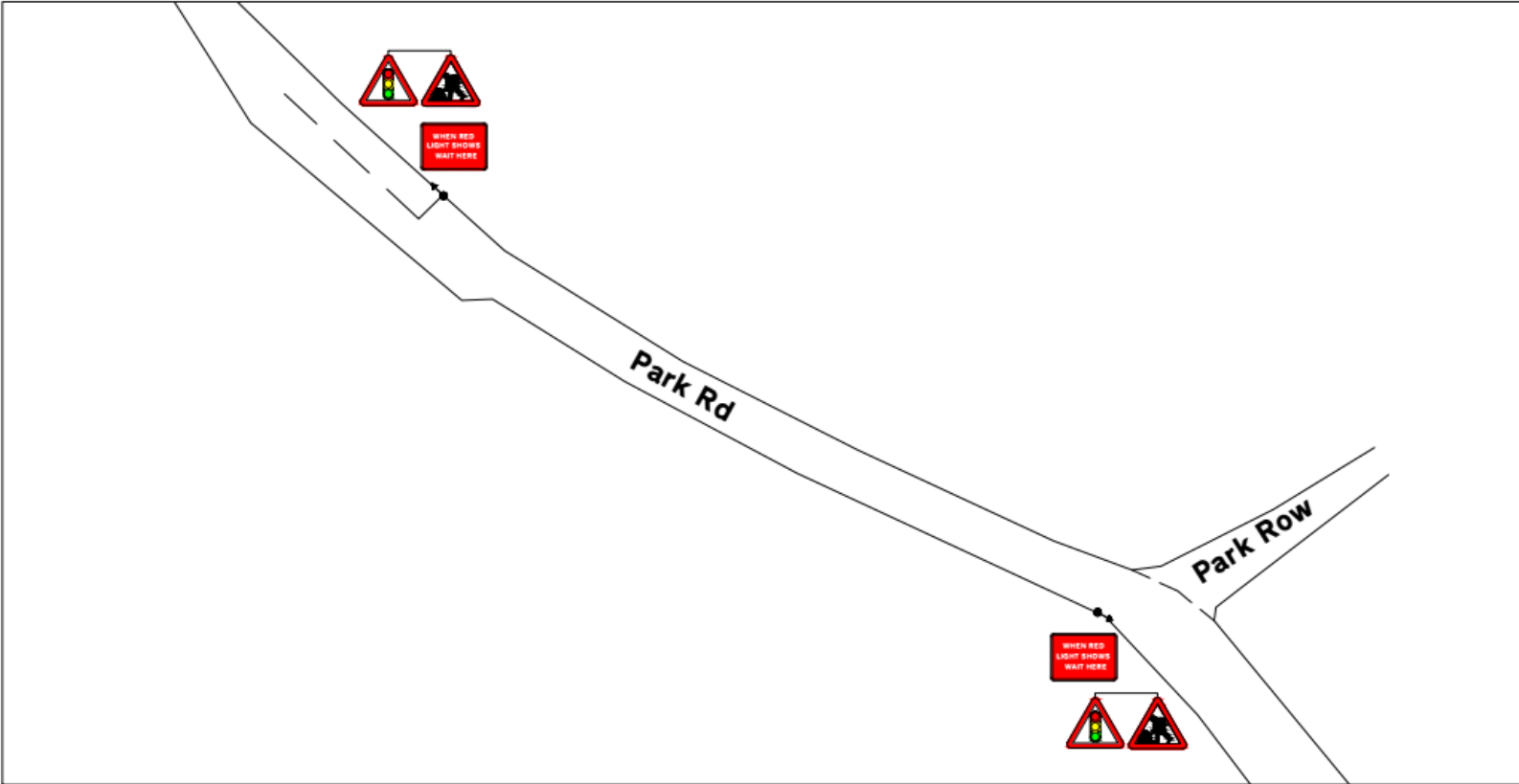
		www.sepevents.co.uk Tel: 01423 326622 Fax: 01423 324006		Client / Event R1BW Hull	Mobile TJ	Name 1. THIS IS THE LOCAL AUTHORITY APPROVED TRAFFIC MANAGEMENT LAYOUT. IT IS UP TO TRAFFIC MANAGEMENT OPERATIVE TO DETERMINE IF THE ABOVE METHOD OF WORKING IS SAFE WHEN OUT ON SITE BEFORE THE COMMENCEMENT OF ANY WORK. 2. ANY DEVIATION FROM THIS DRAWING WILL REQUIRE A DYNAMIC RISK ASSESSMENT TO BE COMPLETED AND RETURNED ALONG WITH ANNOTATION OF ALTERATION MADE. 3. ALL TRAFFIC MANAGEMENT TO BE INSTALLED AS PER "THE RED BOOK" A CODE OF PRACTICE 4. ALL TEMPORARY TRAFFIC SIGNALS TO BE INSTALLED AS PER "THE PINK BOOK" 5. SIGNS PLACED IN FOOTWAY OR ROAD TO BE GUARDED AS PER CODE OF PRACTICE WITH A MINIMUM WIDTH OF 1M REMAINING ON ANY FOOTWAY. 6. ONLY TYPE APPROVED EQUIPMENT COMPLYING TO DEPARTMENT OF TRANSPORT SPECIFICATION TR 2006 OR TR 2402, AND, HCE 091, TR 091 OR TR 2002 IS TO BE USED 7. IN THE EVENT THAT ADVICE FOR THIS TYPE OF TRAFFIC MANAGEMENT LAYOUT CANNOT BE FOUND IN THE RED BOOK, PLEASE REFER TO CHAPTER 8 AS A GUIDE ONLY.	
Drawing No. RBW006		Site Specific Notes Will need to be worked in conjunction with drawing RBW007 to allow vehicles to leave the holiday park <small>Is It Safe To Commence With This Warning Method? Y/N Complete as Appropriate</small>		Amendments To Approved Warning Method <small>To Be Completed By TMO When Relevant Along With Dynamic Risk Assessment And Handled To Event Traffic Manager or Event Manager If No Traffic Manager On Site</small>			
Type of Work Temporary Traffic Signals - 2 head 2 phase		Location of Work Park Rd - Narrow section of road					
 <p>The diagram illustrates a road layout with 'Park Rd' and 'Park Row'. Two sets of temporary traffic signals are shown. Each set consists of a triangular warning sign (road works) and a triangular sign with a red light symbol. Below each set is a rectangular sign that reads 'WHEN RED LIGHT SHOWS WAIT HERE'. The signals are positioned on Park Rd, one upstream and one downstream of the junction with Park Row.</p>							

2.7 - Caravan Park access road

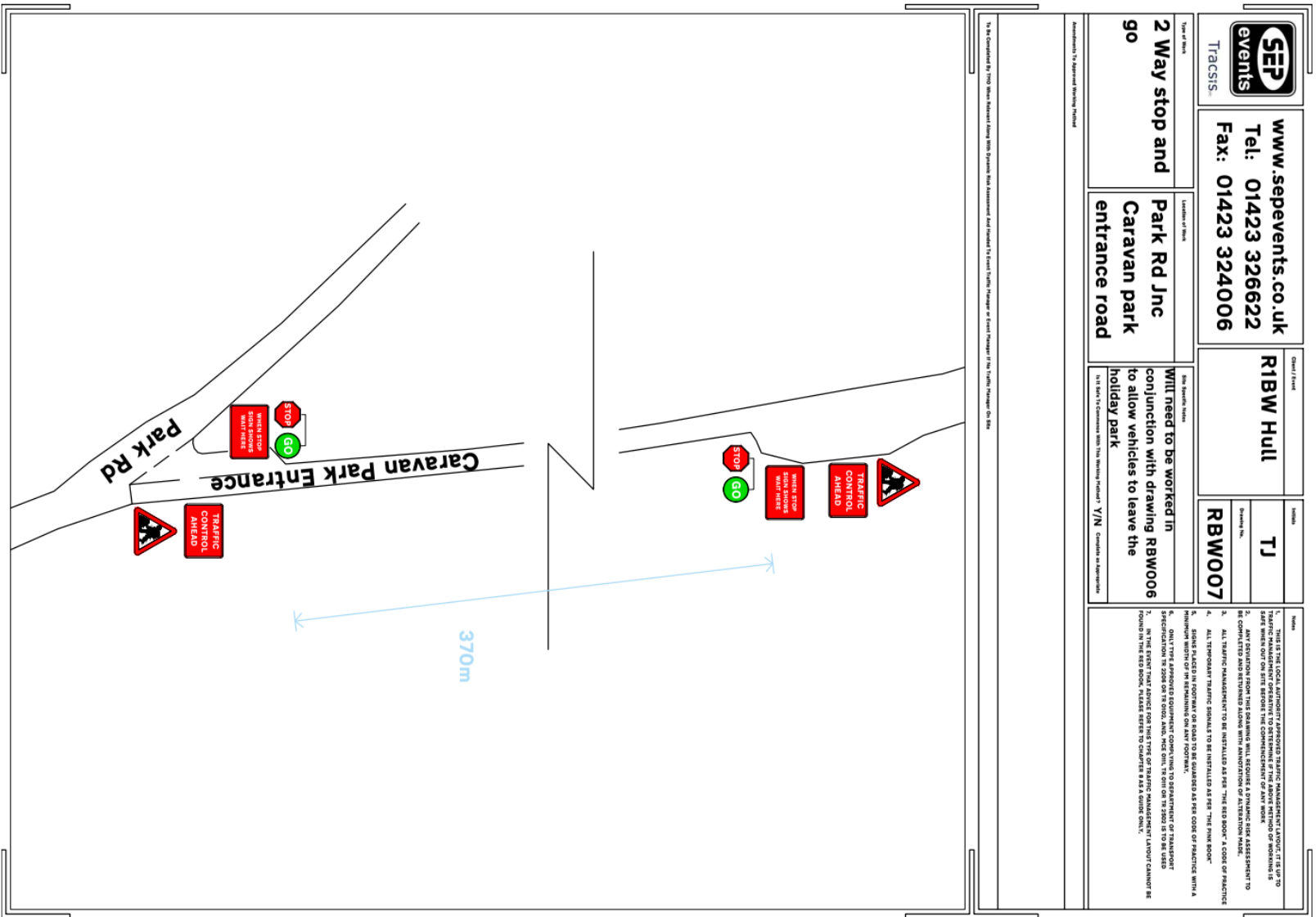

SEP events
Tracsis

www.sepevents.co.uk
Tel: 01423 326622
Fax: 01423 324006

Client / host
RIBW Hull

Event / title
2 Way stop and go

Location of event
Park Rd Jnc Caravan park entrance road

Site details
Will need to be worked in conjunction with drawing RBW006 to allow vehicles to leave the holiday park

Event / title
TJ

Event / title
RBW007

Event / title
2 Way stop and go

Location of event
Park Rd Jnc Caravan park entrance road

Notes

1. THIS IS THE LOCAL AUTHORITY APPROVED TRAFFIC MANAGEMENT LAYOUT. IT IS UP TO TRAFFIC MANAGEMENT OPERATORS TO DETERMINE IF THE ABOVE METHOD OF WORKING IS SUITABLE FOR THE EVENT. THE LOCAL AUTHORITY WILL BE RESPONSIBLE FOR THE TRAFFIC MANAGEMENT OPERATORS TO BE COMPLETED AND RETURNED ALONG WITH AMENDMENT OF ATTENTION AIDS.
2. ALL TRAFFIC MANAGEMENT TO BE INSTALLED AS PER "THE RED BOOK" A CODE OF PRACTICE
3. ALL TEMPORARY TRAFFIC SIGNALS TO BE INSTALLED AS PER "THE BLUE BOOK"
4. ALL TEMPORARY TRAFFIC SIGNALS TO BE INSTALLED AS PER "THE BLUE BOOK"
5. ONLY TYPE APPROVED EQUIPMENT ONLY TO BE USED FOR TRAFFIC MANAGEMENT OPERATORS SPECIFICATION IN 2008 OR IN 2009, AND, IN 2010, IN 2011 OR IN 2012 IS TO BE USED IN THE EVENT THAT ADVICE FOR THIS TYPE OF TRAFFIC MANAGEMENT LAYOUT CANNOT BE FOUND IN THE RED BOOK, PLEASE REFER TO CHAPTER 8 AS A GUIDE ONLY.

To Be Completed By: This sheet should be used with System Risk Assessment and amended to meet Traffic Management at Event Chapter 11. This Page No: 808